

B.M.: #203; Chiseled Square on the Southeast Corner of Str. 026-0038 Elevation 478.21

Existing Structure: SN 026-0038, Built-1938 Reconstruction-1965, 3-Span Wide Flange Beam Bridge, 97.5' Long, original width of 24' and widened to 46.5', Supported on Spread Foundation Abut. & Piers, to be removed.

Staging: Traffic shall be maintained during replacement by Staged Construction.

Salvage: None.

STATE OF ILLINOIS  
DEPARTMENT OF TRANSPORTATION

ROUTE NO.	SECTION	COUNTY	TOTAL SHEETS	SHEET NO.	SHEET NO. 1
FAP 322	24BR-1	FAYETTE	57	21	22 SHEETS
FED. ROAD DIST. NO. 7	ILLINOIS	FED. AID PROJECT			

Contract # 94170

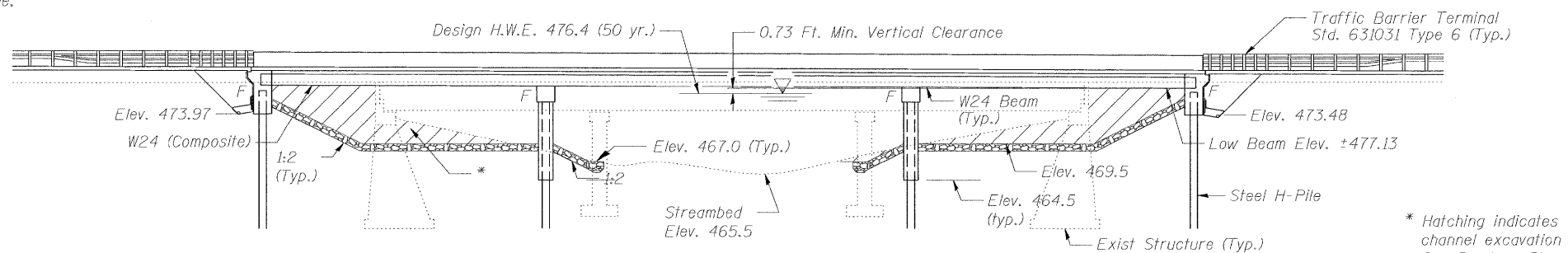

ELEVATION

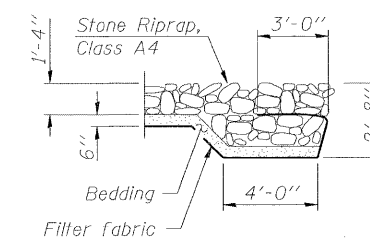

SECTION A-A

SHEET INDEX

Plan & Elevation	1
General Notes & Quantities	2
Staged Construction	3
Drainage Scupper	4
Temp. Concrete Barrier	5
Top of Slab Elevations	6-9
Superstructure	10
Superstructure Details	11-12
Cantilever Forming Brackets	13
Framing & Beam Details	14
Bearings	15
Abutments	16
Pier 1 & 2	17
Steel H-Pile Details	18
Bar Splicer Details	19
Soil Borings	20-22

\* Hatching indicates channel excavation See Roadway Plans

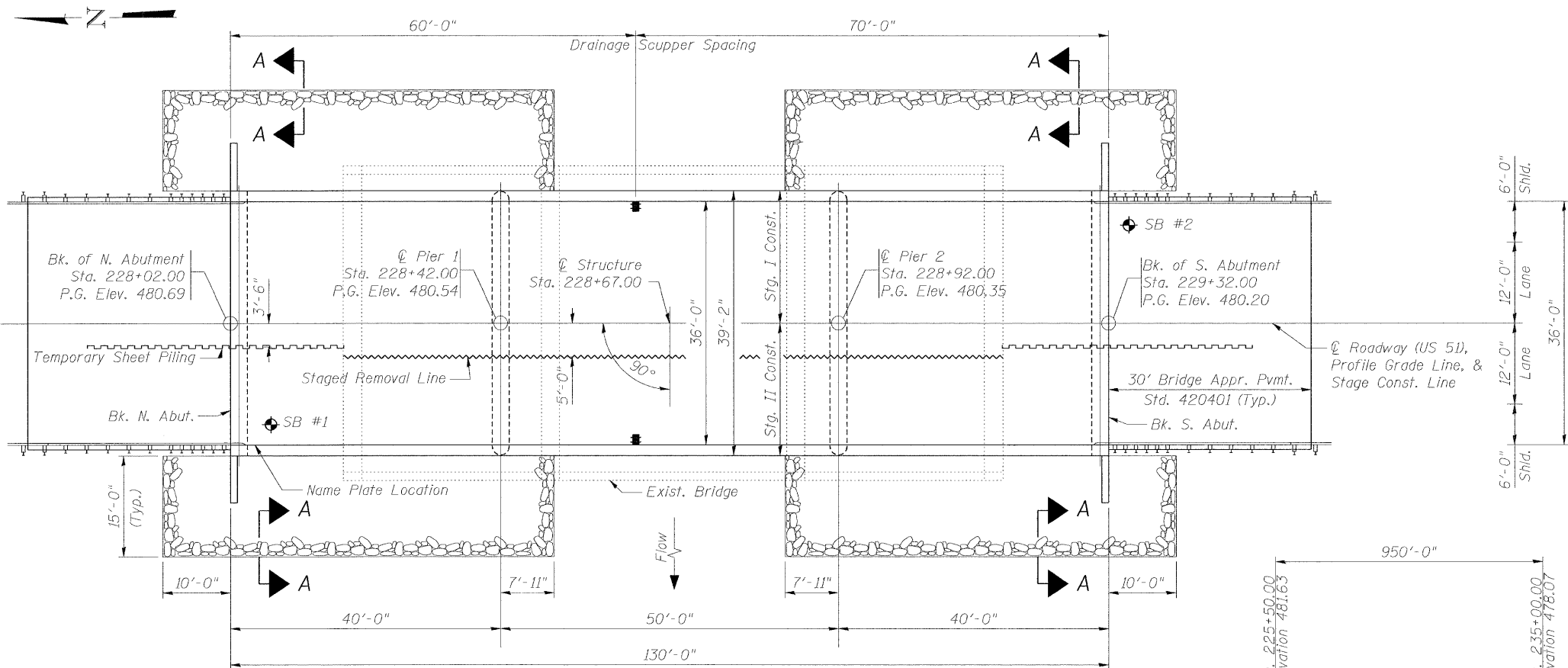

PLAN

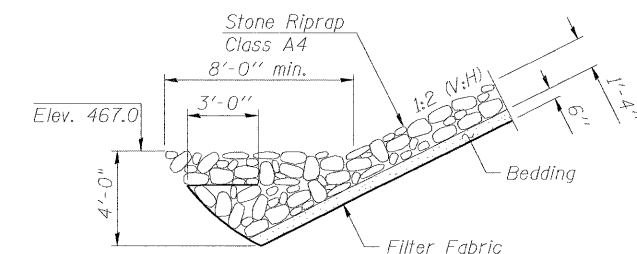

STONE RIPRAP ANCHOR DETAIL

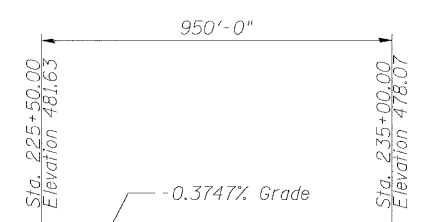

PROFILE GRADE

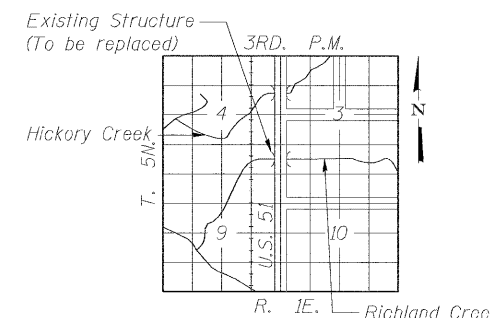

LOCATION SKETCH

DESIGN SCOUR ELEVATION TABLE

Design Scour Elevation (ft.)	N. Abutment	Pier 1	Pier 2	S. Abutment
	474.1	463.3	463.3	473.6

WATERWAY INFORMATION

Drainage Area = 12.44 sq. mi. Proposed Low Grade Elev. = 478.07 @ Sta. 235+00.00

Flood	Freq. Yr.	Q C.F.S.	Opening Sq. Ft.	Nat. Head - Ft.	Headwater El.
Design	50	2986	525	881	476.4
Base	100	3424	525	917	476.7
Overtopping (Proposed)	300	4229	968	477.3	477.3
Max. Calc.	500	4471	525	968	477.6

LOADING HS20-44

Allow 50#/sq. ft. for future wearing surface.

SEISMIC DATA

Seismic Performance Category (SPC) = A  
Bedrock Acceleration Coefficient (A) = .075  
Site Coefficient (S) = 1.0

DESIGN SPECIFICATIONS

2002 AASHTO Standard Specifications - 17th ed.

DESIGN STRESSES

FIELD UNITS  
f'c = 3,500 psi  
fy = 60,000 psi (reinf.)  
fy = 50,000 psi (M270 Grade 50)

APPROVED FOR STRUCTURAL ADEQUACY ONLY

REGINALD H. BENTON  
ENGINEER OF BRIDGES AND STRUCTURES



9/23/08  
REGINALD H. BENTON

PLAN AND ELEVATION  
US 51 / RICHLAND CREEK

F.A.P. RT. 322  
SEC. 24BR-1  
FAYETTE COUNTY  
STA. 228+67.40  
SN. 026-0104

BENTON & ASSOCIATES, INC.

DESIGNED	MBH
CHECKED	NRF
DRAWN	MBH
CHECKED	NRF



BENTON & ASSOCIATES, INC.  
Consulting Engineers / Land Surveyors  
1970 West Lafayette Ave. Jacksonville, IL 62650  
Phone: 217-245-4146 Fax: 217-245-4149  
IL Design Firm Registration No. 184-000852