

STATE OF ILLINOIS
DEPARTMENT OF TRANSPORTATION

ROUTE NO.	SECTION	COUNTY	TOTAL SHEETS	SHEET NO.
FAP 322	24BR-1	FAYETTE	57	28
FED. ROAD DIST. NO. 7	ILLINOIS	FED. AID PROJECT		

SHEET NO. 8
22 SHEETS

Contract # 94770

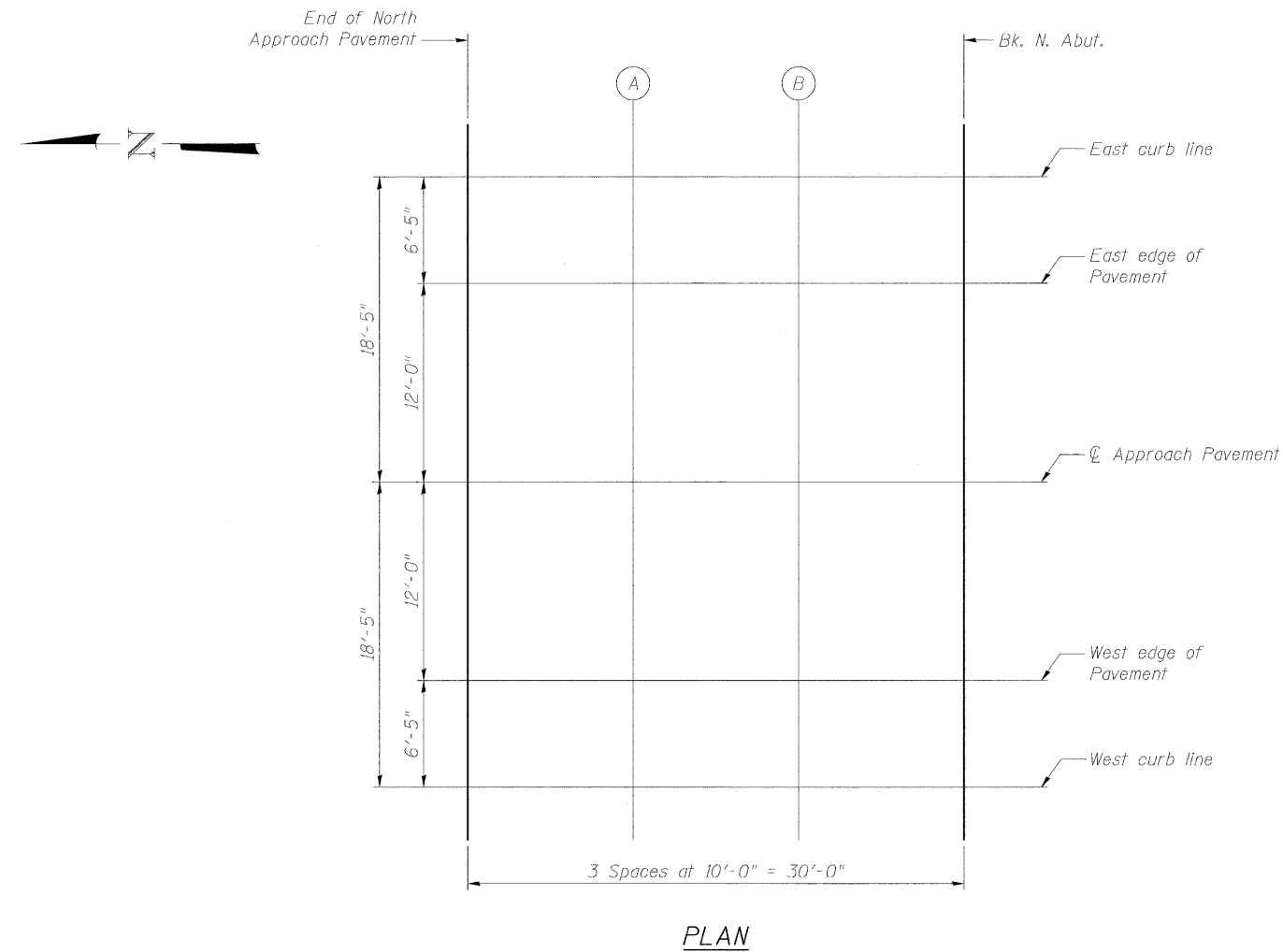

PLAN

WEST CURB LINE & EAST CURB LINE

Location	Station	Offset	Theoretical Grade Elevations
End. N. Appr. Pav't.	227+72.00	18.42'	480.48
A	227+82.00	18.42'	480.44
B	227+92.00	18.42'	480.40
Bk. N. Abut.	228+02.00	18.42'	480.37

WEST EDGE OF PAVEMENT & EAST EDGE OF PAVEMENT

Location	Station	Offset	Theoretical Grade Elevations
End. N. Appr. Pav't.	227+72.00	12.00'	480.61
A	227+82.00	12.00'	480.57
B	227+92.00	12.00'	480.54
Bk. N. Abut.	228+02.00	12.00'	480.50

Approach Pavement

Location	Station	Offset	Theoretical Grade Elevations
End. N. Appr. Pav't.	227+72.00	0.00'	480.80
A	227+82.00	0.00'	480.76
B	227+92.00	0.00'	480.72
Bk. N. Abut.	228+02.00	0.00'	480.69

BENTON & ASSOCIATES, INC.

DESIGNED	MBH
CHECKED	NRF
DRAWN	MBH
CHECKED	NRF

E-AS

9-3-07

TOP OF SLAB ELEVATIONS
NORTH APPROACH
US 51 / RICHLAND CREEK
F.A.P. RT. 322
FAYETTE COUNTY
SN. 026-0104