

STATE OF ILLINOIS  
DEPARTMENT OF TRANSPORTATION

ROUTE NO.	SECTION	COUNTY	TOTAL SHEETS	SHEET NO.	SHEET NO. 9 22 SHEETS
FAP 322	24BR-1	FAYETTE	57	29	
FED. ROAD DIST. NO. 7	ILLINOIS	FED. AID PROJECT-			

Contract # 94770

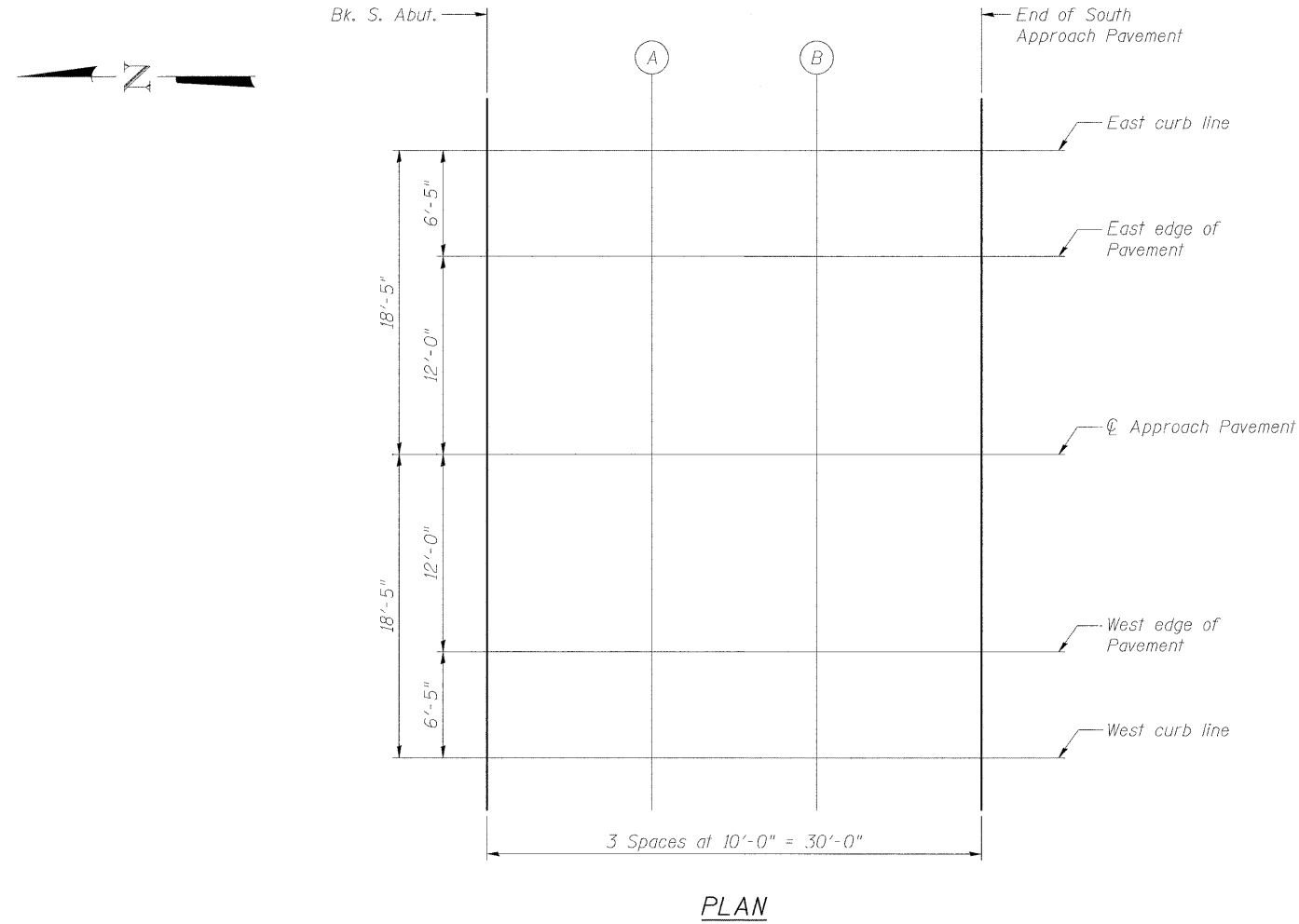

PLAN

WEST CURB LINE & EAST CURB LINE

Location	Station	Offset	Theoretical Grade Elevations
Bk. S. Abut.	229+32.00	18.42'	479.88
A	229+42.00	18.42'	479.84
B	229+52.00	18.42'	479.80
End S. Appr. Pav't.	229+62.00	18.42'	479.77

WEST EDGE OF PAVEMENT & EAST EDGE OF PAVEMENT

Location	Station	Offset	Theoretical Grade Elevations
Bk. S. Abut.	229+32.00	12.00'	480.01
A	229+42.00	12.00'	479.97
B	229+52.00	12.00'	479.94
End S. Appr. Pav't.	229+62.00	12.00'	479.90

Centerline of Approach Pavement

Location	Station	Offset	Theoretical Grade Elevations
Bk. S. Abut.	229+32.00	0.00'	480.20
A	229+42.00	0.00'	480.16
B	229+52.00	0.00'	480.12
End S. Appr. Pav't.	229+62.00	0.00'	480.09

BENTON & ASSOCIATES, INC.

DESIGNED	MBH
CHECKED	NRF
DRAWN	MBH
CHECKED	NRF

E-AS

9-3-07

TOP OF SLAB ELEVATIONS  
SOUTH APPROACH  
US 51 / RICHLAND CREEK  
F.A.P. RT. 322  
FAYETTE COUNTY  
SN. 026-0104