

CURVE C1

C1	PI STA. = 437+67.06
	$\Delta = 01^\circ 07' 04''$ (LT)
	D = 0° 28' 39"
	R = 12,000.00'
	T = 117.06'
	L = 234.11'
	E = 0.57'
C2	P.C. STA = 436+50.00
C3	P.T. STA = 438+84.11

CURVE C4

C4	PI STA. = 441+16.06
	$\Delta = 1^\circ 04' 09''$ (RT)
	D = 0° 28' 39"
	R = 12,000.00'
	T = 111.95'
	L = 223.90'
	E = 0.52'
C5	P.C. STA = 440+04.11
C6	P.T. STA = 442+28.01

CURVE C7

C7	PI STA. = 447+71.54
	$\Delta = 2^\circ 06' 42''$ (RT)
	D = 1° 01' 37"
	R = 5,580.00'
	T = 102.84'
	L = 205.65'
	E = 0.95'
C8	P.C. STA = 446+68.70
C9	P.T. STA = 448+74.35

CURVE C10

C10	PI STA. = 450+97.19
	$\Delta = 2^\circ 06' 42''$ (LT)
	D = 1° 01' 37"
	R = 5,580.00'
	T = 102.84'
	L = 205.65'
	E = 0.95'
C11	P.C. STA = 449+94.35
C12	P.T. STA = 452+00.00

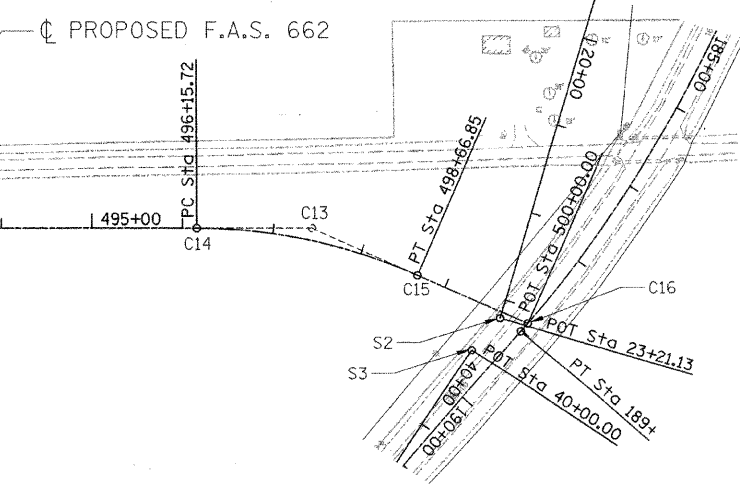
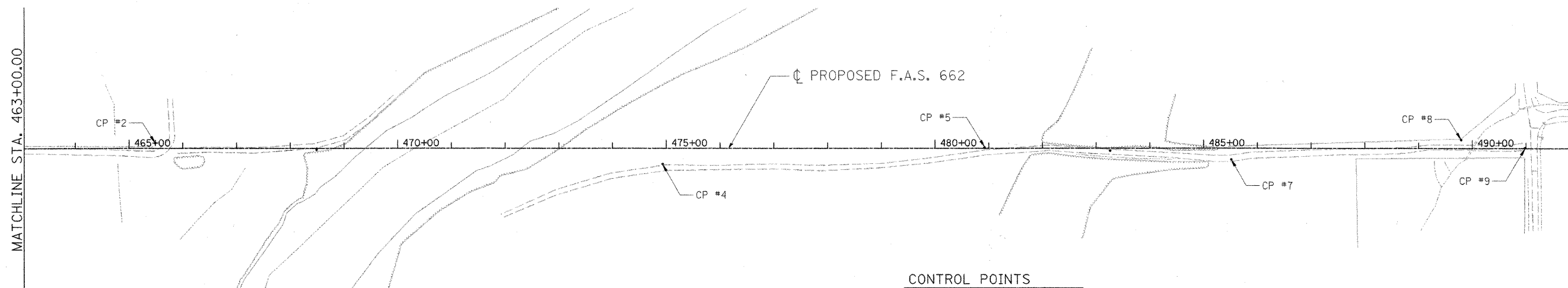

CURVE C13

C13	PI STA. = 497+43.15
	$\Delta = 23^\circ 58' 50''$ (RT)
	D = 9° 32' 57"
	R = 600.00'
	T = 127.43'
	L = 251.12'
	E = 13.38'
	e = 2.00%
	S.E. ATTN: 495+32.72 (-2.00%) TO 496+57.72 (2.00%)
	498+24.85 (2.00%) TO 499+49.85 (-2.00%)
C14	P.C. STA = 496+15.72
C15	P.T. STA = 498+66.85

CONTROL POINTS

POINT	DESCRIPTION	STATION, OFFSET	ELEVATION	NORTHING	EASTING
CP #1	IRON PIN @ END OF LEVEE	STA. 460+26.17, 27.64' RT.	ELEV: 546.57	24,946.24	34,633.58
CP #2	IRON PIN	STA. 465+48.71, 9.72' LT.	ELEV: 544.68	24,987.32	35,155.85
CP #3	IRON PIN		ELEV: 567.47	24,961.03	32,834.71
CP #4	IRON PIN	STA. 474+93.38, 29.24' RT.	ELEV: 544.23	24,955.12	36,100.77
CP #5	IRON PIN	STA. 480+92.08, 1.36' LT.	ELEV: 545.90	24,990.00	36,699.24
CP #6	IRON PIN		ELEV: 571.96	24,957.90	31,297.53
CP #7	IRON PIN	STA. 485+51.24, 20.78' RT.	ELEV: 594.37	24,971.14	37,158.54
CP #8	IRON PIN	STA. 489+79.28, 15.76' LT.	ELEV: 587.97	25,010.75	37,586.31
CP #9	IRON PIN	STA. 490+98.16, 0.62' LT.	ELEV: 588.98	24,996.45	37,705.30

F.A.S. 662

POINT	NORTHING	EASTING
C1	24,963.21	32,374.52
C2	24,962.47	32,257.46
C3	24,966.23	32,491.54
C4	24,972.22	32,723.41
C5	24,969.33	32,611.50
C6	24,973.02	32,835.36
C7	24,976.90	33,378.87
C8	24,976.17	33,276.04
C9	24,973.85	33,481.66
C10	24,967.23	33,704.40
C11	24,970.28	33,601.61
C12	24,967.96	33,807.24
C13	25,000.44	38,350.27
C14	24,999.53	38,222.85
C15	24,949.49	38,467.07
C16	24,896.24	38,589.11

SIGHT GRADING LINE (NORTH)

POINT	NORTHING	EASTING
S1	26,169.19	38,931.76
S2	24,901.90	38,558.45

SIGHT GRADING LINE (SOUTH)

POINT	NORTHING	EASTING
S3	24,865.46	38,527.44
S4	23,767.98	37,806.64

© Copyright Hanson Professional Services Inc. 2008
HANSON
 Hanson Professional Services Inc.

LAYOUT	MNM/DJP	10/10/07
DRAWN	DJP	10/10/07
REVIEWED	JMM	02/04/08

FILE NAME = I:\01_jobs\01s2021B\CADD\Road\Sheet\VC-103\geom.dgn	USER NAME = Pop0275	DESIGNED - MNM/DJP	REVISIONS -
PLDT SCALE = 100.0000' / IN.	CHECKED - MNM	DRAWN - DJP	REVISIONS -
PLDT DATE = 04/04/2008, 12:12 PM	DATE - 10/10/07	CHECKED - MNM	REVISIONS -

STATE OF ILLINOIS
DEPARTMENT OF TRANSPORTATION

GEOMETRIC CONTROL SHEET

SCALE: SHEET NO. 1 OF 2 SHEETS STA. 436+50.00 TO STA. 500+00.00

F.A.S. RTE.	SECTION	COUNTY	TOTAL SHEETS	SHEET NO.
662	01-0061-00-BR	CUMBERLAND	85	8
CONTRACT NO. 95552				
FED. ROAD DIST. NO. ILLINOIS FED. AID PROJECT				