

ROUTE NO.	SECTION	COUNTY	TOTAL SHEETS	SHEET NO.
FAS 662 (TR 61)	*	CUMBERLAND	85	36
FED. ROAD DIST. NO. 7	ILLINOIS	FED. AID PROJECT-		

SHEET NO. 6
26 SHEETS

*Section 01-00061-00-BR Contract #95552

NORTH SHOULDER LINE

Location	Station	Offset	Theoretical Grade Elevations
West End W. Appr. Pav't.	468+36.00	-15.00'	554.70
A	468+46.00	-15.00'	554.70
B	468+56.00	-15.00'	554.70
Bk. W. Abut.	468+65.29	-15.00'	554.70
East End W. Appr. Pav't.	468+66.00	-15.00'	554.70

NORTH EDGE OF PAVEMENT

Location	Station	Offset	Theoretical Grade Elevations
West End W. Appr. Pav't.	468+33.00	-12.00'	554.76
A	468+43.00	-12.00'	554.76
B	468+53.00	-12.00'	554.76
Bk. W. Abut.	468+62.29	-12.00'	554.76
East End W. Appr. Pav't.	468+63.00	-12.00'	554.76

ROADWAY & PROFILE GRADE LINE

Location	Station	Offset	Theoretical Grade Elevations
West End W. Appr. Pav't.	468+21.00	0.00'	555.00
A	468+31.00	0.00'	555.00
B	468+41.00	0.00'	555.00
Bk. W. Abut.	468+50.29	0.00'	555.00
East End W. Appr. Pav't.	468+51.00	0.00'	555.00

SOUTH EDGE OF PAVEMENT

Location	Station	Offset	Theoretical Grade Elevations
West End W. Appr. Pav't.	468+09.00	12.00'	554.76
A	468+19.00	12.00'	554.76
B	468+29.00	12.00'	554.76
Bk. W. Abut.	468+38.29	12.00'	554.76
East End W. Appr. Pav't.	468+39.00	12.00'	554.76

SOUTH SHOULDER LINE

Location	Station	Offset	Theoretical Grade Elevations
West End W. Appr. Pav't.	468+06.00	15.00'	554.70
A	468+16.00	15.00'	554.70
B	468+26.00	15.00'	554.70
Bk. W. Abut.	468+35.29	15.00'	554.70
East End W. Appr. Pav't.	468+36.00	15.00'	554.70

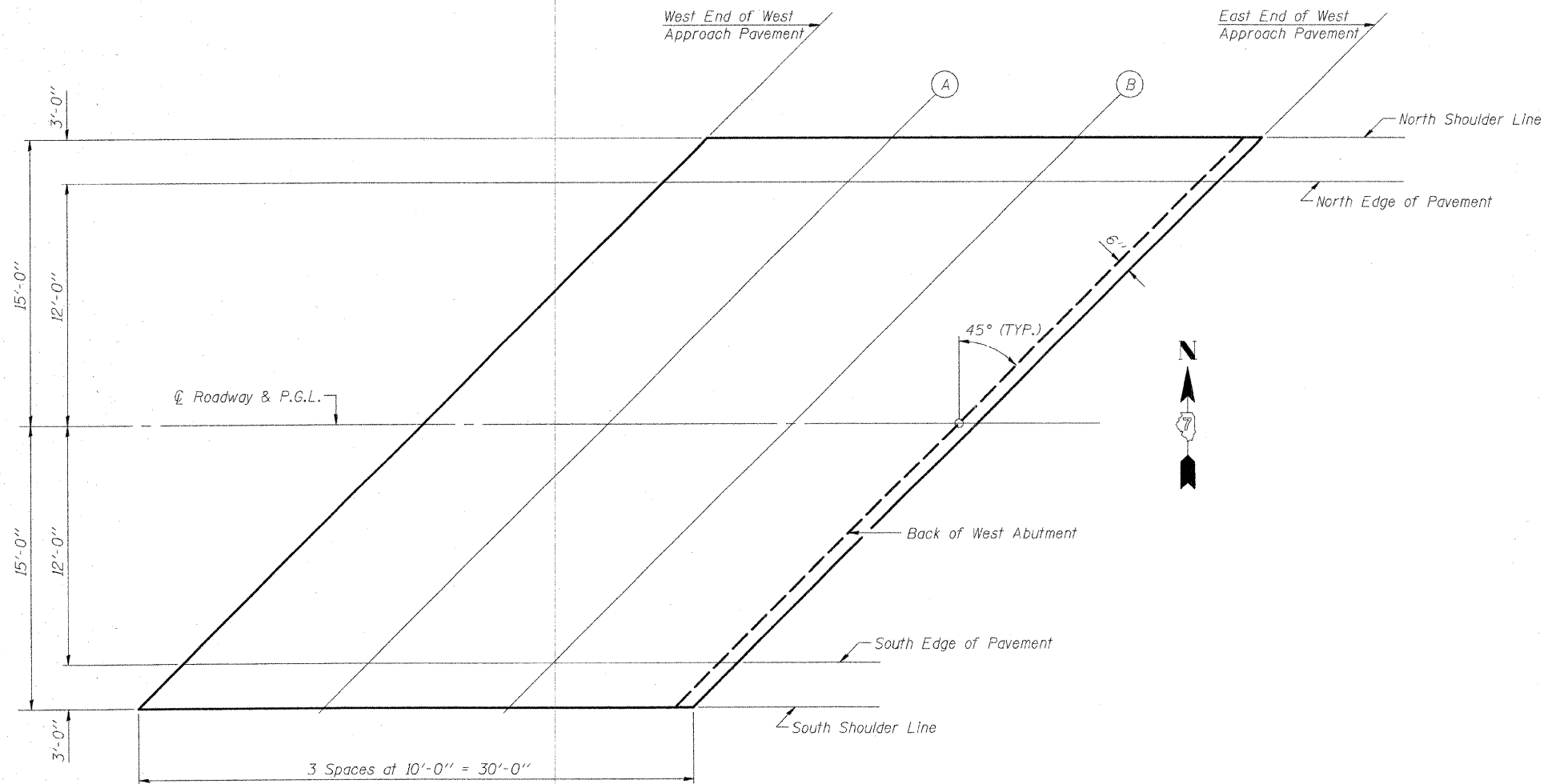

PLAN

TOP OF WEST APPROACH SLAB ELEVATIONS
 F.A.S. 662 (TR 61) OVER EMBARRAS RIVER
 CUMBERLAND COUNTY
 SECTION 01-00061-00-BR
 STA. 470+75.00
 STRUCTURE NUMBER 018-3191
 PROFESSIONAL DESIGN FIRM LICENSE #184-001084

© Copyright Hanson Professional Services Inc. 2008



JOB NO.
01S2021B
DATE
02/04/08

04/04/2008 03:06 PM
 I:\01606101S2021B\Cadd\Struct\Sheet\River_Bridge_Plans.dgn
 LAYOUT: MMW 11/30/07
 DRAWN: DAP 12/28/07
 REVIEWED: JMM 02/04/08