

FINAL SURVEY	SURVEYED	BY	DATE
NOTE BOOK	PLOTTED		
NO.	NO.		

ORIGINAL SURVEY	SURVEYED	BY	DATE
NOTE BOOK	PLOTTED		
NO.	NO.		

LAYOUT	DJP/MNM	10/10/07
DRAWN	DJP	10/10/07
REVIEWED	JMM	02/04/08

© Copyright Hanson Professional Services Inc. 2008
HANSON
 Hanson Professional Services Inc.

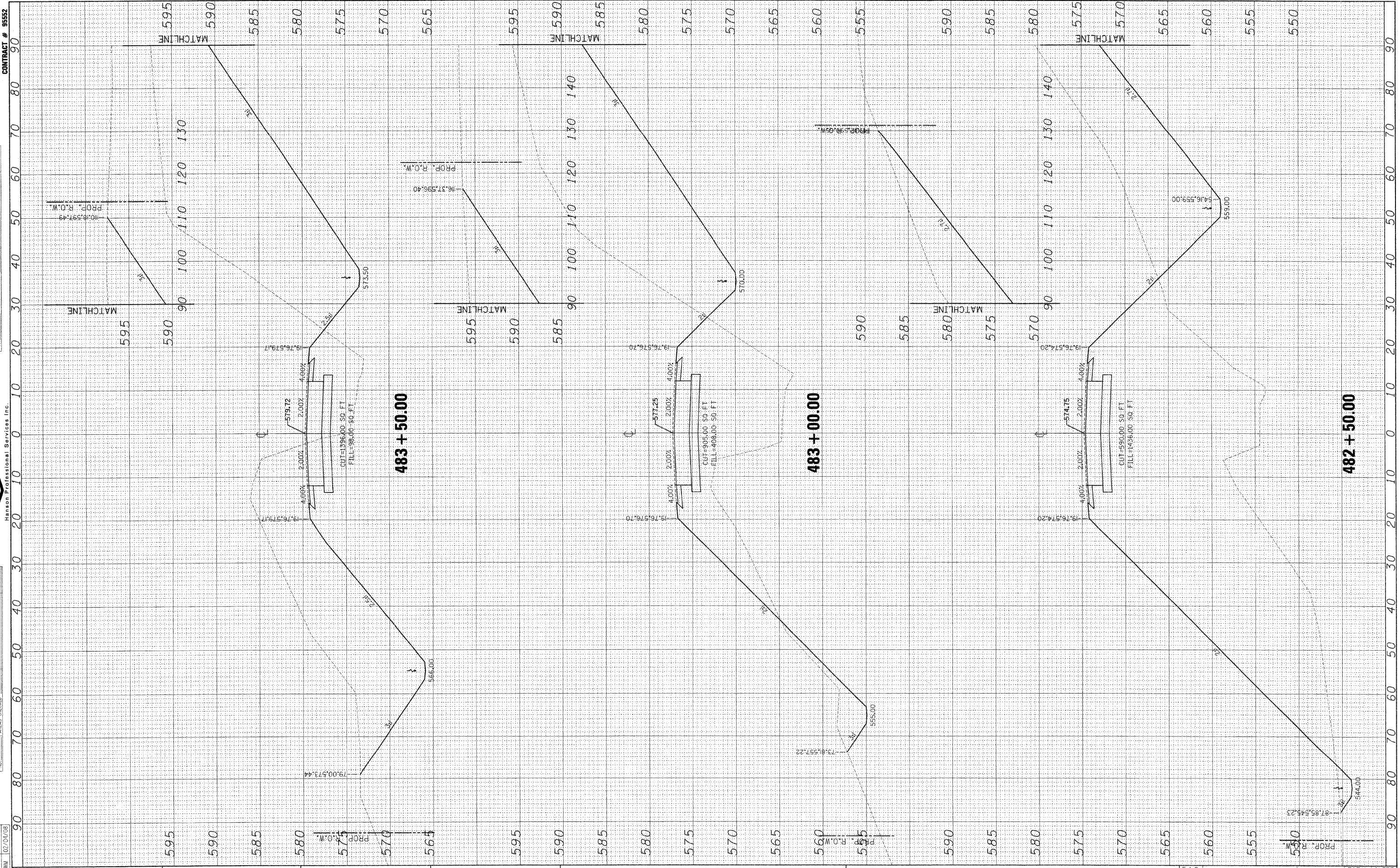

FILE NAME = I:\181\jobs\0122021B\CADD\Road\Sheet\C-301.dgn
 USER NAME = Pop00275

DESIGNED - MNM/DJP
 DRAWN - DJP
 CHECKED - MNM
 DATE - 10/10/07

REVISED -
 REVISED -
 REVISED -
 REVISED -

**STATE OF ILLINOIS
 DEPARTMENT OF TRANSPORTATION**

CROSS SECTIONS - MAINLINE
 SCALE: SHEET NO. 12 OF 16 SHEETS STA. 482+50.00 TO STA. 483+50.00

F.A.S. RTE.	SECTION	COUNTY	TOTAL SHEETS	SHEET NO.
662	00-00061-00-BR	CUMBERLAND	85	78
FED. ROAD DIST. NO.		ILLINOIS FED. AID PROJECT		
CONTRACT NO. 95552				