

**BEGIN CONSTRUCTION  
 STA. 100+40.54  
 (SEE SHEETS 5-8 FOR  
 71ST STREET PLAN)**

**LEGEND**

- LIMITS OF HOT-MIX ASPHALT SURFACE COURSE, MIX "C", N50, 2" ON 1" LEVELING BINDER
- LIMITS OF SIDE STREET TRANSITION (SEE BUTT JOINT DETAIL ON SHEET 2)
- LIMITS OF 2' AGGREGATE SHOULDER OR AGGREGATE DRIVEWAY TRANSITION
- LIMITS OF 2' HOT-MIX ASPHALT DRIVEWAY TRANSITION

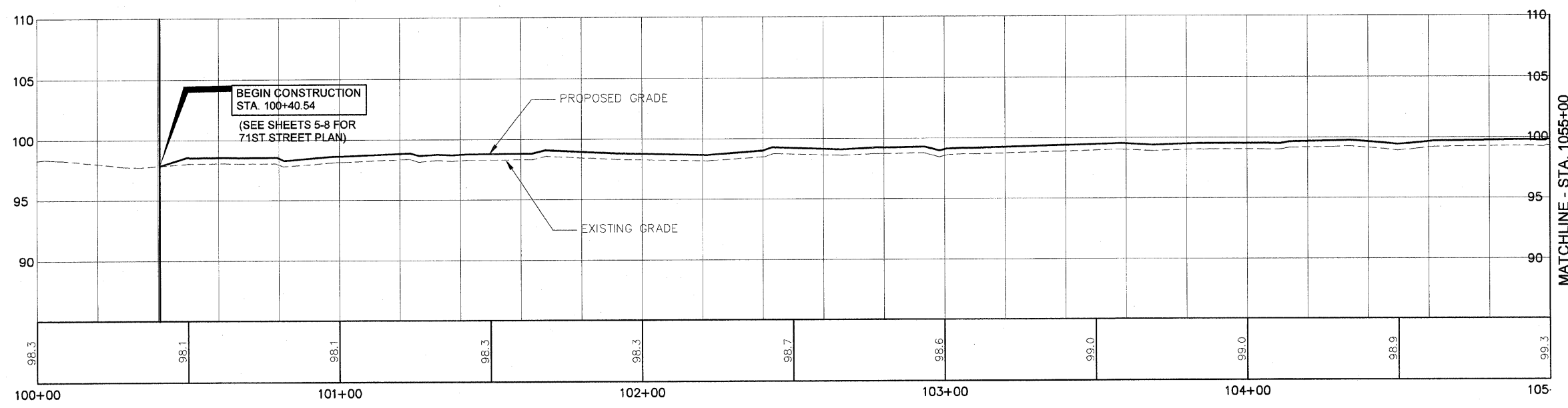

SCALE:  
 1" = 20' HORIZ.  
 1" = 5' VERT.

FEDERALLY FUNDED STREET RESURFACING  
 CITY OF CENTREVILLE  
 ST. CLAIR COUNTY, ILLINOIS  
 SEC. 05-00015-00-RS

MARK	DATE	DESCRIPTION

PROJECT NO: 210-1916  
 DESIGN: CKA    DRAWN: SDD    CHECK: MRA

PLAN SHEET -  
 EDNA STREET -  
 ASH ST. TO  
 120 FEET EAST OF  
 74TH STREET