

SIGNATURE _____
 DATE _____
 LICENSE EXPIRES _____

FEDERALLY FUNDED STREET RESURFACING
 CITY OF CENTREVILLE
 ST. CLAIR COUNTY, ILLINOIS
 SEC. 05-00015-00-RS

MARK	DATE	DESCRIPTION

PROJECT NO: 210-1916		
DESIGN: CKA	DRAWN: SDD	CHECK: MRA

PLAN SHEET -
 RUSSELL AVE. -
 68TH STREET TO
 72ND STREET

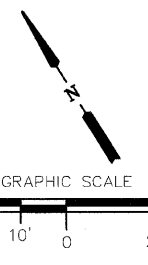

LEGEND

- LIMITS OF HOT-MIX ASPHALT SURFACE COURSE. MIX "C", N50, 2" ON 1" LEVELING BINDER
- LIMITS OF SIDE STREET TRANSITION (SEE BUTT JOINT DETAIL ON SHEET 2)
- LIMITS OF 2' AGGREGATE SHOULDER OR AGGREGATE DRIVEWAY TRANSITION
- LIMITS OF 2' HOT-MIX ASPHALT DRIVEWAY TRANSITION

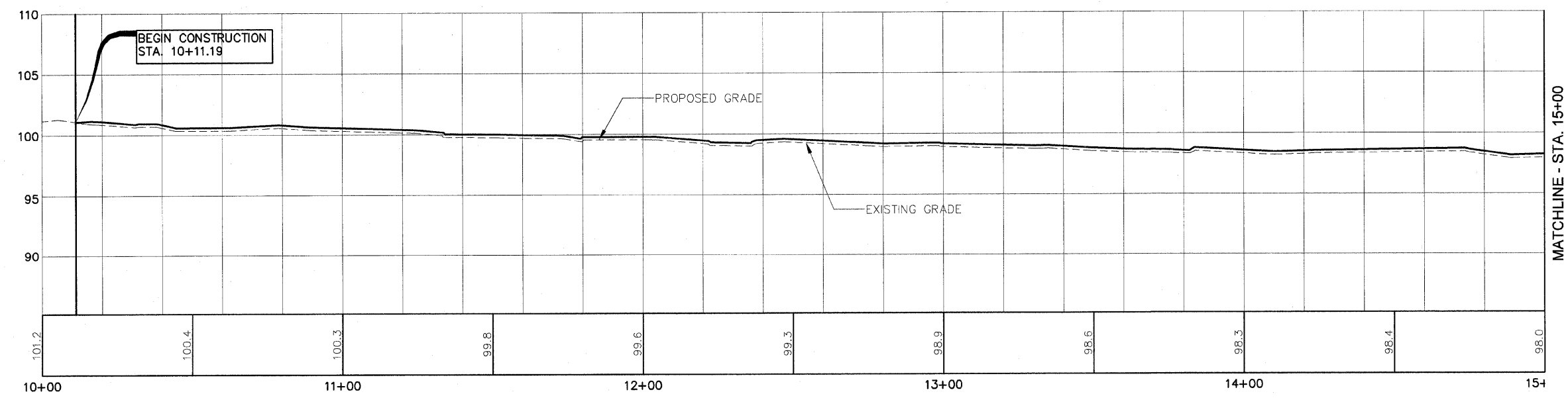
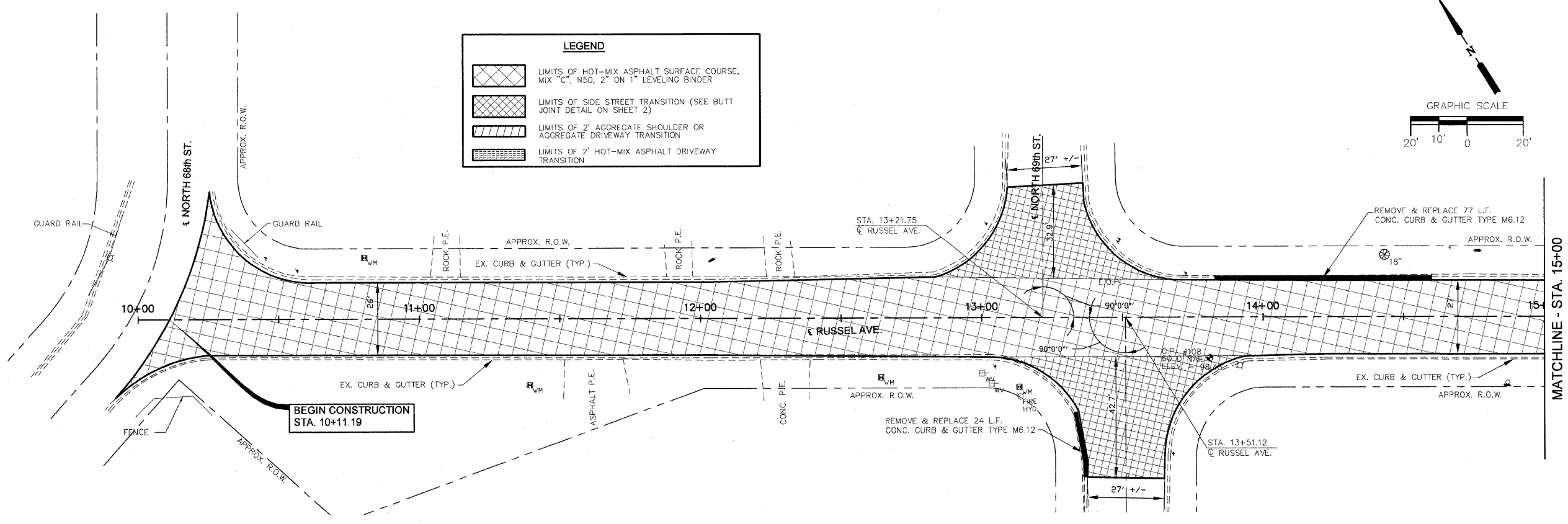

SCALE:
 1" = 20' HORIZ.
 1" = 5' VERT.