

F.A.S. RTE.	SECTION	COUNTY	TOTAL SHEETS	SHEET NO.
932	(8,9,11)W,RS-1	*	401	52
STA.		TO STA.		
FED. ROAD DIST. NO.		ILLINOIS FED. AID PROJECT		
* JOHNSON & POPE				

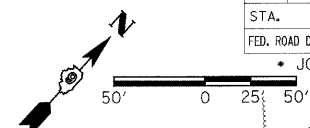

EXIST. CURVE 5
 PI STA. = 130+44.64
 $\Delta = 7^\circ 46' 27''$ (LT)
 $D = 2^\circ 04' 27''$
 $R = 2,762.34'$
 $T = 187.69'$
 $L = 374.80'$
 $E = 6.37'$
 P.C. STA. = 128+56.95
 P.T. STA. = 132+31.75

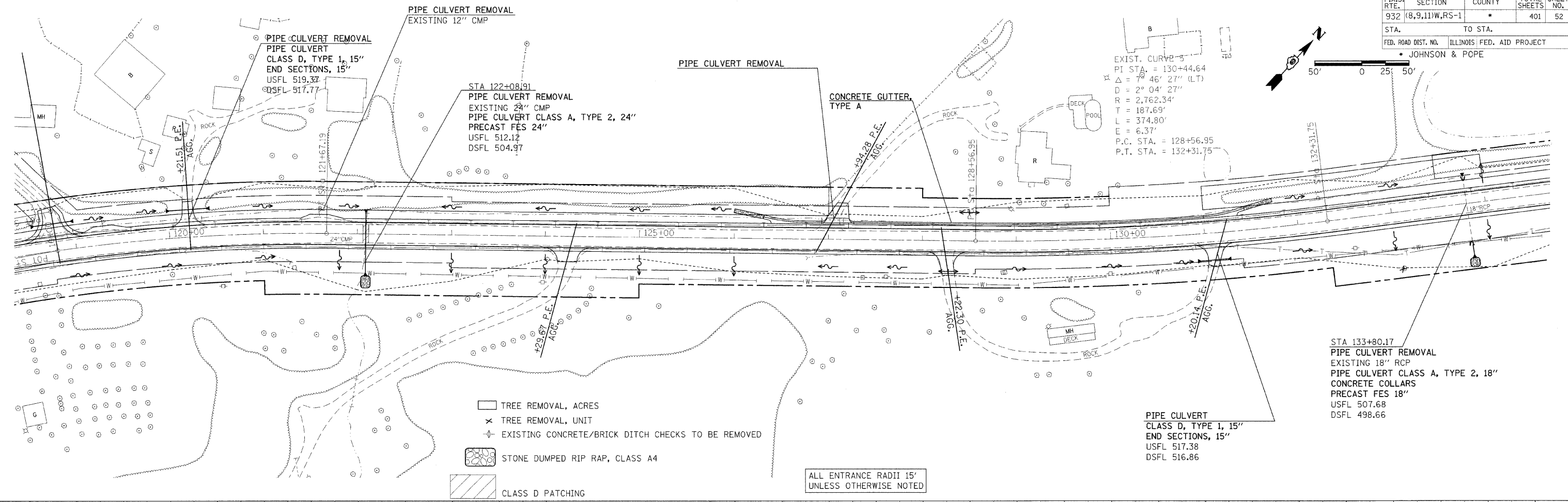

BMI1 - R.R. SPIKE IN P.P. 48.5' RT
 ELEV 512.97 STA 124+00

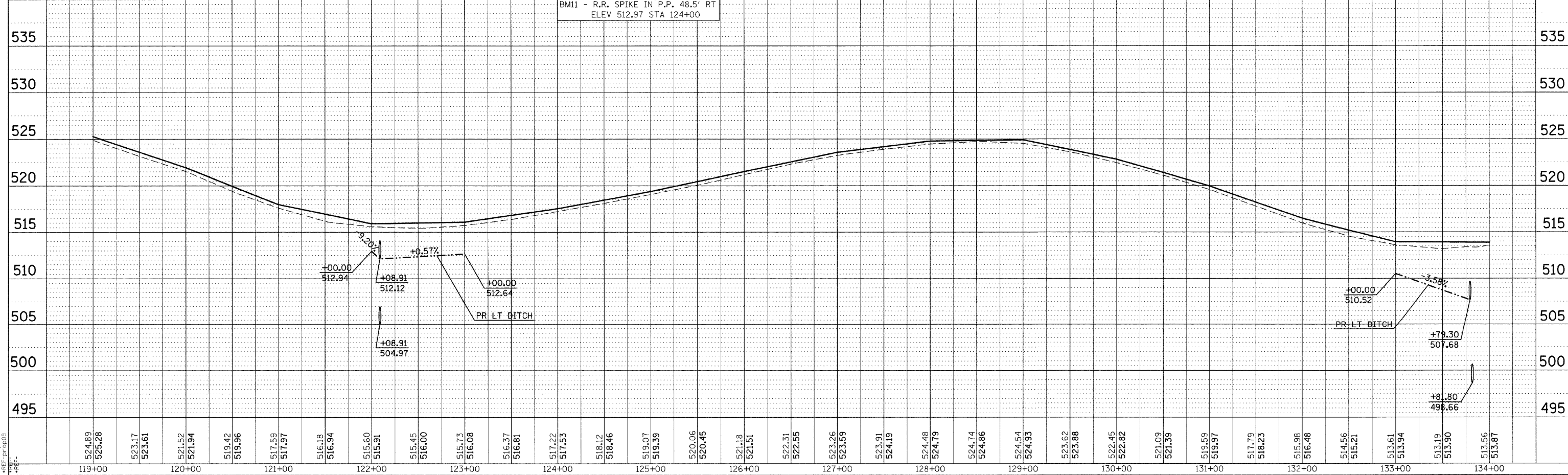

PLAN PROFILE SHEET STA 119+00 TO 134+00

PLAN	DATE
NO.	BY
NO.	BY
NO.	BY

PROFILE	DATE
NO.	BY
NO.	BY
NO.	BY

DATE-TIME
 CON-SPEC
 REF-100009
 REF-100009