

F.A.S. RTE.	SECTION	COUNTY	TOTAL SHEETS	SHEET NO.
932	(8,9,11)W,RS-1		401	81
STA.		TO STA.		
FED. ROAD DIST. NO.		ILLINOIS	FED. AID PROJECT	
• JOHNSON & POPE				

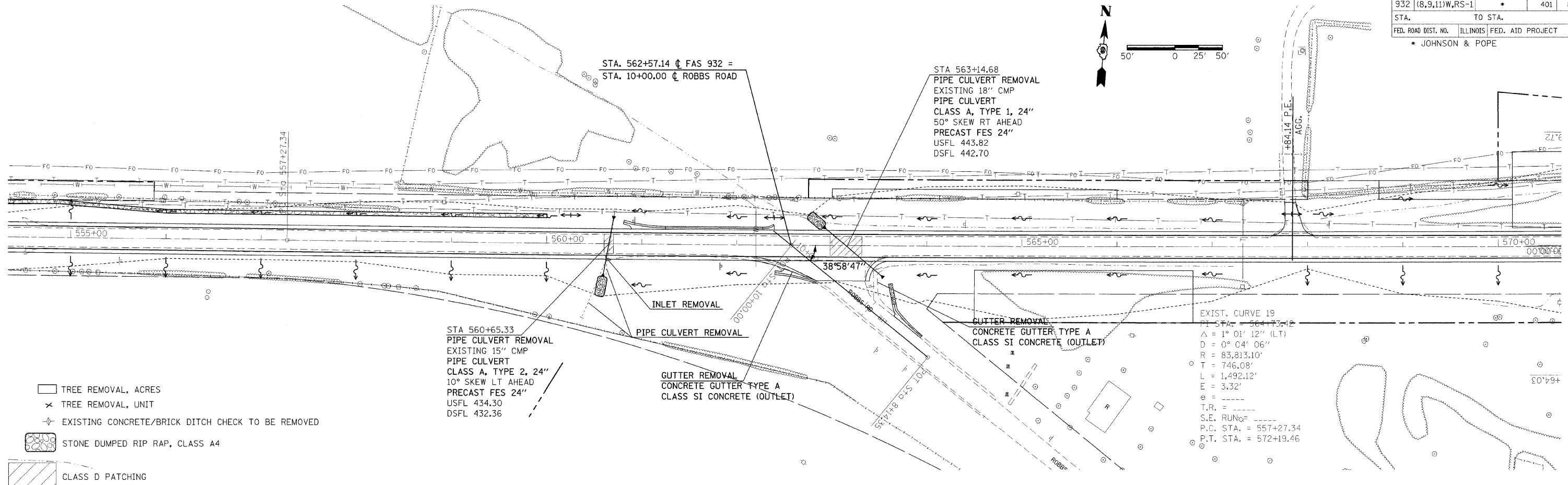
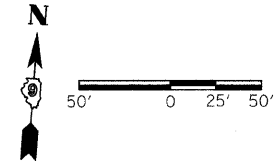

- TREE REMOVAL, ACRES
- TREE REMOVAL, UNIT
- EXISTING CONCRETE/BRICK DITCH CHECK TO BE REMOVED
- STONE DUMPED RIP RAP, CLASS A4
- CLASS D PATCHING

EXIST. CURVE 19  
 P.I. STA. = 564+73.42  
 $\Delta = 1^\circ 01' 12''$  (LT)  
 $D = 0^\circ 04' 06''$   
 $R = 83,813.10'$   
 $T = 746.08'$   
 $L = 1,492.12'$   
 $E = 3.32'$   
 $T.R. =$   
 $S.E. RUN =$   
 P.C. STA. = 557+27.34  
 P.T. STA. = 572+19.46

PLAN	DATE
BY	
REVISIONS	
NO.	DATE
1	

PROFILE	DATE
BY	
REVISIONS	
NO.	DATE
1	

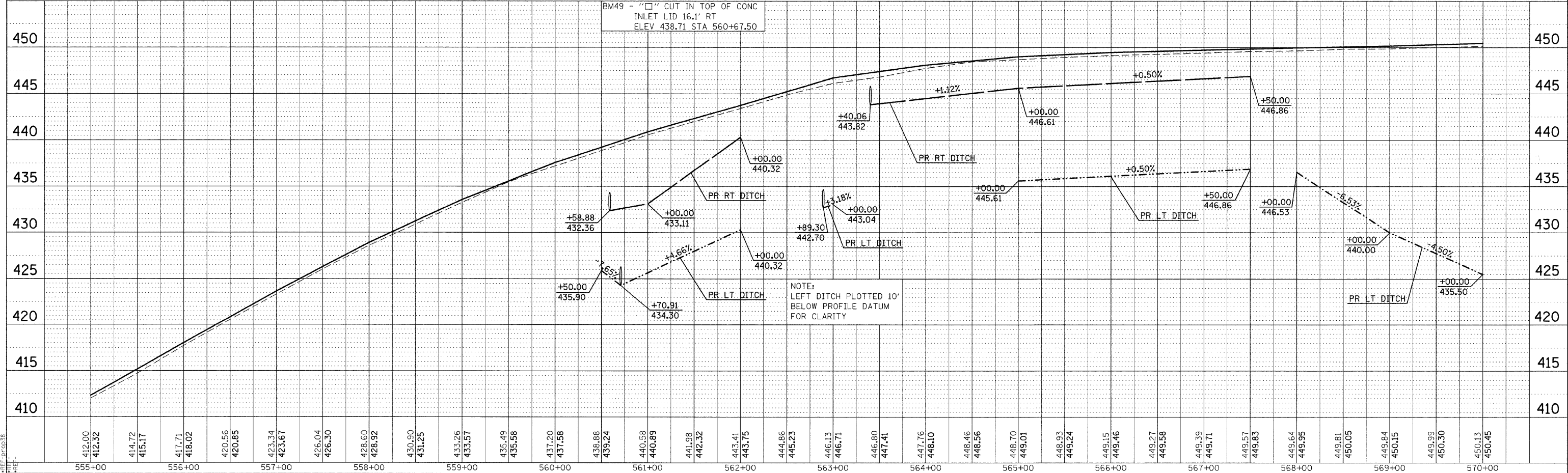

NOTE:  
 LEFT DITCH PLOTTED 10'  
 BELOW PROFILE DATUM  
 FOR CLARITY

PLAN PROFILE SHEET STA 555+00 TO 570+00

\*DATE-TIME\*  
 \*JOB-SPEC\*  
 \*REF-TOPOGRAPHY\*  
 \*REF-PLANS\*