

F.A.S. RTE.	SECTION	COUNTY	TOTAL SHEETS	SHEET NO.
932	(8,9,11)W,RS-1	*	401	86
STA.	TO STA.			
FED. ROAD DIST. NO.	ILLINOIS FED. AID PROJECT			
* JOHNSON & POPE				

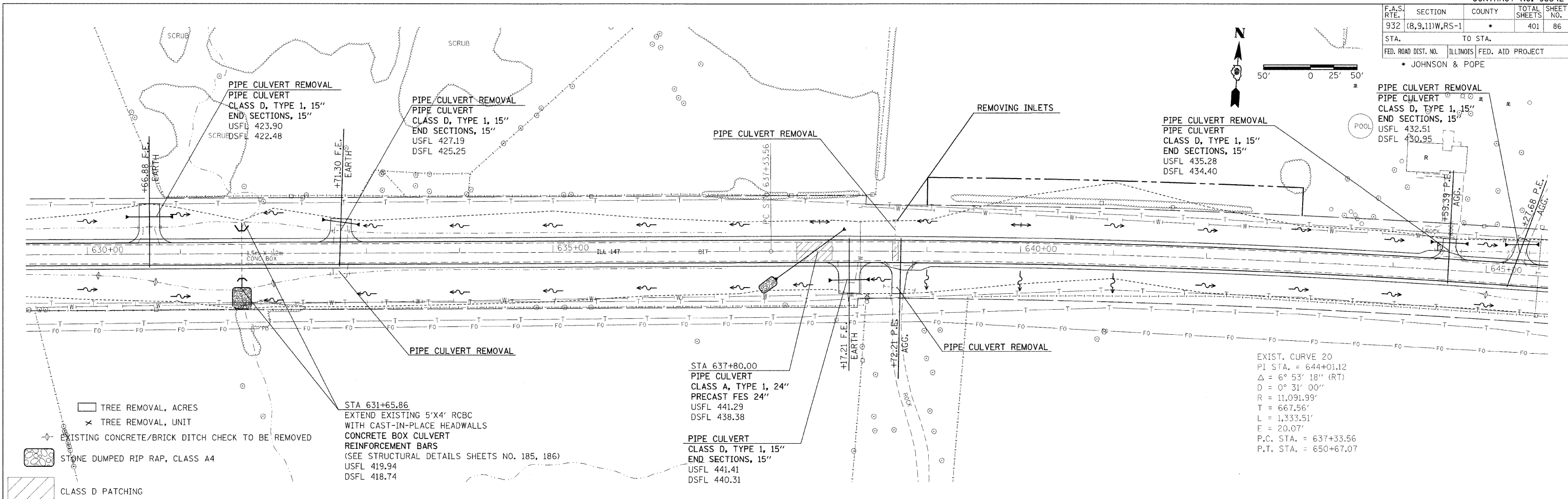

PLAN	SURVEYED	BY	DATE
	NOTE BOOK		
	NO.		

PROFILE	SURVEYED	BY	DATE
	NOTE BOOK		
	NO.		

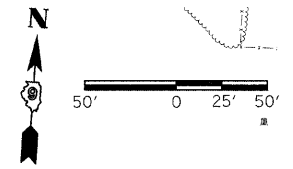
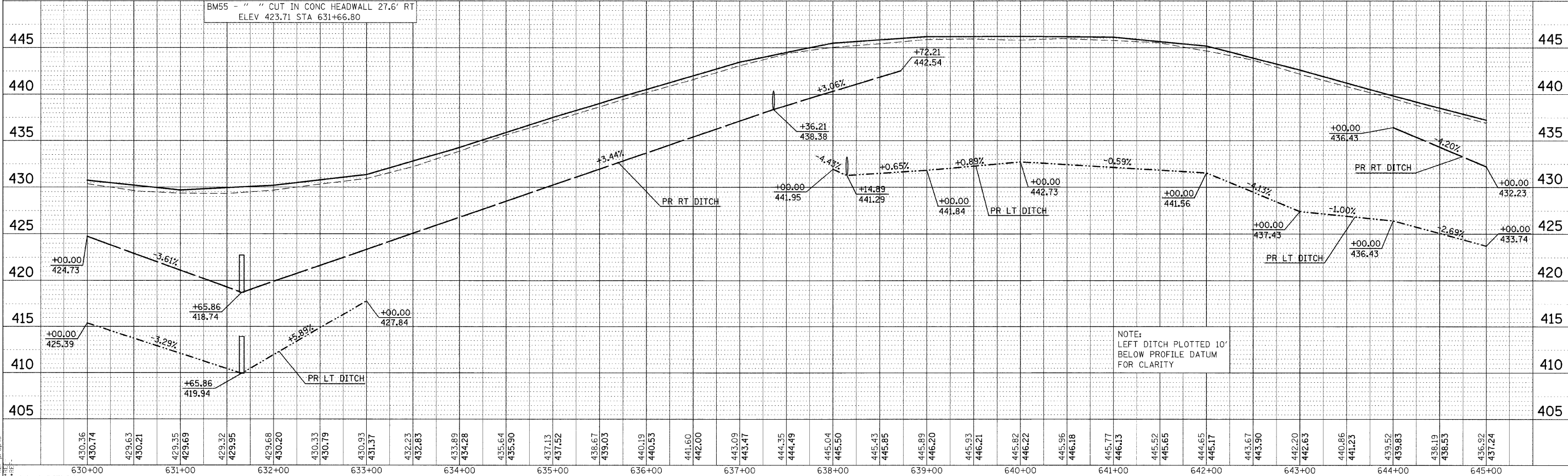

NOTE:
LEFT DITCH PLOTTED 10'
BELOW PROFILE DATUM
FOR CLARITY

PLAN PROFILE SHEET STA 630+00 TO 645+00