

F.A.S. RTE.	SECTION	COUNTY	TOTAL SHEETS	SHEET NO.
932	(8,9,11)W,RS-1	*	401	89
STA.		TO STA.		
FED. ROAD DIST. NO.		ILLINOIS FED. AID PROJECT		
* JOHNSON & POPE				

PIPE CULVERT REMOVAL  
 PIPE CULVERT CLASS D,  
 TYPE 1, 15"  
 END SECTIONS 15"  
 USFL 390.75  
 DSFL 390.41

D = 27° 42' 52"  
 R = 206.74'  
 T = 77.48'  
 L = 148.25'  
 E = 14.04'

T.R. = ---  
 S.E. RUN = ---  
 P.C. STA. = 675+60.11  
 P.T. STA. = 677+08.36

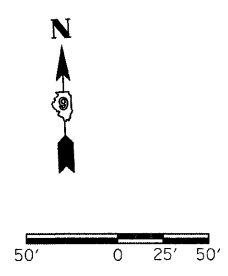
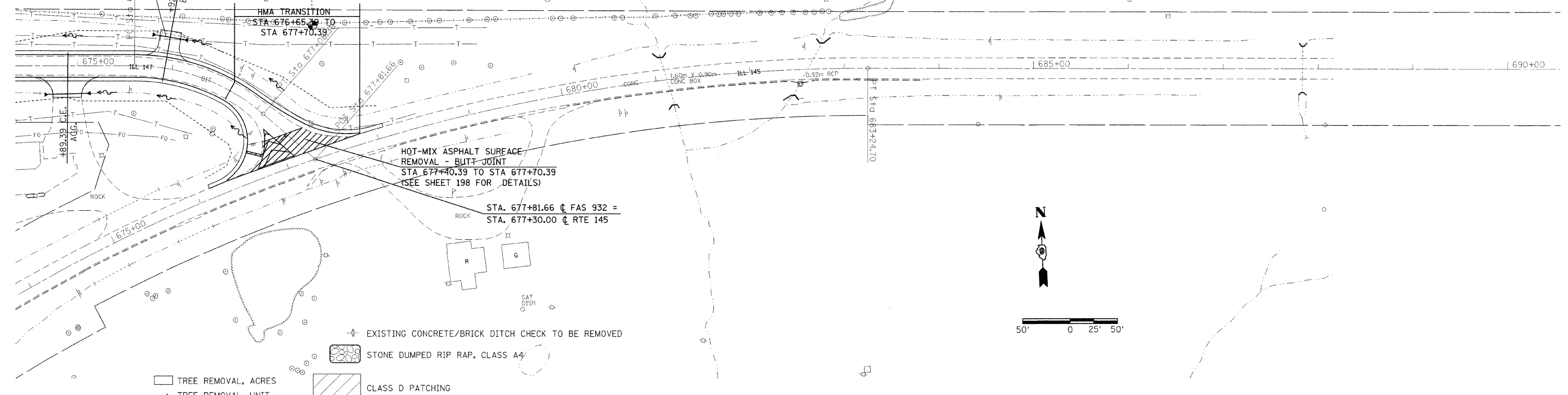

DATE	BY	REVISION

DATE	BY	REVISION

DATE-TIME  
 \*REF-SPEC  
 \*REF-PLAN

