

F.A.S. RTE.	SECTION	COUNTY	TOTAL SHEETS	SHEET NO.
932	(8,9,11)W,RS-1	*	401	91
STA.	TO STA.			
FED. ROAD DIST. NO.	ILLINOIS	FED. AID PROJECT		
* JOHNSON & POPE				

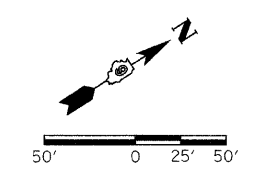

PLAN	SURVEYED	DATE
	ALIGNED	
	CHECKED	
	BY	
	NO.	

PROFILE	SURVEYED	DATE
	ALIGNED	
	CHECKED	
	BY	
	NO.	

DATE: 11/11/02
 BY: JPP
 CHECKED: JPP
 NO.: 11/11/02

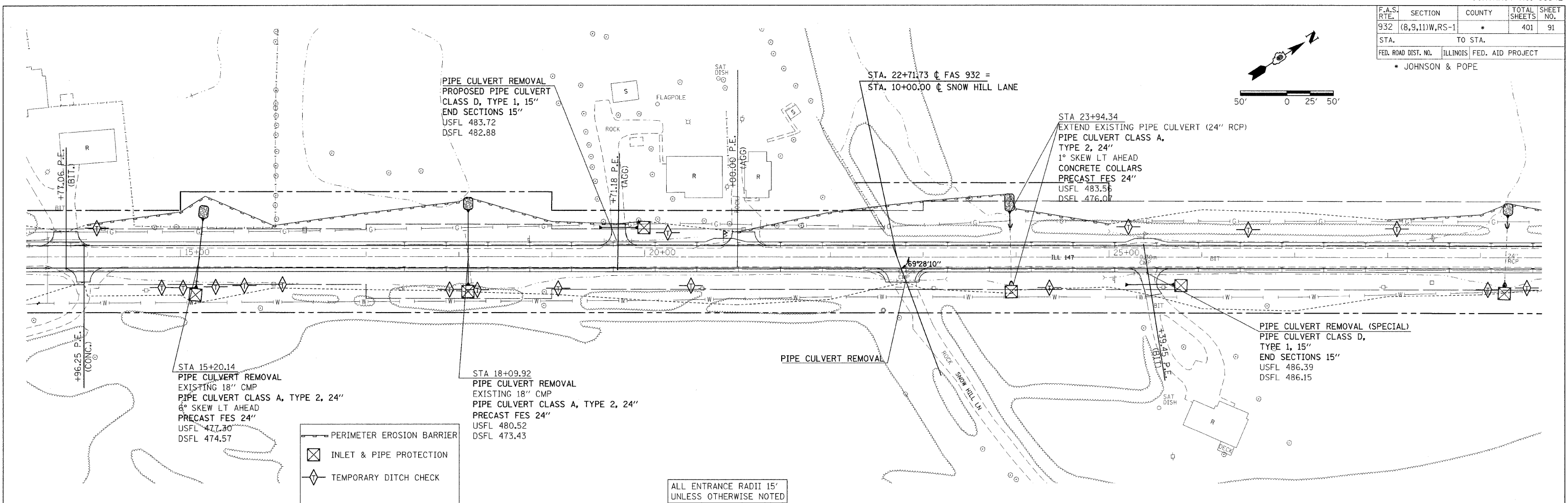

- PERIMETER EROSION BARRIER
- INLET & PIPE PROTECTION
- TEMPORARY DITCH CHECK

ALL ENTRANCE RADII 15'
UNLESS OTHERWISE NOTED

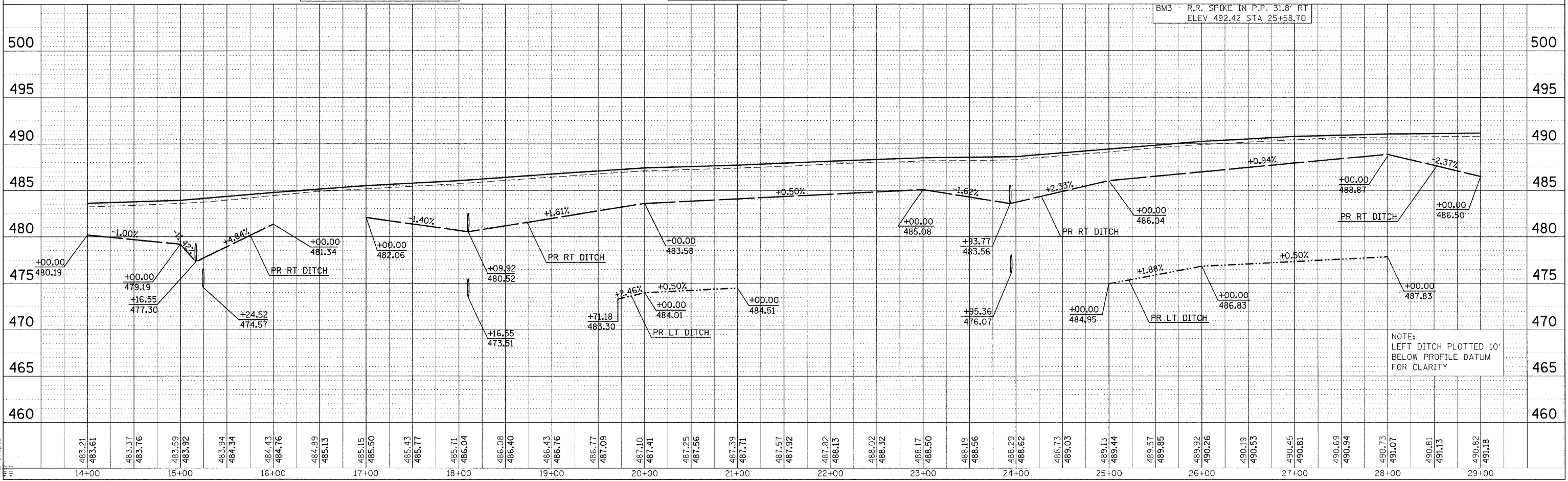

NOTE:
LEFT DITCH PLOTTED 10'
BELOW PROFILE DATUM
FOR CLARITY

EROSION CONTROL PLAN SHEET STA 14+00 TO 29+00