

F.A.S. RTE.	SECTION	COUNTY	TOTAL SHEETS	SHEET NO.
932	(8,9,11)W,RS-1	*	401	99
STA.	TO STA.			
FED. ROAD DIST. NO.	ILLINOIS	FED. AID PROJECT		
* JOHNSON & POPE				

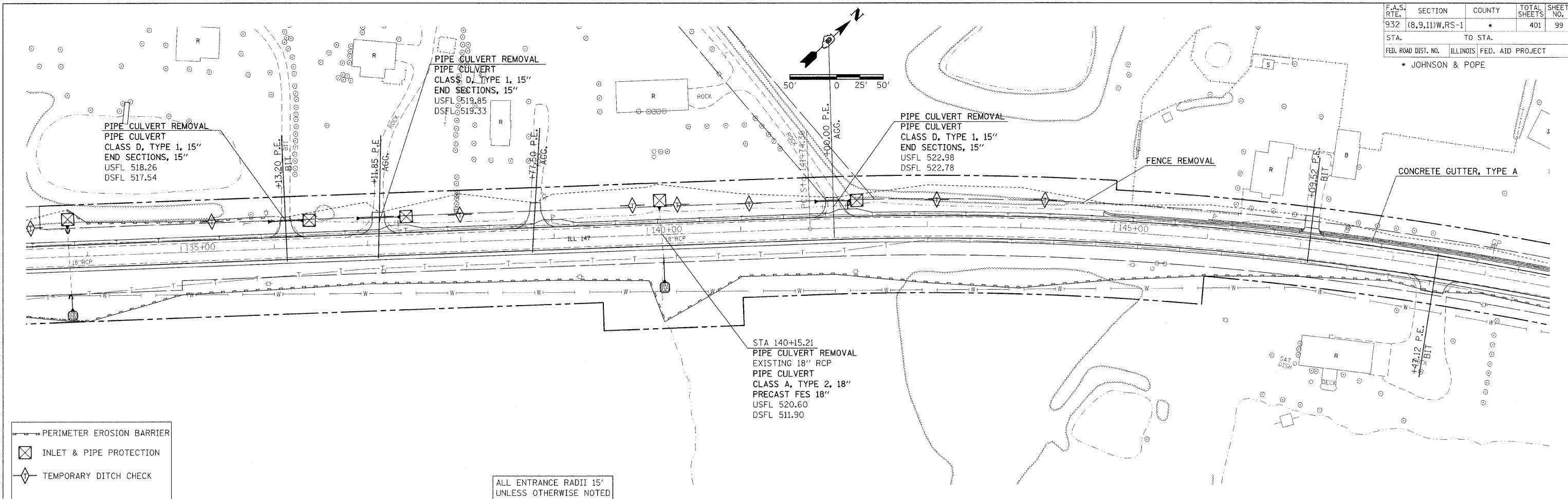

DATE	BY

DATE	BY

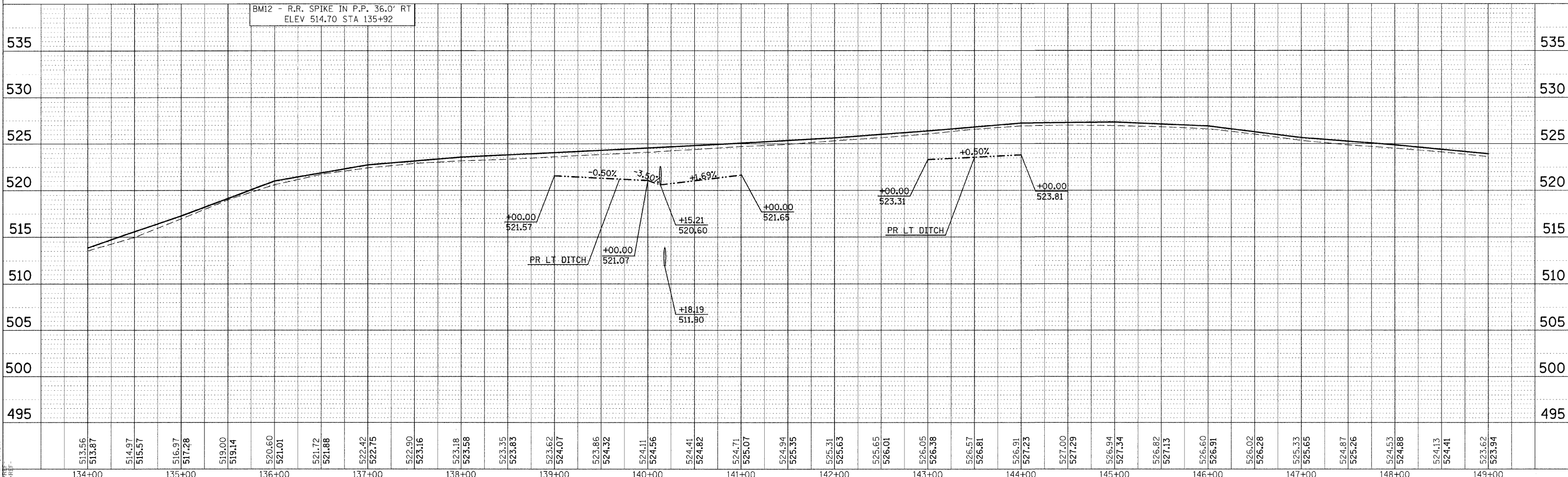

DATE TIME
 *CONS-SPR
 *REF-POB-30
 *REF-PCDDIO
 *REF-