

F.A.S. RTE.	SECTION	COUNTY	TOTAL SHEETS	SHEET NO.
932	(8,9,11)W,RS-1		401	102
STA. TO STA.		ILLINOIS FED. AID PROJECT		
		• JOHNSON & POPE		

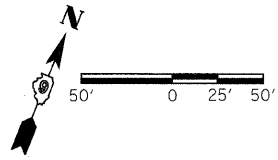

PLAN	DATE	BY

PROFILE	DATE	BY

DATE TIME
DRAWN SPEC
REF TOPOG
REF PROP
PREP

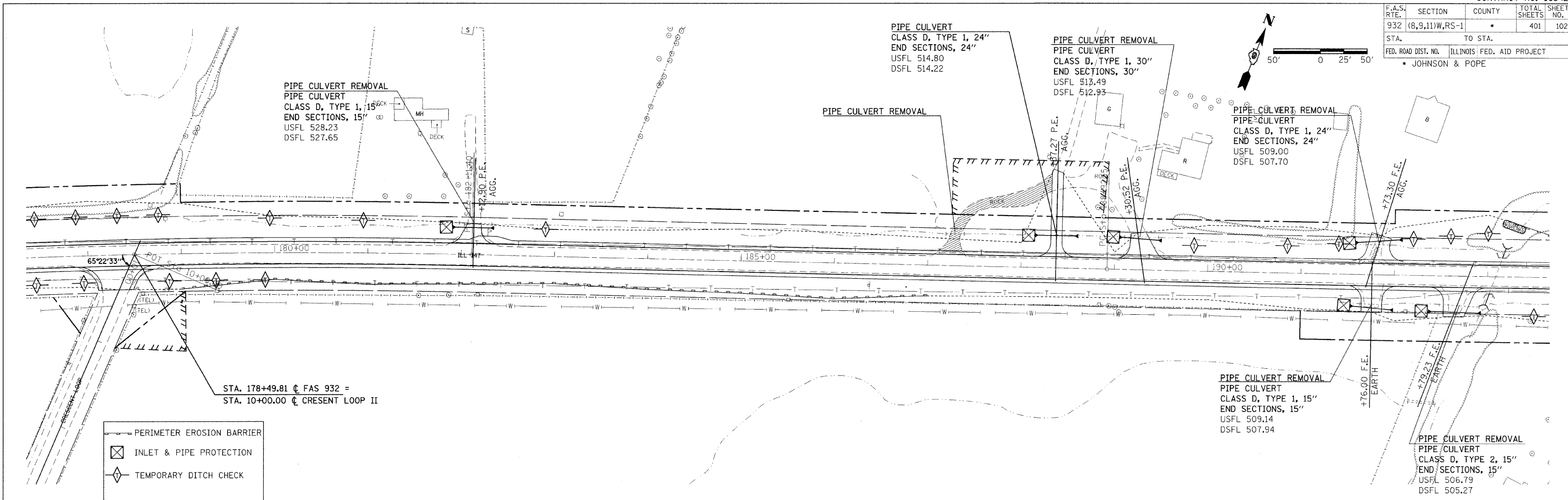

- PERIMETER EROSION BARRIER
- ⊠ INLET & PIPE PROTECTION
- ◇ TEMPORARY DITCH CHECK

STA. 178+49.81 @ FAS 932 =
STA. 10+00.00 @ CRESENT LOOP II

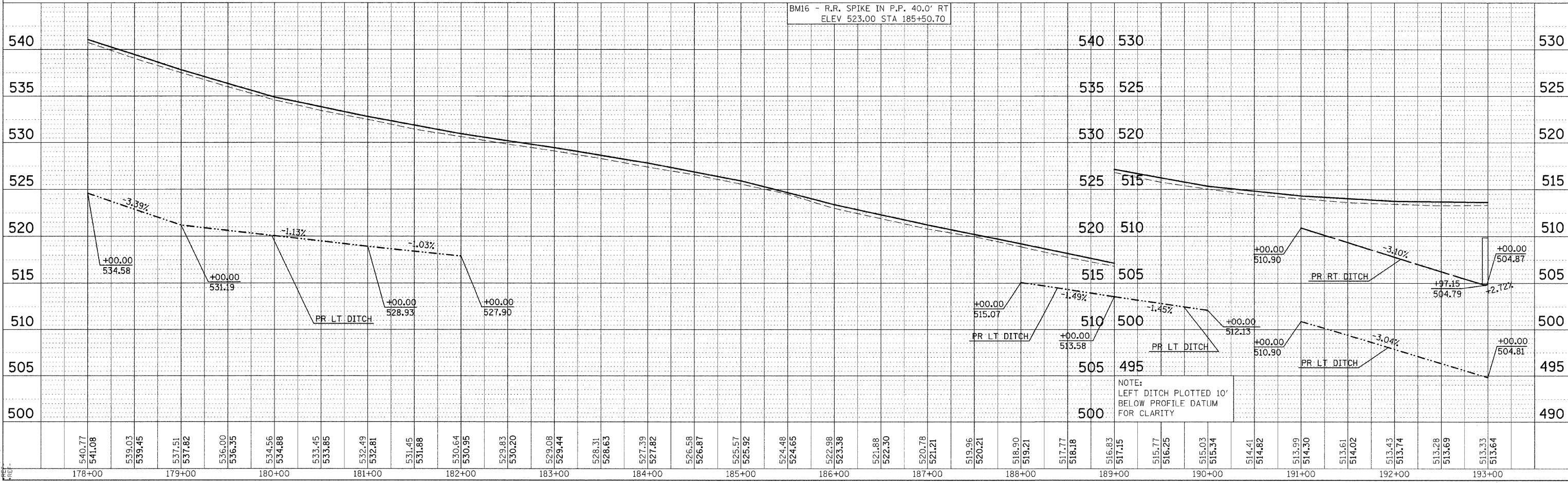

EROSION CONTROL PLAN SHEET STA 178+00 TO 193+00