

F.A.S. RTE.	SECTION	COUNTY	TOTAL SHEETS	SHEET NO.
932	(8,9,11)W,RS-1	*	401	124
STA.		TO STA.		
FED. ROAD DIST. NO.		ILLINOIS FED. AID PROJECT		
* JOHNSON & POPE				

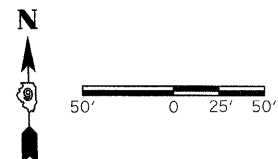

DATE	BY

DATE	BY

$\Delta = 20^\circ 46' 36''$ (K1)
 $D = 2^\circ 59' 01''$
 $R = 1,920.34'$
 $T = 352.04'$
 $L = 696.36'$
 $E = 32.00'$
 $\theta = \dots$
 $T.R. = \dots$
 $S.E. RUN = \dots$
 $P.O.P. STA. = 513+29.13$
 $P.T. STA. = 520+25.48$

PIPE CULVERT REMOVAL
 PIPE CULVERT
 CLASS D, TYPE 1, 15"
 END SECTIONS, 15"
 USFL 431.33
 DSFL 430.79

STA 515+31.62
PIPE CULVERT REMOVAL
 EXTEND EXISTING PIPE CULVERT (24" RCP)
 PIPE CULVERT
 CLASS A, TYPE 2, 24"
 43° SKEW RT AHEAD
 CONCRETE COLLARS
 PRECAST FES 24"
 USFL 431.87
 DSFL 424.51

STA 518+16.04
 EXISTING 24" RCP
 TO REMAIN IN PLACE
 EXISTING USFL 429.95
 EXISTING DSFL 427.80

STA 522+61.07
PIPE CULVERT REMOVAL
 EXTEND EXISTING PIPE CULVERT (24" RCP)
 PIPE CULVERT
 CLASS A, TYPE 2, 24"
 2° SKEW LT AHEAD
 CONCRETE COLLARS
 PRECAST FES 24"
 USFL 426.50
 DSFL 421.89

EXIST. CURVE
 PI STA. = 526
 $\Delta = 15^\circ 12' 27''$
 $D = 2^\circ 52' 05''$
 $R = 1,997.67'$
 $T = 266.68'$
 $L = 530.22'$
 $E = 17.72'$
 $\theta = \dots$
 $T.R. = \dots$
 $S.E. RUN = \dots$
 $P.O.P. STA. = 5$
 $P.T. STA. = 5$

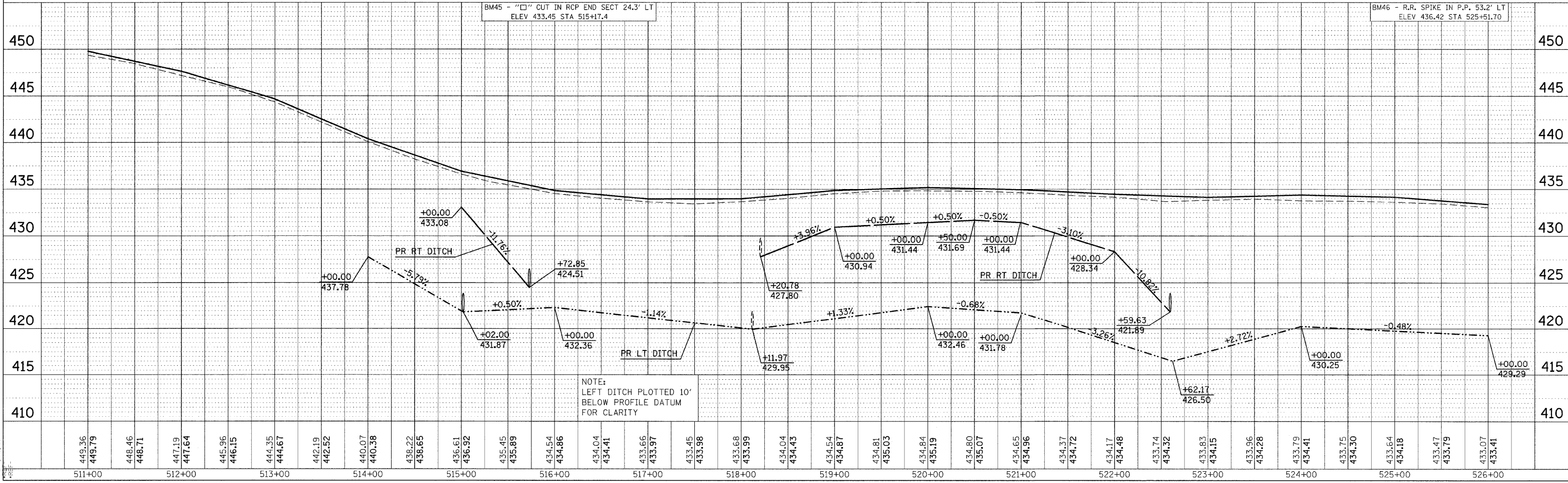
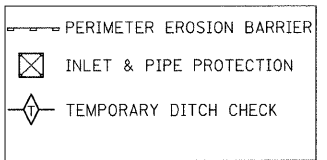
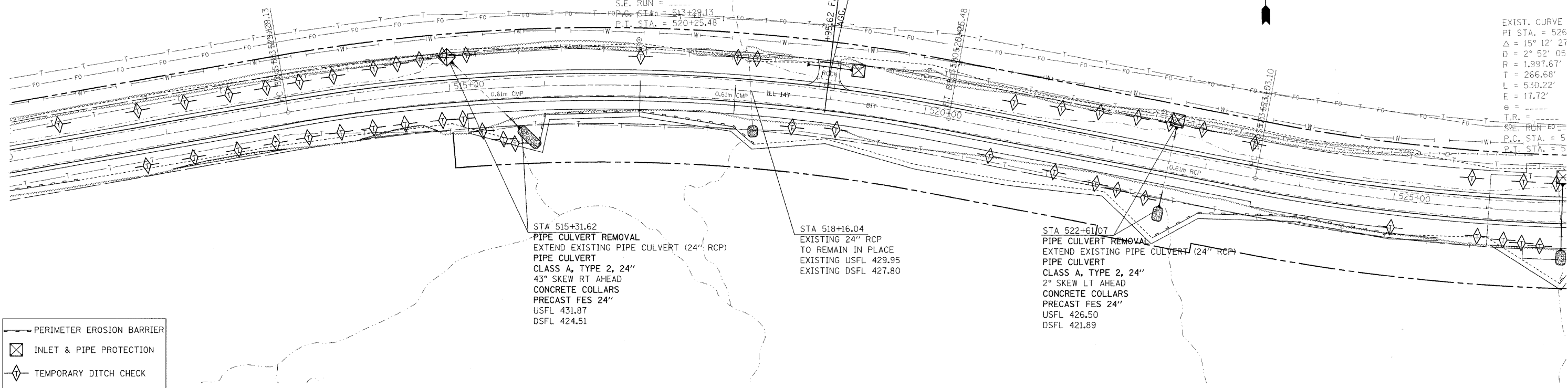

NOTE:
 LEFT DITCH PLOTTED 10'
 BELOW PROFILE DATUM
 FOR CLARITY