

F.A.S. RTE.	SECTION	COUNTY	TOTAL SHEETS	SHEET NO.
932	(8,9,11)W,RS-1	*	401	130
STA.		TO STA.		
FED. ROAD DIST. NO.		ILLINOIS	FED. AID PROJECT	
* JOHNSON & POPE				

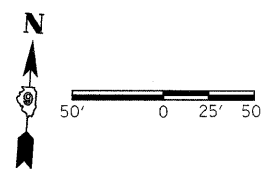

STA. 606+23.65 @ FAS 932 =
 STA. 10+00.00 @ MILLSTONE BLUFF ROAD

PLAN	SURVEYED	BY	DATE
	ALIGNED		
	CHECKED		
	NO. OF WAY CHECKED		
	NO.		
	ADD FILE NAME		

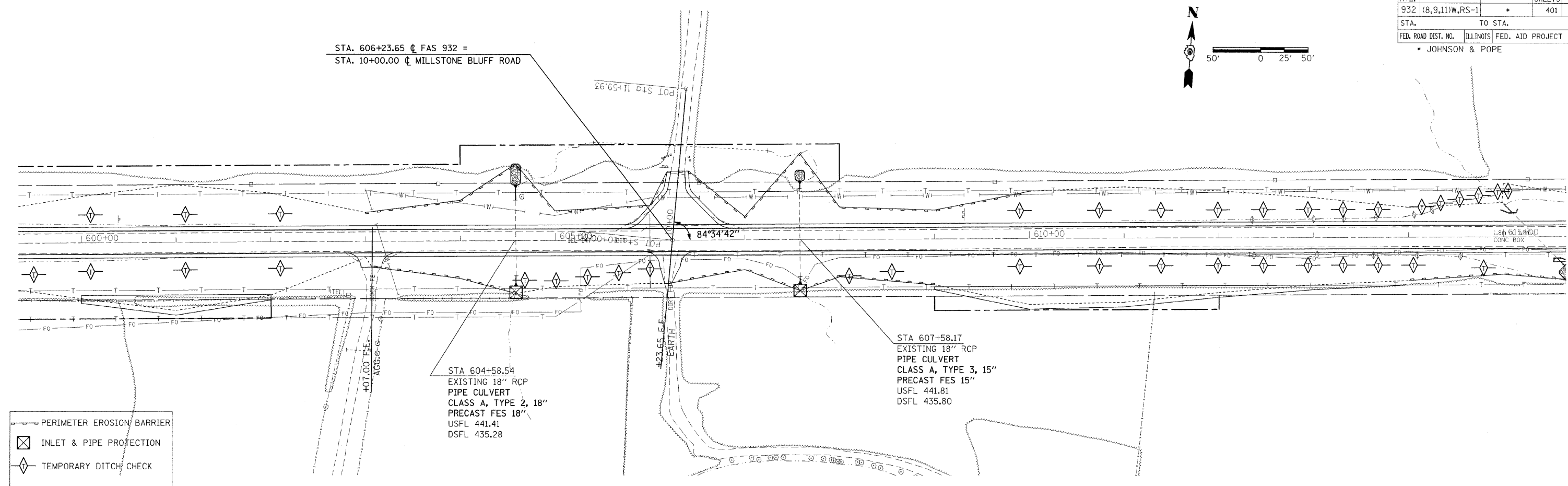

PROFILE	SURVEYED	BY	DATE
	GRADE		
	NOTED		
	STRUCTURE NOTATIONS		
	NO.		

BM53 - R.R. SPIKE IN P.P. 59.7' LT
 ELEV 449.04 STA 606+53.50

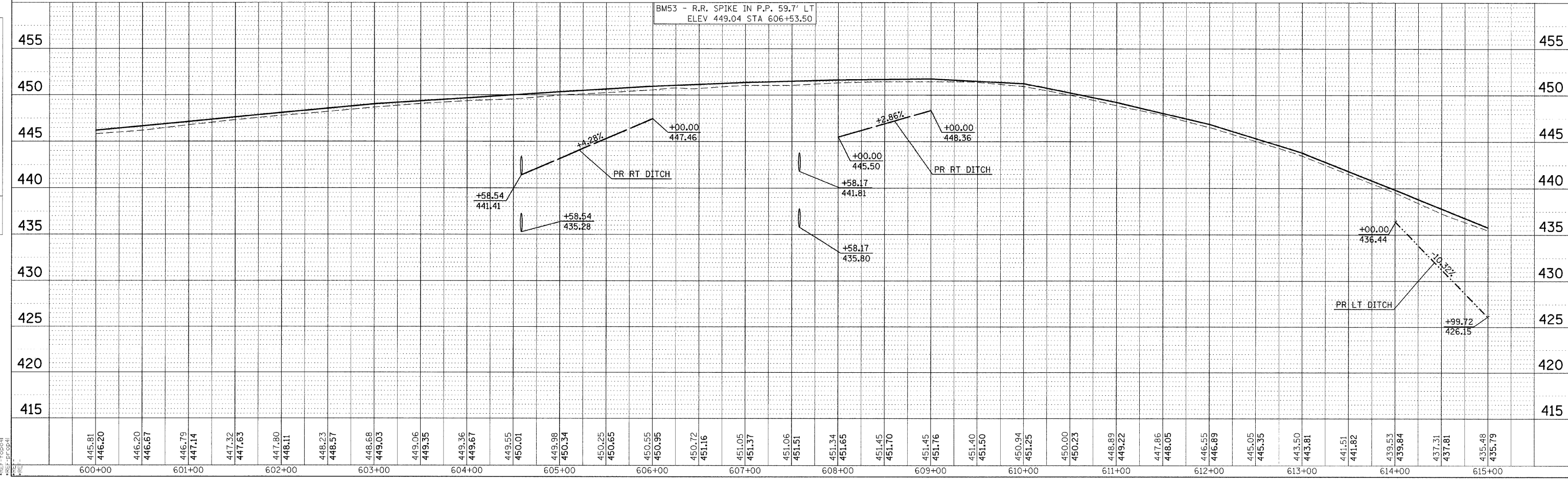

DATE TIME
 REF: 100-01
 REF: 100-01