

F.A.S. RTE.	SECTION	COUNTY	TOTAL SHEETS	SHEET NO.
932	(8,9,11)W,RS-1		401	206

STA.	TO STA.

FED. ROAD DIST. NO. ILLINOIS FED. AID PROJECT

JOHNSON & POPE

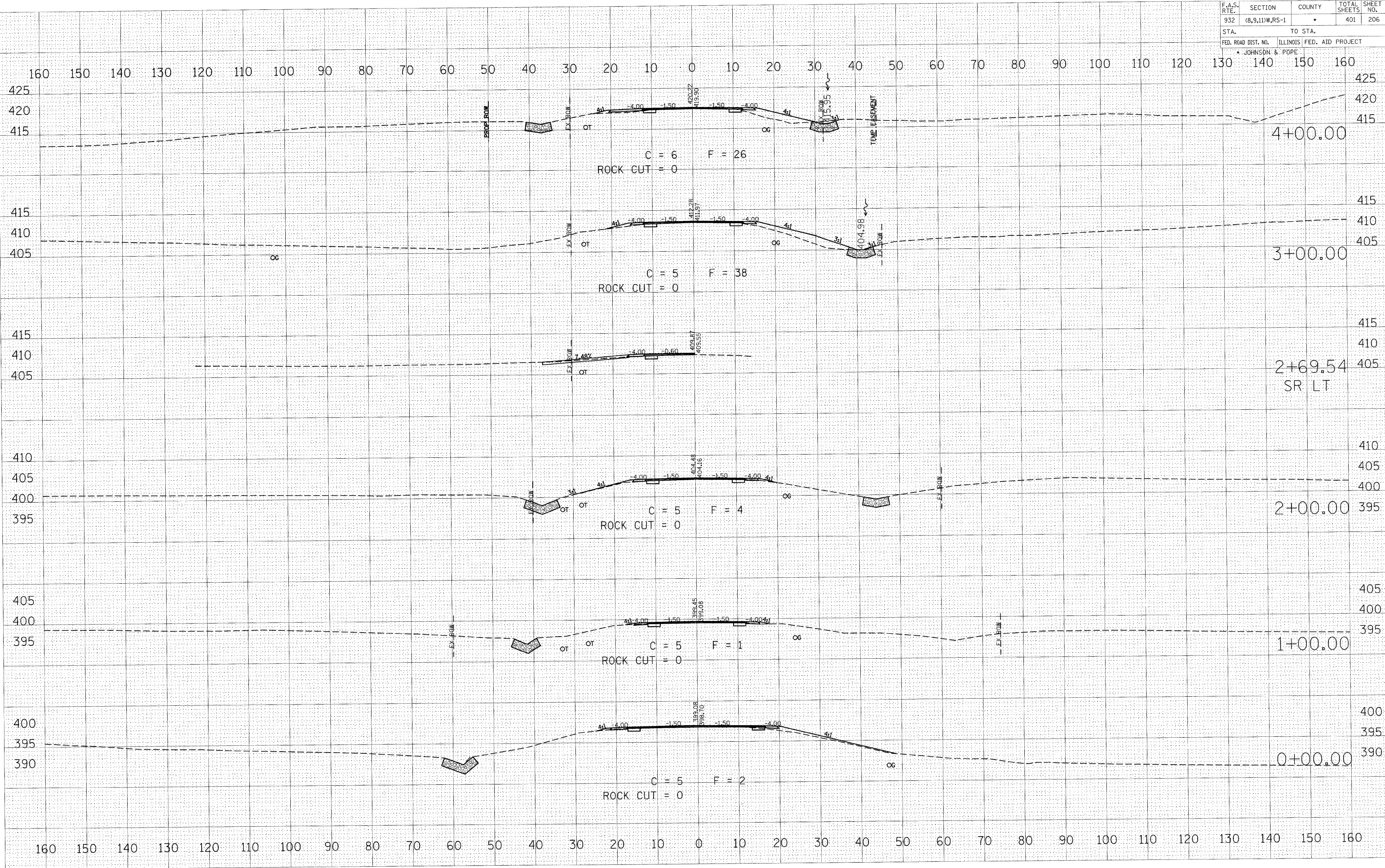

DATE
BY
FINAL SURVEY
NOTE BOOK
AREAS CHECKED
NO.

DATE
BY
ORIGINAL SURVEY
NOTE BOOK
AREAS CHECKED
NO.

PLOT DATE \* DATE \*  
 FILE NAME \* FILE \*  
 USER NAME \* USER \*