

F.A.S. RTE.	SECTION	COUNTY	TOTAL SHEETS	SHEET NO.
932	(8,9,11)W,RS-1	*	401	346
STA. 476+32.29		TO STA. 479+00.00		
FED. ROAD DIST. NO.		ILLINOIS FED. AID PROJECT		
* JOHNSON & POPE				

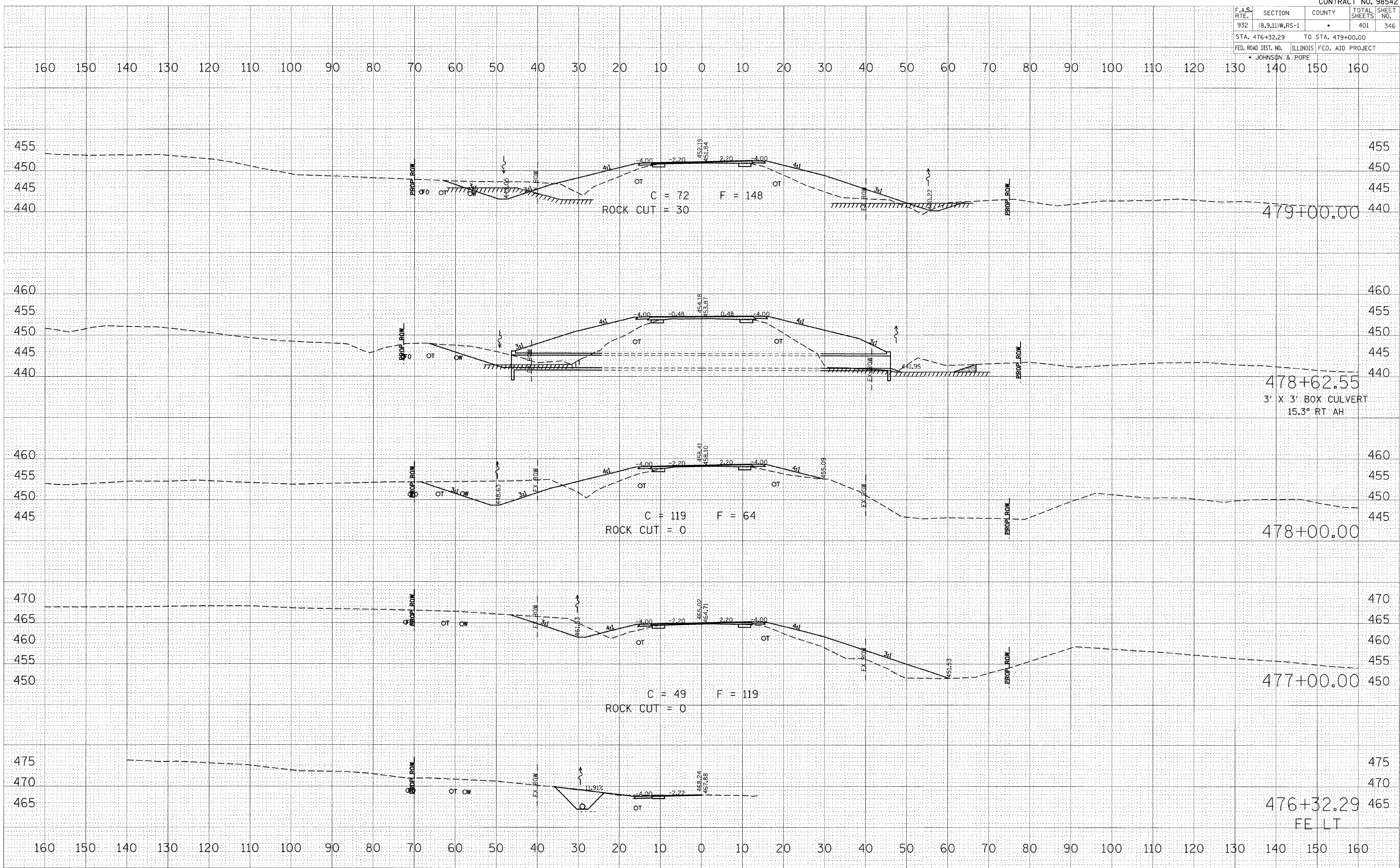

BY	DATE

FINAL SURVEY	SURVEYED

BY	DATE

ORIGINAL SURVEY	SURVEYED

PLOT DATE = #DATE#
PLOT SCALE = #SCALE#
USER NAME = #USER#