

F.A.S. RTE.	SECTION	COUNTY	TOTAL SHEETS	SHEET NO.
932	(8,9,11)W,RS-1	*	401	347
STA. 480+00.00 TO STA. 481+94.53				
FED. ROAD DIST. NO. ILLINOIS FED. AID PROJECT				
* JOHNSON & POPE				

DATE	
BY	
FINAL SURVEY	
SURVEYED	
PLOTTED	
TEMPLATE	
NOTE BOOK	
AREAS CHECKED	
NO.	

DATE	
BY	
ORIGINAL SURVEY	
SURVEYED	
PLOTTED	
TEMPLATE	
NOTE BOOK	
AREAS CHECKED	
NO.	

DATE	
BY	
ORIGINAL SURVEY	
SURVEYED	
PLOTTED	
TEMPLATE	
NOTE BOOK	
AREAS CHECKED	
NO.	

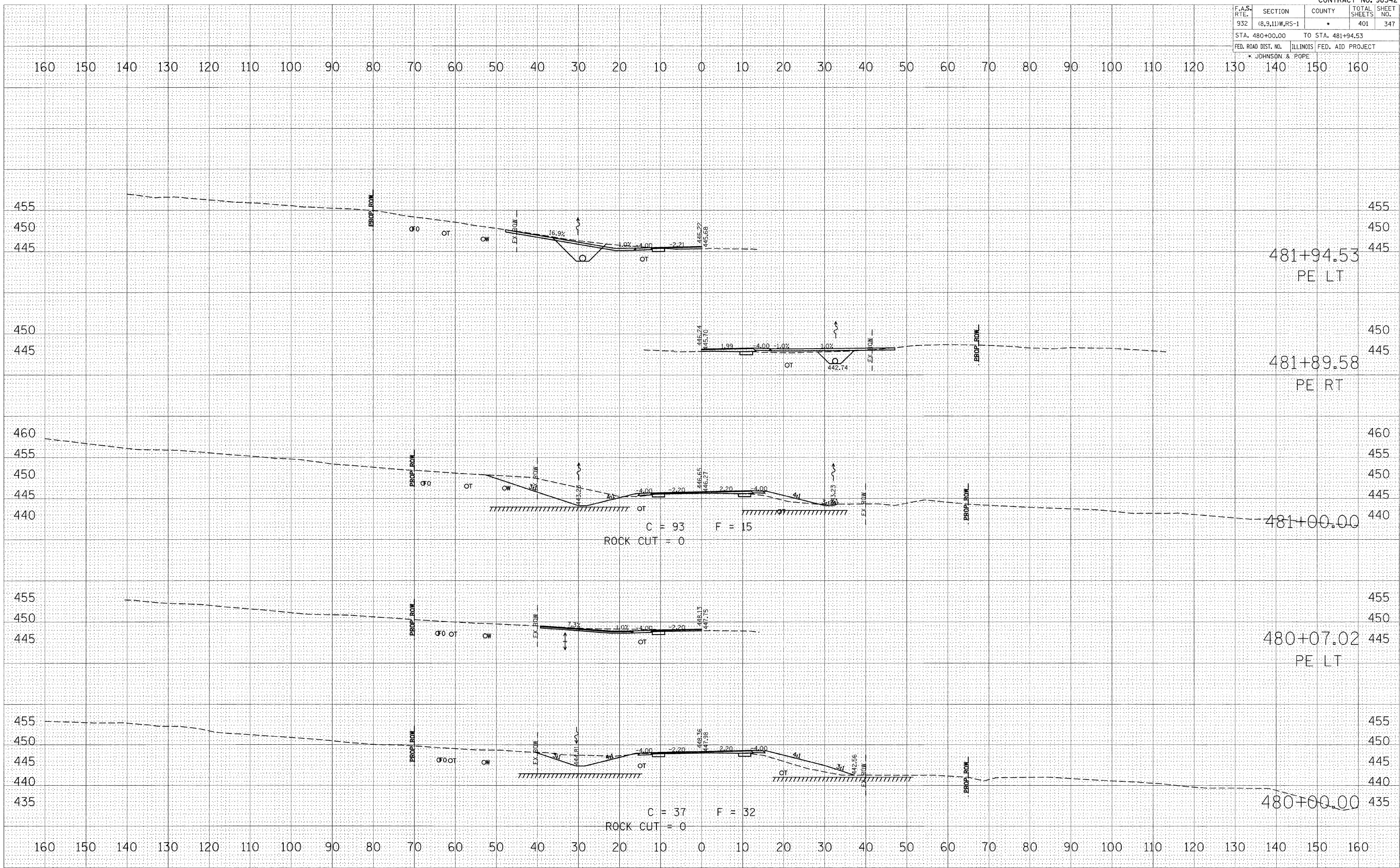

481+94.53
PE LT

481+89.58
PE RT

481+00.00

480+07.02
PE LT

480+00.00

C = 93 F = 15
ROCK CUT = 0

C = 37 F = 32
ROCK CUT = 0