

F.A.S. RTE.	SECTION	COUNTY	TOTAL SHEETS	SHEET NO.
932	(8,9,11)W,RS-1	*	401	360
STA. 527+00.00		TO STA. 530+00.00		
FED. ROAD DIST. NO.		ILLINOIS FED. AID PROJECT		
* JOHNSON & POPE				

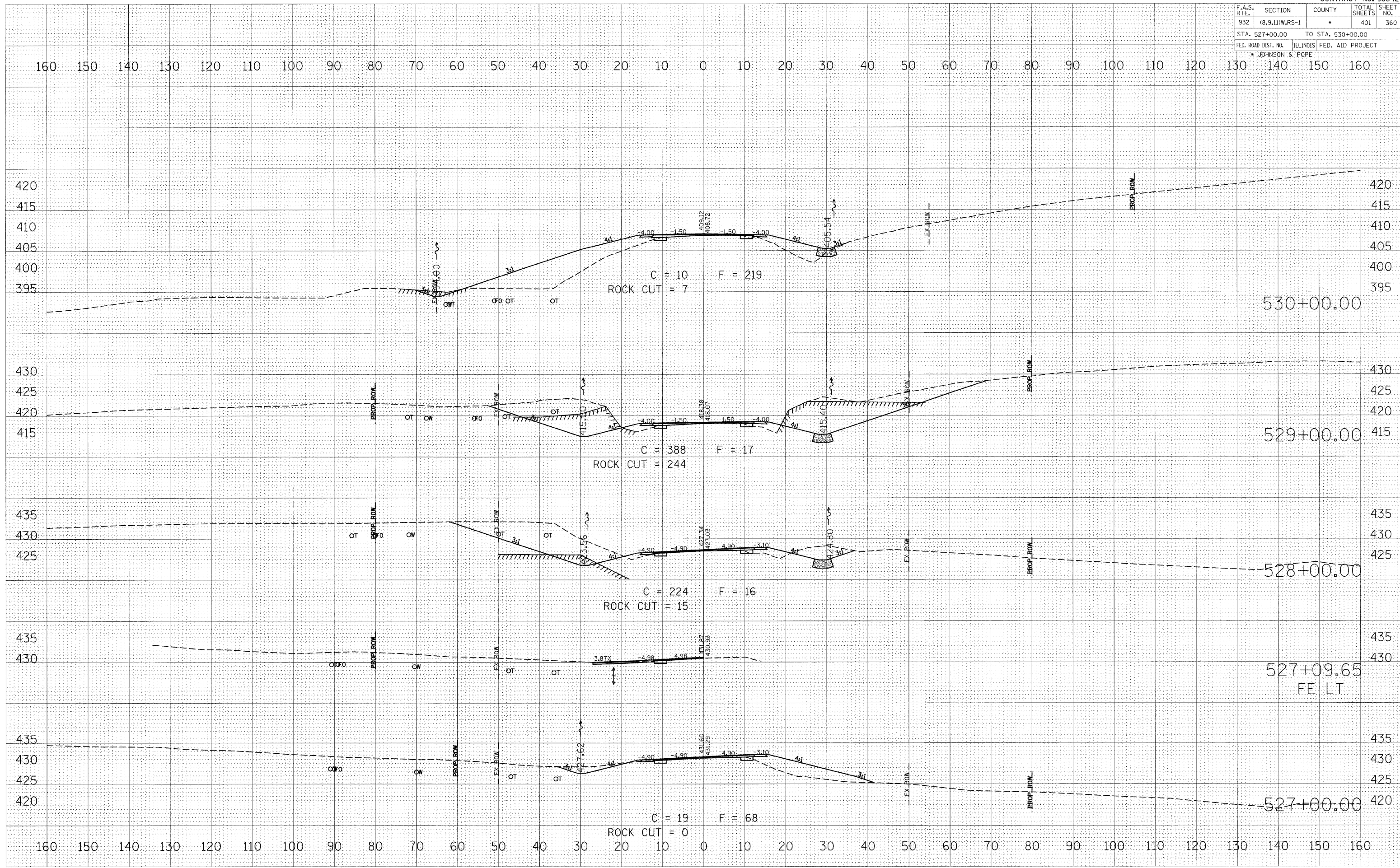

FINAL SURVEY	SURVEYED	DATE
NOTE BOOK	PLOTTED	BY
AREAS CHECKED	TEMPLATE	
NO.	AREAS CHECKED	

ORIGINAL SURVEY	SURVEYED	DATE
NOTE BOOK	PLOTTED	BY
AREAS CHECKED	TEMPLATE	
NO.	AREAS CHECKED	

PLOT DATE \* DATE \*  
 FILE NAME \* FILE \*  
 PLOT SCALE \* SCALES \*  
 USER NAME \* USER \*