

F.A.S. RTE.	SECTION	COUNTY	TOTAL SHEETS	SHEET NO.
932	(8,9,11)W,RS-1	*	401	362
STA. 533+78.80 TO STA. 536+00.00				
FED. ROAD DIST. NO. ILLINOIS FED. AID PROJECT				
* JOHNSON & POPE				

BY	DATE

FINAL SURVEY	SURVEYED	PLOTTED	TEMPLATE	NO. BOOK	AREAS CHECKED

BY	DATE

ORIGINAL SURVEY	SURVEYED	PLOTTED	TEMPLATE	NO. BOOK	AREAS CHECKED

PLOT DATE = #DATE#
 PLOT SCALE = #SCALE#
 USER NAME = #USER#

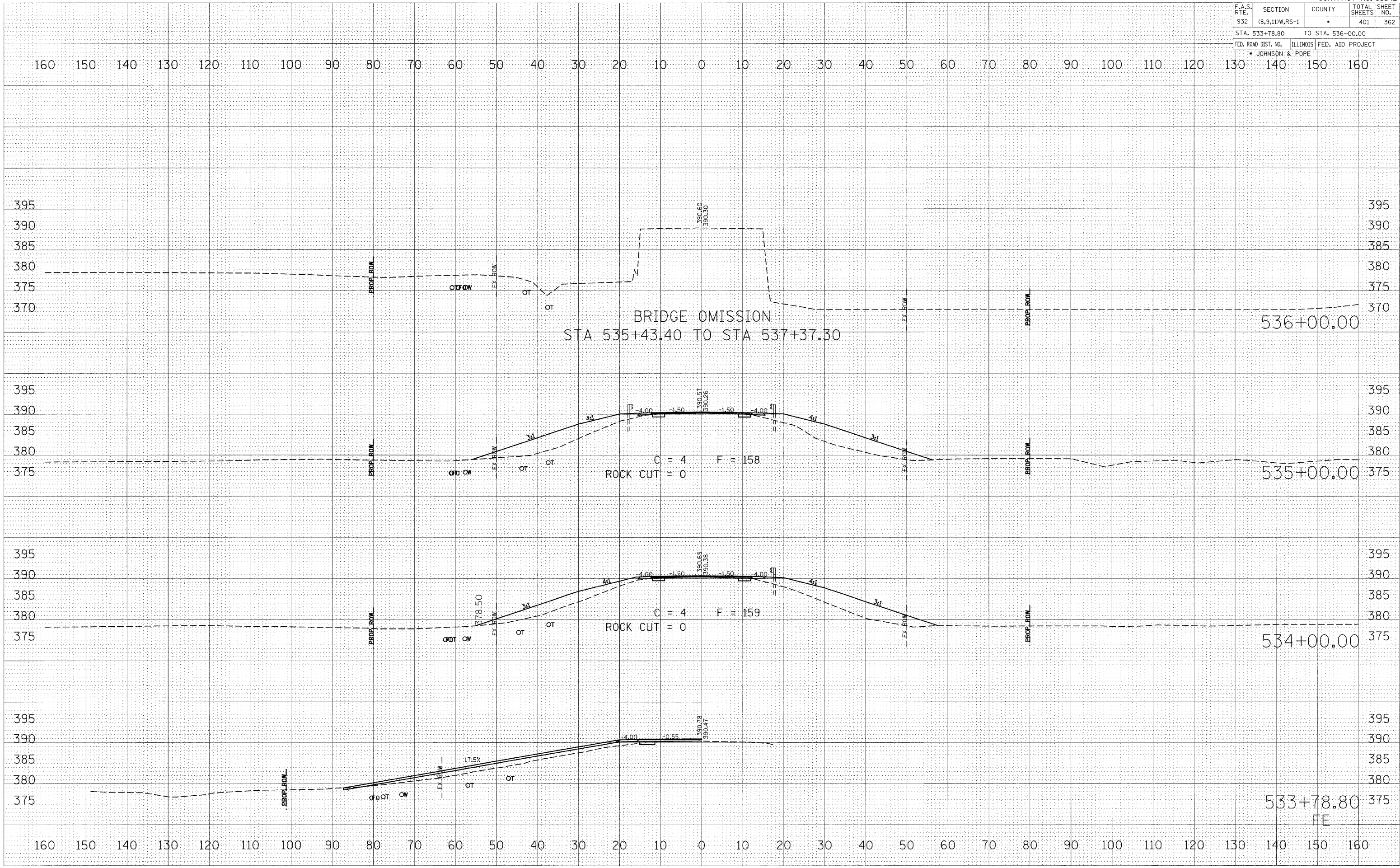

160 150 140 130 120 110 100 90 80 70 60 50 40 30 20 10 0 10 20 30 40 50 60 70 80 90 100 110 120 130 140 150 160

395
390
385
380
375
370

395
390
385
380
375

395
390
385
380
375

395
390
385
380
375

160 150 140 130 120 110 100 90 80 70 60 50 40 30 20 10 0 10 20 30 40 50 60 70 80 90 100 110 120 130 140 150 160

536+00.00

535+00.00

534+00.00

533+78.80
FE