

F.A.S. RTE.	SECTION	COUNTY	TOTAL SHEETS	SHEET NO.
932	(8,9,11)W,RS-1		401	398
STA. 664+00.00 TO STA. 666+10.89				
FED. ROAD DIST. NO. ILLINOIS FED. AID PROJECT				
* JOHNSON & POPE				

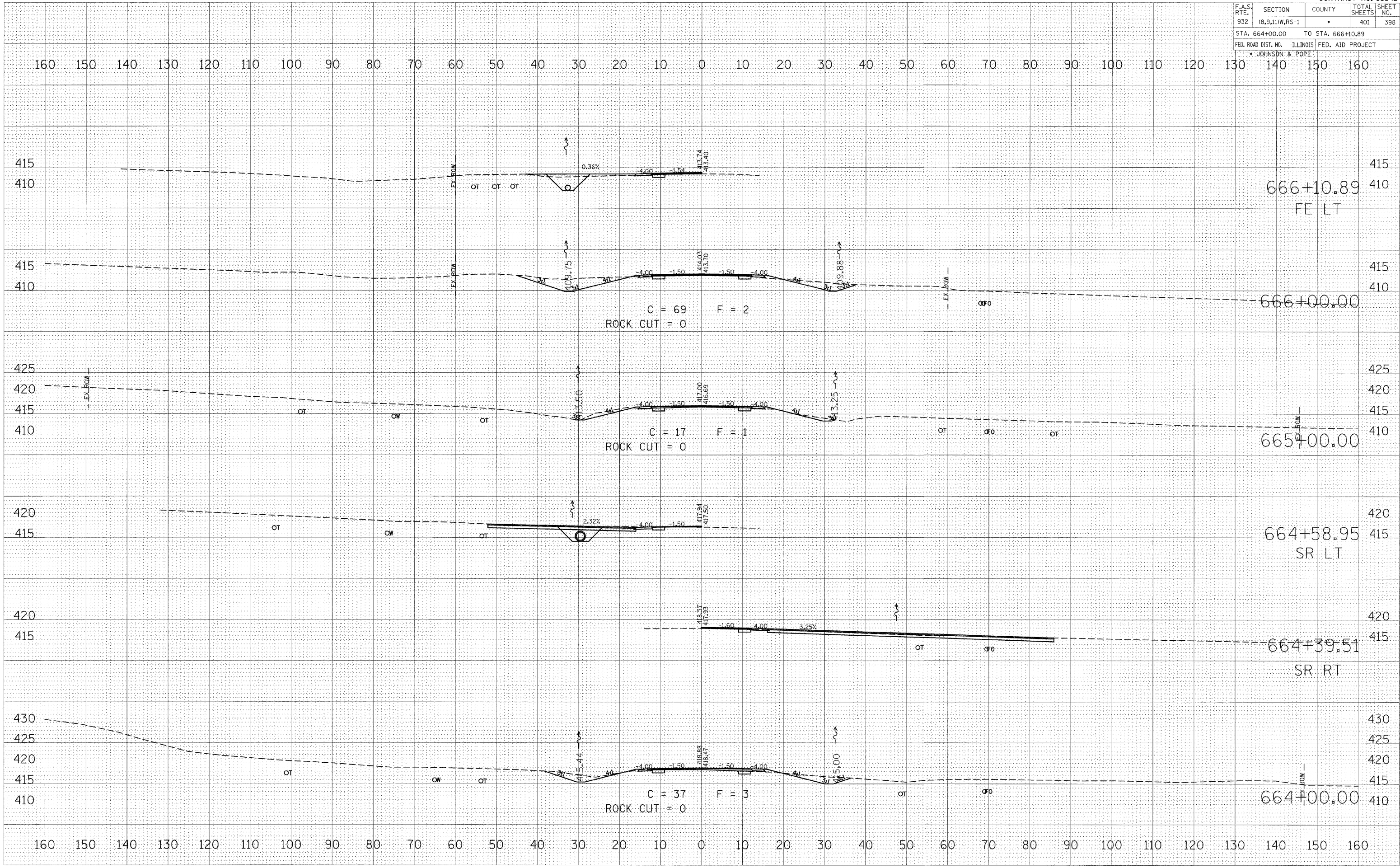

BY	DATE

FINAL SURVEY	SUPERVISED	PLOTTED	TEMPLATE	NO. BOOK	AREAS CHECKED

BY	DATE

ORIGINAL SURVEY	SUPERVISED	PLOTTED	TEMPLATE	NO. BOOK	AREAS CHECKED

PLOT DATE = @DATE\*  
 PLOT SCALE = @SCALE\*  
 USER NAME = @USER\*