

WH007



CRAWFORD, MURPHY & TILLY, INC.
CONSULTING ENGINEERS
© Copyright CMT, Inc.

Whiteside County **AIRPORT**
JOSEPH H. BITTORF FIELD

Whiteside County
Airport

Sterling / Rock Falls,
Illinois

Whiteside County
Airport

AIP: 3-17-0098-B14
SQI-3830

REHABILITATE
TAXIWAY EDGE
LIGHTS (PARALLEL
/ CONNECTING
TAXIWAYS A AND E
EAST OF RUNWAY
18/36)

Revisions

No.	Date	Description

0 1
THIS BAR IS EQUAL TO 1"
AT FULL SCALE (17 X 11).

DESIGN BY: CMT- RFD
 DRAWN BY: CMT- RFD
 CHECKED BY: CMT- RFD
 APPROVED BY: JGP
 DATE: 7.25.2008
 JOB No: 08292-04-00

**SITE PLAN
(ETP1)**

08

SHEET 08 OF 15 SHEETS

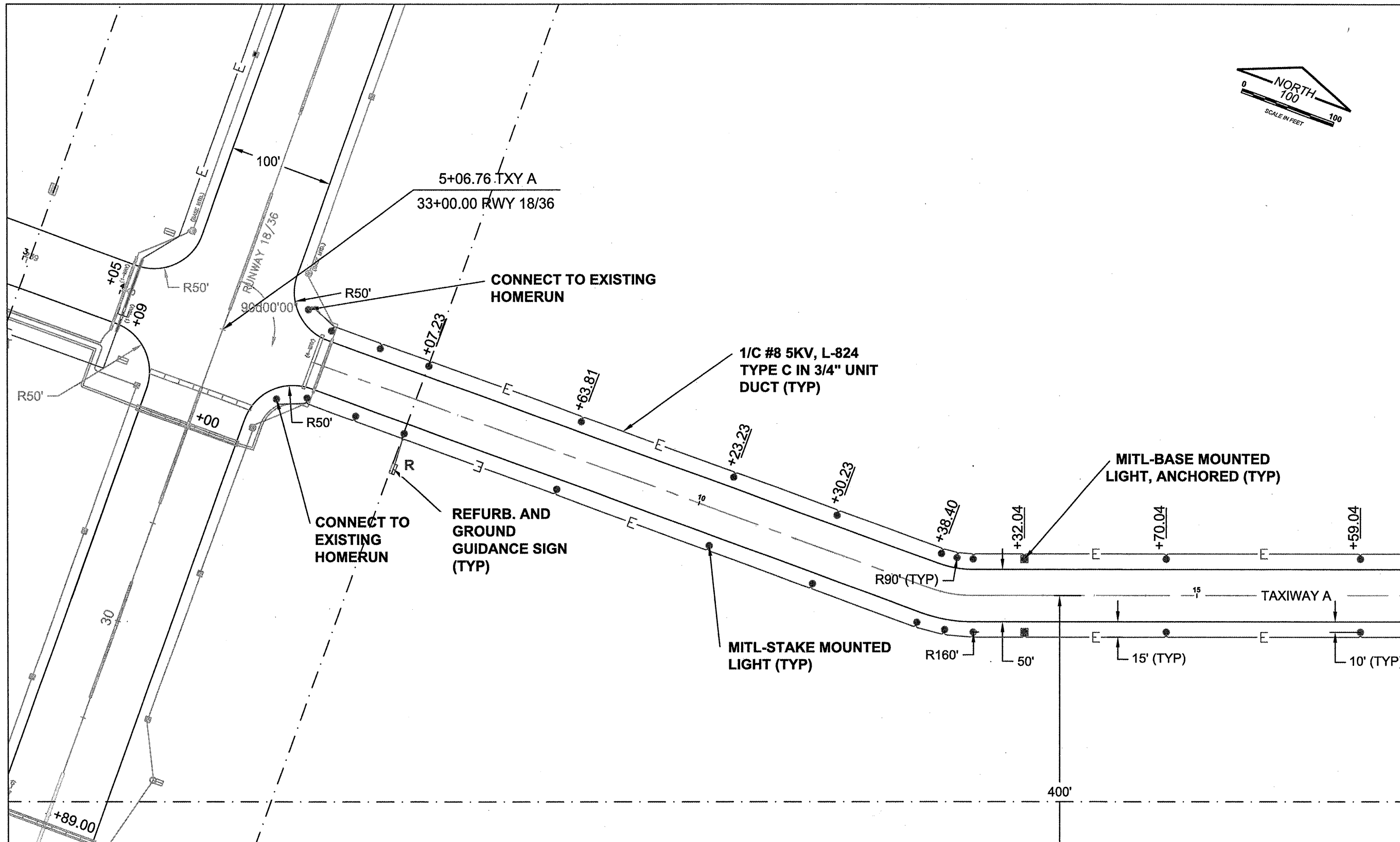
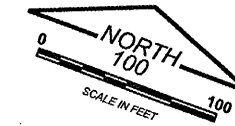

LEGEND

- NEW 1/C #8, L-824 TYPE C 5KV CABLE IN UNIT DUCT
- EXIST. 1/C 5KV CABLE
- NEW MITL - BASE MOUNTED LIGHT / ANCHORED
- NEW DUCT (NO. OF WAYS SHOWN)
- EXIST. DUCT (NO. OF WAYS SHOWN)
- NEW MITL - STAKE MOUNTED LIGHT
- EXIST. GUIDANCE SIGN TO BE REFURBISHED AND GROUNDED

**ELECTRICAL PLAN 1
TAXIWAY A**