

EXISTING ELEVATION OF LEFT OR RIGHT SIGN STRUCTURE FOUNDATION

Cut & Remove 6 Anchor Rods each end.

Provide one Coupling Nut (Coupler) for each New Anchor Rod.

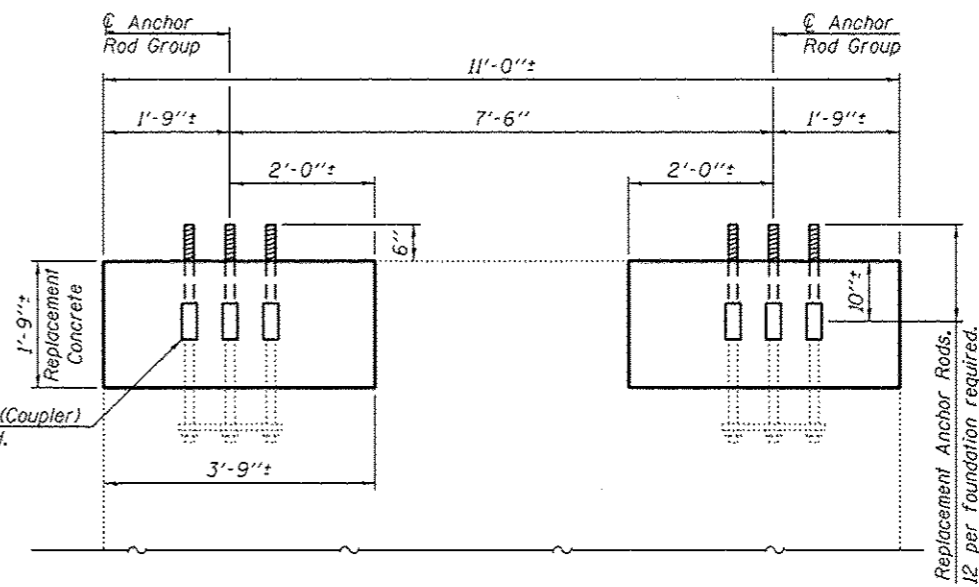

PROPOSED ELEVATION OF LEFT OR RIGHT SIGN STRUCTURE FOUNDATION

Replacement Anchor Rods. 12 per foundation required.

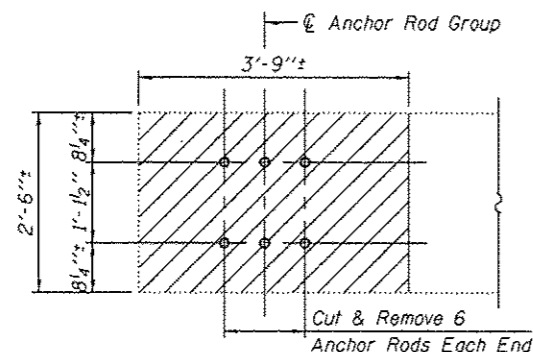

VIEW A-A

Cut & Remove 6 Anchor Rods Each End

LEGEND

- Indicates Concrete Removal.
- Indicates Existing Structure.

NOTES

1. It shall be the Contractor's responsibility to verify all dimensions and conditions existing in the field prior to construction and ordering materials.
2. Existing reinforcement bars are not shown (for clarity).
3. Existing anchor rods are 1 1/8" diameter.
4. Saw Cut 1" deep on the perimeter of Concrete Removal. Care shall be exercised to prevent damage to existing reinforcement bars. See Special Provisions.
5. The work is paid for as REBUILD CONCRETE FOUNDATION FOR OVERHEAD SIGN STRUCTURES.

H:\pds\2011\20110302-44\CAD\Site\00\046291-s08scom-fdnr-ep.dgn 8/1/2013 3:51:04 PM

USER NAME =	DESIGNED -	REVISED
	CHECKED -	REVISED
PLOT SCALE =	DRAWN - 08/01/2013	REVISED
PLOT DATE =	CHECKED -	REVISED

F.A. RTE.	SECTION	COUNTY	TOTAL SHEETS	SHEET NO.
VAR. 101 OVD SIN STR REPL14-30		VARIOUS	47	17
CONTRACT NO. 46291			ILLINOIS FED. AID PROJECT	