

MATCH LINE STA 350+00 EB I-290

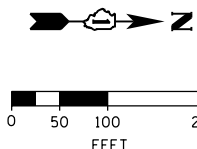

NOTE: SEE SHEET 47 FOR STATION EQUATIONS.

MATCH LINE STA 5+00 NB I-90/94

MATCH LINE STA 35+00 NB I-90/94

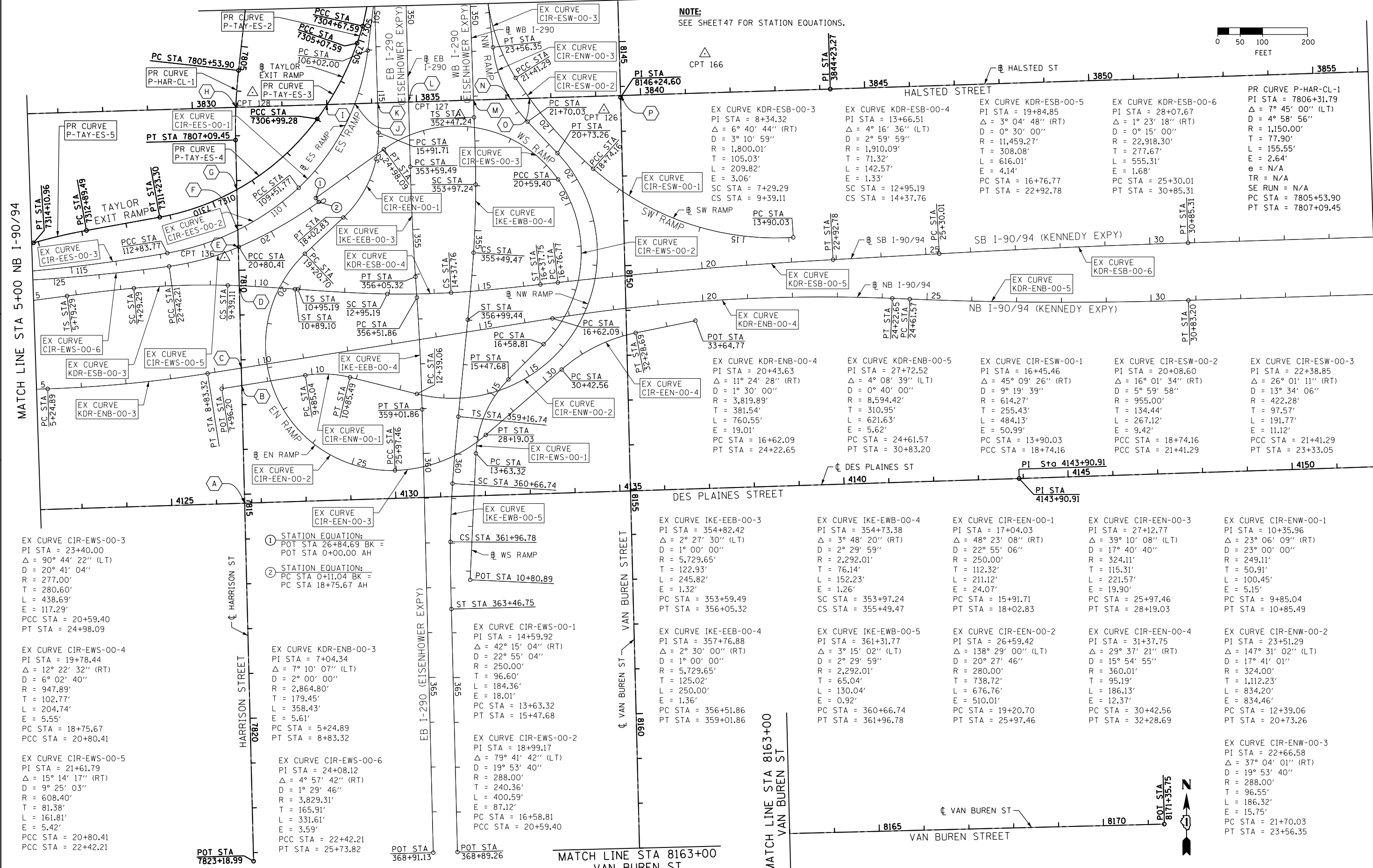

EX CURVE CIR-EWS-00-3
PI STA = 23+40.00
Δ = 90° 44' 22" (LT)
D = 20' 41' 04"
R = 277.00'
T = 280.60'
L = 438.69'
E = 117.29'
PCC STA = 20+59.40
PT STA = 24+98.09

EX CURVE CIR-EWS-00-4
PI STA = 19+78.44
Δ = 12° 22' 32" (RT)
D = 6° 02' 40"
R = 947.89'
T = 102.77'
L = 204.74'
E = 5.55'
PC STA = 18+75.67
PCC STA = 20+80.41

EX CURVE CIR-EWS-00-5
PI STA = 21+61.79
Δ = 15° 14' 17" (RT)
D = 9° 25' 03"
R = 608.40'
T = 81.38'
L = 161.81'
E = 5.42'
PCC STA = 20+80.41
PT STA = 22+42.21

① STATION EQUATION:
POT STA 26+84.69 BK =
POT STA 0+00.00 AH

② STATION EQUATION:
PC STA 0+11.04 BK =
PC STA 18+75.67 AH

EX CURVE KDR-ENB-00-3
PI STA = 7+04.34
Δ = 7° 10' 07" (LT)
D = 2° 00' 00"
R = 2,864.80'
T = 179.45'
L = 358.43'
E = 5.61'
PC STA = 5+24.89
PT STA = 8+83.32

EX CURVE CIR-EWS-00-6
PI STA = 24+08.12
Δ = 4° 57' 42" (RT)
D = 1° 29' 46"
R = 3,829.31'
T = 165.91'
L = 331.61'
E = 3.59'
PCC STA = 22+42.21
PT STA = 25+73.82

EX CURVE CIR-EWS-00-1
PI STA = 14+59.92
Δ = 42° 15' 04" (RT)
D = 22° 55' 04"
R = 250.00'
T = 96.60'
L = 184.36'
E = 18.01'
PC STA = 13+63.32
PT STA = 15+47.68

EX CURVE CIR-EWS-00-2
PI STA = 18+99.17
Δ = 79° 41' 42" (LT)
D = 19° 53' 40"
R = 288.00'
T = 240.36'
L = 400.59'
E = 87.12'
PC STA = 16+58.81
PCC STA = 20+59.40

EX CURVE IKE-EEB-00-3
PI STA = 354+82.42
Δ = 2° 27' 30" (LT)
D = 1° 00' 00"
R = 5,729.65'
T = 122.93'
L = 245.82'
E = 1.32'
PC STA = 353+59.49
PT STA = 356+05.32

EX CURVE IKE-EEB-00-4
PI STA = 357+76.88
Δ = 2° 30' 00" (RT)
D = 1° 00' 00"
R = 5,729.65'
T = 125.02'
L = 250.00'
E = 1.36'
PC STA = 356+51.86
PT STA = 359+01.86

EX CURVE KDR-ENB-00-4
PI STA = 20+43.63
Δ = 11° 24' 28" (RT)
D = 1° 30' 00"
R = 3,819.89'
T = 381.54'
L = 760.55'
E = 19.01'
PC STA = 16+62.09
PT STA = 24+22.65

EX CURVE KDR-ENB-00-5
PI STA = 27+72.52
Δ = 4° 08' 39" (LT)
D = 2° 29' 59"
R = 2,292.01'
T = 76.14'
L = 152.23'
E = 1.26'
PC STA = 24+61.57
PT STA = 30+83.20

EX CURVE CIR-EEN-00-1
PI STA = 17+04.03
Δ = 48° 23' 08" (RT)
D = 22° 55' 06"
R = 250.00'
T = 112.32'
L = 211.12'
E = 24.07'
PC STA = 15+91.71
PT STA = 18+02.83

EX CURVE CIR-EEN-00-2
PI STA = 26+59.42
Δ = 138° 29' 00" (LT)
D = 20° 27' 46"
R = 280.00'
T = 738.72'
L = 676.76'
E = 510.01'
PC STA = 19+20.70
PT STA = 25+97.46

EX CURVE CIR-EEN-00-3
PI STA = 27+12.77
Δ = 39° 10' 08" (LT)
D = 17° 40' 40"
R = 324.11'
T = 115.31'
L = 221.57'
E = 19.90'
PC STA = 25+97.46
PT STA = 28+19.03

EX CURVE CIR-EEN-00-4
PI STA = 31+37.75
Δ = 29° 37' 21" (RT)
D = 15° 54' 55"
R = 360.01'
T = 95.19'
L = 186.13'
E = 12.37'
PC STA = 30+42.56
PT STA = 32+28.69

EX CURVE CIR-ENW-00-1
PI STA = 10+35.96
Δ = 23° 06' 09" (RT)
D = 23° 00' 00"
R = 249.11'
T = 50.91'
L = 100.45'
E = 5.15'
PC STA = 9+85.04
PT STA = 10+85.49

EX CURVE CIR-ENW-00-2
PI STA = 23+51.29
Δ = 147° 31' 02" (LT)
D = 17° 41' 01"
R = 324.00'
T = 1,112.23'
L = 834.20'
E = 834.46'
PC STA = 12+39.06
PT STA = 20+73.26

EX CURVE CIR-ENW-00-3
PI STA = 22+66.58
Δ = 37° 04' 01" (RT)
D = 19° 53' 40"
R = 288.00'
T = 96.55'
L = 186.32'
E = 15.75'
PC STA = 21+70.03
PT STA = 23+56.35

STATE OF ILLINOIS
DEPARTMENT OF TRANSPORTATION

ALIGNMENT, TIES AND BENCHMARKS
SCALE: 1" = 100' SHEET 2 OF 6 SHEETS STA. TO STA.

F.A.I. RE.	SECTION	COUNTY	TOTAL SHEETS	SHEET NO.
90/94/290	2013-008R	COOK	559	45
CONTRACT NO. 60W26				
ILLINOIS FED. AID PROJECT				



D:\60W26-Sht-ATB-02.dgn
USER NAME = chhua
PLOT SCALE = 100.0000' / in.
PLOT DATE = 9/12/2013

DESIGNED - JLV
DRAWN - BAW
CHECKED - JMG
DATE - 9/15/13

REVISED -
REVISED -
REVISED -
REVISED -