

PR VAN BUREN STREET

POINT	DESCRIPTION	STATION	NORTHING	EASTING
POT		8100+00.00	1, 898, 259.3220	1, 166, 490.9835
PI		8125+63.42	1, 898, 338.2206	1, 169, 053.1845
PI		8146+24.60	1, 898, 397.0221	1, 171, 113.5263
POT		8171+35.75	1, 898, 460.2841	1, 173, 623.8877

EX NB I-90/94 (KENNEDY EXPY)

POINT	DESCRIPTION	STATION	NORTHING	EASTING
POT		183+13.36	1, 894, 228.6347	1, 171, 899.8969
PC	KDR-ENB-00-1	190+77.41	1, 894, 992.2698	1, 171, 874.5496
PI	KDR-ENB-00-1	192+81.92	1, 895, 196.6626	1, 171, 867.7651
PT	KDR-ENB-00-1	194+86.31	1, 895, 400.3262	1, 171, 849.2283
PC	KDR-ENB-00-2	196+49.74	1, 895, 563.0812	1, 171, 834.4148
PI	KDR-ENB-00-2	199+68.51	1, 895, 880.5418	1, 171, 805.5204
PT	KDR-ENB-00-2	202+87.12	1, 896, 199.1177	1, 171, 794.3177
POT	209+89.95 BK, 3+06.94 AH		1, 896, 901.5590	1, 171, 770.9004
PC	KDR-ENB-00-3	5+24.89	1, 897, 119.3934	1, 171, 763.6385
PI	KDR-ENB-00-3	7+04.34	1, 897, 298.7419	1, 171, 757.6595
PT	KDR-ENB-00-3	8+83.32	1, 897, 475.9425	1, 171, 729.3467
PC	KDR-ENB-00-4	16+62.09	1, 898, 244.9598	1, 171, 606.4743
PI	KDR-ENB-00-4	20+43.63	1, 898, 621.7192	1, 171, 546.2763
PT	KDR-ENB-00-4	24+22.65	1, 899, 002.9421	1, 171, 561.7870
PC	KDR-ENB-00-5	24+61.57	1, 899, 041.8342	1, 171, 563.3694
PI	KDR-ENB-00-5	27+72.52	1, 899, 352.5300	1, 171, 576.0107
PT	KDR-ENB-00-5	30+83.20	1, 899, 663.3270	1, 171, 566.1658
POT		45+35.14	1, 901, 114.5368	1, 171, 520.1970

EX EB I-290 (EISENHOWER EXPY)

POINT	DESCRIPTION	STATION	NORTHING	EASTING
POT		293+88.84	1, 897, 910.7311	1, 165, 300.7513
PC	IKE-EEB-00-1	314+72.13	1, 897, 974.3410	1, 167, 383.0682
PI	IKE-EEB-00-1	321+86.75	1, 897, 996.1608	1, 168, 097.3549
PT	IKE-EEB-00-1	329+00.55	1, 897, 958.6150	1, 168, 810.9878
PC	IKE-EEB-00-2	339+78.49	1, 897, 901.9806	1, 169, 887.4363
PI	IKE-EEB-00-2	341+00.95	1, 897, 895.5464	1, 170, 009.7311
PT	IKE-EEB-00-2	342+23.29	1, 897, 898.7017	1, 170, 132.1545
POT		344+82.35	1, 897, 905.3762	1, 170, 391.1241
PC	IKE-EEB-00-3	353+59.49	1, 897, 927.9756	1, 171, 267.9805
PI	IKE-EEB-00-3	354+82.42	1, 897, 931.1429	1, 171, 390.8707
PT	IKE-EEB-00-3	356+05.32	1, 897, 939.5781	1, 171, 513.5119
PC	IKE-EEB-00-4	356+51.86	1, 897, 942.7715	1, 171, 559.9401
PI	IKE-EEB-00-4	357+76.88	1, 897, 951.3501	1, 171, 684.6669
PT	IKE-EEB-00-4	359+01.86	1, 897, 954.4801	1, 171, 809.6491
POT		368+91.13	1, 897, 979.2472	1, 172, 798.6113

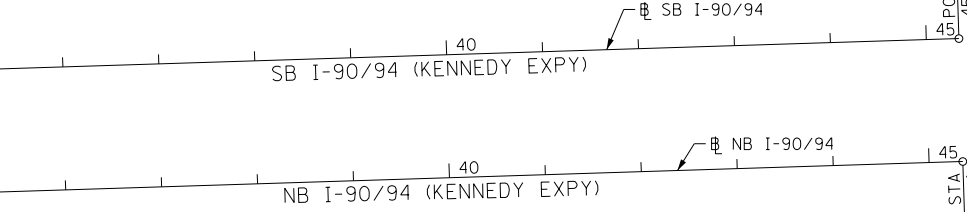

PR HALSTED STREET

POINT	DESCRIPTION	STATION	NORTHING	EASTING
POT		3800+00.00	1, 894, 443.3678	1, 171, 230.8570
PI		3844+23.27	1, 898, 864.5442	1, 171, 094.8299
PI		3858+25.74	1, 900, 266.2756	1, 171, 049.3238
PI		3872+37.11	1, 901, 677.0451	1, 171, 008.1349
PI		3876+85.98	1, 902, 125.8500	1, 171, 000.3999
POT		3879+94.35	1, 902, 434.0036	1, 170, 988.7426

PR HARRISON STREET

POINT	DESCRIPTION	STATION	NORTHING	EASTING
POT		7798+00.00	1, 897, 559.2104	1, 170, 301.2209
PI		7802+87.02	1, 897, 574.4743	1, 170, 788.0041
PC	P-HAR-CL-1	7805+53.90	1, 897, 545.0894	1, 171, 053.2542
PI	P-HAR-CL-1	7806+31.79	1, 897, 536.5125	1, 171, 130.6756
PT	P-HAR-CL-1	7807+09.45	1, 897, 538.4543	1, 171, 208.5464
POT		7823+18.99	1, 897, 578.5778	1, 172, 817.5931

PR DES PLAINES STREET

POINT	DESCRIPTION	STATION	NORTHING	EASTING
POT		4100+00.00	1, 894, 897.3602	1, 172, 103.4101
PI		4143+90.91	1, 899, 286.0495	1, 171, 963.8051
PI		4154+01.70	1, 900, 296.2890	1, 171, 930.4175
PI		4168+05.05	1, 901, 698.9691	1, 171, 887.2201
POT		4174+11.29	1, 902, 304.9557	1, 171, 869.4907

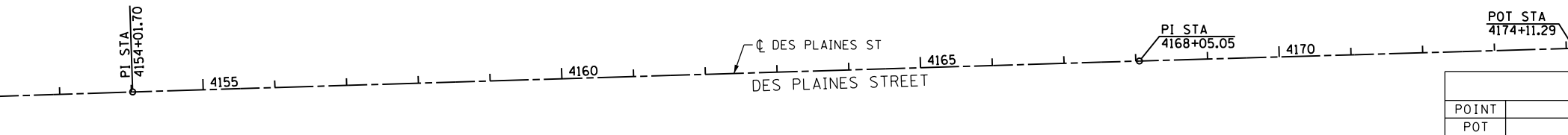

EX SB I-90/94 (KENNEDY EXPY)

POINT	DESCRIPTION	STATION	NORTHING	EASTING
POT		183+13.36	1, 894, 226.7720	1, 171, 843.7613
PC	KDR-ESB-00-1	185+50.30	1, 894, 463.5855	1, 171, 835.9008
PI	KDR-ESB-00-1	186+12.11	1, 894, 525.3637	1, 171, 833.8503
PT	KDR-ESB-00-1	186+73.92	1, 894, 587.1007	1, 171, 830.8004
PC	KDR-ESB-00-2	186+73.95	1, 894, 587.1274	1, 171, 830.7991
PI	KDR-ESB-00-2	194+46.34	1, 895, 358.5739	1, 171, 792.6885
PT	KDR-ESB-00-2	202+17.88	1, 896, 124.4241	1, 171, 692.4111
POT	209+97.19 BK, 3+11.60 AH		1, 896, 897.1317	1, 171, 591.2358
TS	KDR-ESB-00-3B	5+79.29	1, 897, 162.5525	1, 171, 556.4826
PIS	KDR-ESB-00-3B	6+79.30	1, 897, 261.7152	1, 171, 543.4986
SC	KDR-ESB-00-3	7+29.29	1, 897, 311.5276	1, 171, 539.0772
PI	KDR-ESB-00-3	8+34.32	1, 897, 416.1453	1, 171, 529.7912
CS	KDR-ESB-00-3	9+39.11	1, 897, 521.1330	1, 171, 532.7356
PIS	KDR-ESB-00-3A	9+89.11	1, 897, 571.1183	1, 171, 534.1374
ST	KDR-ESB-00-3A	10+89.10	1, 897, 670.8779	1, 171, 541.1020
TS	KDR-ESB-00-4B	10+95.19	1, 897, 676.9607	1, 171, 541.5267
PIS	KDR-ESB-00-4B	12+28.55	1, 897, 809.9894	1, 171, 550.8139
SC	KDR-ESB-00-4	12+95.19	1, 897, 876.6634	1, 171, 551.9707
PI	KDR-ESB-00-4	13+66.51	1, 897, 947.9712	1, 171, 553.2078
CS	KDR-ESB-00-4	14+37.76	1, 898, 019.1728	1, 171, 549.1239
PIS	KDR-ESB-00-4A	15+04.45	1, 898, 085.7441	1, 171, 545.3056
ST	KDR-ESB-00-4A	16+37.75	1, 898, 218.2892	1, 171, 530.7143
PC	KDR-ESB-00-5	16+76.77	1, 898, 257.0735	1, 171, 526.4446
PI	KDR-ESB-00-5	19+84.85	1, 898, 563.3008	1, 171, 492.7332
PT	KDR-ESB-00-5	22+92.78	1, 898, 870.8971	1, 171, 475.5242
PC	KDR-ESB-00-6	25+30.01	1, 899, 107.7534	1, 171, 462.2729
PI	KDR-ESB-00-6	28+07.67	1, 899, 384.9870	1, 171, 446.7626
PT	KDR-ESB-00-6	30+85.31	1, 899, 662.5150	1, 171, 437.9735
POT		45+34.00	1, 901, 110.4797	1, 171, 392.1175

EX WB I-290 (EISENHOWER EXPY)

POINT	DESCRIPTION	STATION	NORTHING	EASTING
POT		293+90.95	1, 898, 109.2305	1, 165, 314.6967
TS	IKE-EWB-00-1B	322+24.26	1, 898, 195.6075	1, 168, 146.6931
PIS	IKE-EWB-00-1B	323+57.62	1, 898, 199.6729	1, 168, 279.9836
SC	IKE-EWB-00-1	324+24.26	1, 898, 198.2148	1, 168, 346.6517
PI	IKE-EWB-00-1	325+38.06	1, 898, 195.7265	1, 168, 460.4198
CS	IKE-EWB-00-1	326+51.59	1, 898, 179.7466	1, 168, 573.0875
PIS	IKE-EWB-00-1A	327+18.26	1, 898, 170.3839	1, 168, 639.1010
ST	IKE-EWB-00-1A	328+51.56	1, 898, 144.7784	1, 168, 769.9517
TS	IKE-EWB-00-2B	329+78.32	1, 898, 120.4341	1, 168, 894.3575
PIS	IKE-EWB-00-2B	331+11.67	1, 898, 094.8247	1, 169, 025.2278
SC	IKE-EWB-00-2	331+78.32	1, 898, 085.4611	1, 169, 091.2512
PI	IKE-EWB-00-2	332+11.06	1, 898, 080.8638	1, 169, 123.6666
CS	IKE-EWB-00-2	332+43.79	1, 898, 077.3803	1, 169, 156.2204
PIS	IKE-EWB-00-2A	333+10.47	1, 898, 070.2861	1, 169, 222.5160
ST	IKE-EWB-00-2A	334+43.76	1, 898, 063.0562	1, 169, 355.6523
PC	IKE-EWB-00-3	338+11.32	1, 898, 043.1252	1, 169, 722.6716
PI	IKE-EWB-00-3	340+66.38	1, 898, 029.2947	1, 169, 977.3536
PT	IKE-EWB-00-3	343+21.10	1, 898, 038.1489	1, 170, 232.2572
TS	IKE-EWB-00-4B	352+47.24	1, 898, 070.2993	1, 171, 157.8387
PIS	IKE-EWB-00-4B	353+47.25	1, 898, 073.7709	1, 171, 257.7841
SC	IKE-EWB-00-4	353+97.24	1, 898, 073.8709	1, 171, 307.7891
PI	IKE-EWB-00-4	354+73.38	1, 898, 074.0231	1, 171, 383.9319
CS	IKE-EWB-00-4	355+49.47	1, 898, 069.1215	1, 171, 459.9169
PIS	IKE-EWB-00-4A	355+99.47	1, 898, 065.9031	1, 171, 509.8083
ST	IKE-EWB-00-4A	356+99.44	1, 898, 056.2063	1, 171, 609.3226
TS	IKE-EWB-00-5B	359+16.74	1, 898, 035.1324	1, 171, 825.5961
PIS	IKE-EWB-00-5B	360+16.74	1, 898, 025.4337	1, 171, 925.1303
SC	IKE-EWB-00-5	360+66.74	1, 898, 022.2149	1, 171, 975.0317
PI	IKE-EWB-00-5	361+31.77	1, 898, 018.0288	1, 172, 039.9323
CS	IKE-EWB-00-5	361+96.78	1, 898, 017.5295	1, 172, 104.9659
PIS	IKE-EWB-00-5A	362+46.77	1, 898, 017.1456	1, 172, 154.9595
ST	IKE-EWB-00-5A	363+46.75	1, 898, 019.6488	1, 172, 254.9138
POT		368+89.26	1, 898, 033.2310	1, 172, 797.2593

EX WS RAMP

POINT	DESCRIPTION	STATION	NORTHING	EASTING
POT		10+80.89	1, 898, 061.5790	1, 172, 189.8288
PC	CIR-EWS-00-1	13+63.32	1, 898, 074.4485	1, 171, 907.6892
PI	CIR-EWS-00-1	14+59.92	1, 898, 078.8501	1, 171, 811.1924
PT	CIR-EWS-00-1	15+47.68	1, 898, 146.9909	1, 171, 742.7246
PC	CIR-EWS-00-2	16+58.81	1, 898, 225.3834	1, 171, 663.9559
PI	CIR-EWS-00-2	18+99.17	1, 898, 394.9331	1, 171, 493.5925
PCC	CIR-EWS-00-2/CIR-EWS-00-3	20+59.40	1, 898, 257.6484	1, 171, 296.3016
PI	CIR-EWS-00-3	23+40.00	1, 898, 097.3780	1, 171, 065.9783
PT	CIR-EWS-00-3	24+98.09	1, 897, 869.1423	1, 171, 229.2078
POT	26+84.69 BK = Sta 0+00.00 AH		1, 897, 717.3617	1, 171, 337.7582
PC	CIR-EWS-00-4, 0+11.04 BK = 18+75.67 AH		1, 897, 723.7342	1, 171, 346.7691
PI	CIR-EWS-00-4	19+78.44	1, 897, 640.1447	1, 171, 406.5568
PCC	CIR-EWS-00-4/CIR-EWS-00-5	20+80.41	1, 897, 545.6837	1, 171, 447.0403
PI	CIR-EWS-00-5	21+61.79	1, 897, 470.8805	1, 171, 479.0990
PCC	CIR-EWS-00-5/C			