

FILE PATH = p:\1\388039-p\m\1\escom\1\me\local\p\wec\000\Documents\01_Americas\Transportation\602629938_Circle\Phase_1\1\000_CAD\006_Roadway\Sheets\60W26-Sht-41B-04.dgn

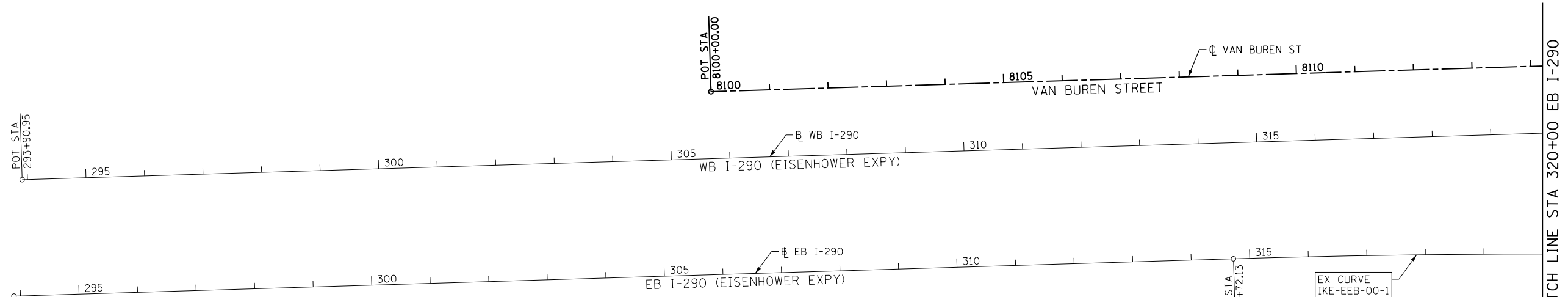

STATION EQUATIONS

POINT	BASELINE	STATION	BASELINE	STATION
A	P-HAR-CL	7815+19.91	P-DES-CL	4126+62.64
B	P-HAR-CL	7812+57.32	E-CIR-NW	8+41.41
C	P-HAR-CL	7812+18.39	E-KDR-NB	9+59.47
D	P-HAR-CL	7810+34.62	E-KDR-SB	9+64.55
E	P-HAR-CL	7809+48.56	E-CIR-WS	20+81.79
F	P-HAR-CL	7809+10.10	E-CIR-ES	111+17.64
G	P-HAR-CL	7808+20.16	P-TAY-ES	7309+39.95
H	P-HAL-CL	3830+97.05	P-HAR-CL	7806+36.50
I	P-HAL-CL	3833+00.79	P-TAY-ES	7306+60.31
J	P-HAL-CL	3833+62.49	E-CIR-ES	107+24.52

POINT	BASELINE	STATION	BASELINE	STATION
K	P-HAL-CL	3834+13.40	E-CIR-EN	15+25.58
L	P-HAL-CL	3834+82.54	E-IKE-EB	352+15.22
M	P-HAL-CL	3836+27.31	E-IKE-WB	352+08.69
N	P-HAL-CL	3837+09.52	E-CIR-NW	22+33.87
O	P-HAL-CL	3837+52.33	E-CIR-SW	20+86.30
P	P-HAL-CL	3839+55.40	P-VAN-CL	8146+20.29

NOTE:
SEE SHEET 45 FOR STATION EQUATION LOCATION REFERENCE.

EX CURVE IKE-EEB-00-1
 PI STA = 321+86.75
 $\Delta = 4^\circ 45' 41''$ (RT)
 $D = 0^\circ 20' 00''$
 $R = 17,188.74'$
 $T = 714.62'$
 $L = 1,428.42'$
 $E = 14.85'$
 PC STA = 314+72.13
 PT STA = 329+00.55

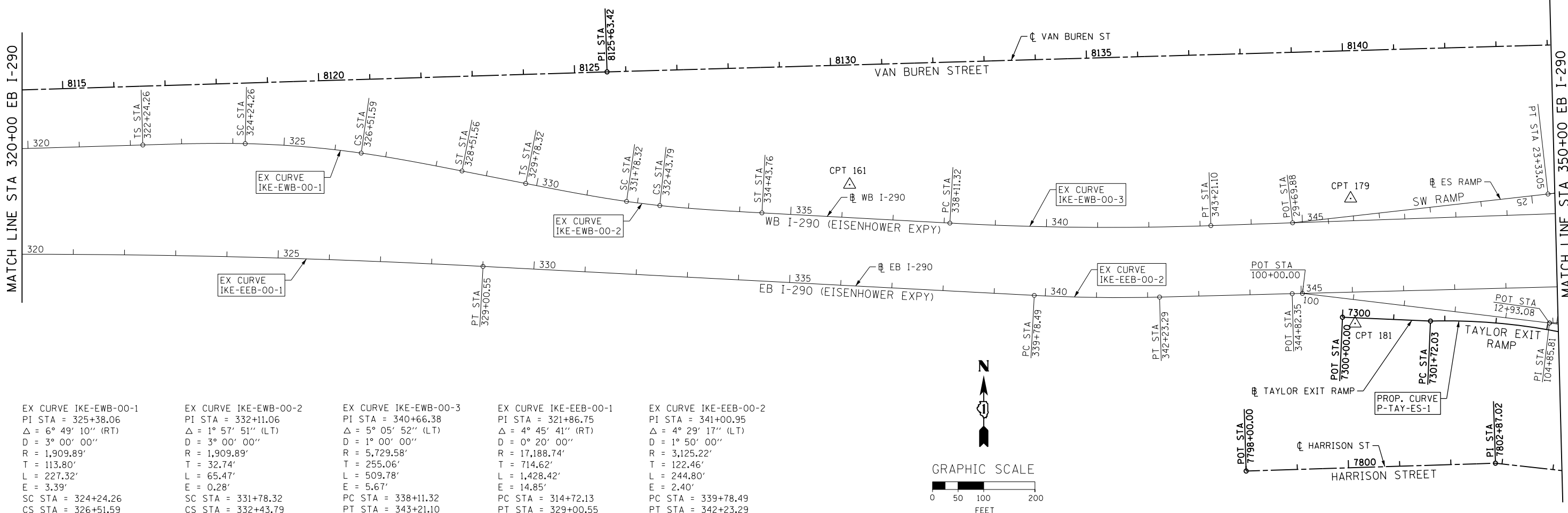

EX CURVE IKE-EWB-00-1 PI STA = 325+38.06 $\Delta = 6^\circ 49' 10''$ (RT) $D = 3^\circ 00' 00''$ $R = 1,909.89'$ $T = 113.80'$ $L = 227.32'$ $E = 3.39'$ SC STA = 324+24.26 CS STA = 326+51.59	EX CURVE IKE-EWB-00-2 PI STA = 332+11.06 $\Delta = 1^\circ 57' 51''$ (LT) $D = 3^\circ 00' 00''$ $R = 1,909.89'$ $T = 32.74'$ $L = 65.47'$ $E = 0.28'$ SC STA = 331+78.32 CS STA = 332+43.79	EX CURVE IKE-EWB-00-3 PI STA = 340+66.38 $\Delta = 5^\circ 05' 52''$ (LT) $D = 1^\circ 00' 00''$ $R = 5,729.58'$ $T = 255.06'$ $L = 509.78'$ $E = 5.67'$ PC STA = 338+11.32 PT STA = 343+21.10	EX CURVE IKE-EEB-00-1 PI STA = 321+86.75 $\Delta = 4^\circ 45' 41''$ (RT) $D = 0^\circ 20' 00''$ $R = 17,188.74'$ $T = 714.62'$ $L = 1,428.42'$ $E = 14.85'$ PC STA = 314+72.13 PT STA = 329+00.55	EX CURVE IKE-EEB-00-2 PI STA = 341+00.95 $\Delta = 4^\circ 29' 17''$ (LT) $D = 1^\circ 50' 00''$ $R = 3,125.22'$ $T = 122.46'$ $L = 244.80'$ $E = 2.40'$ PC STA = 339+78.49 PT STA = 342+23.29
---	---	---	---	---



DI60W26-Sht-41B-04.dgn	DESIGNED - OPS	REVISED -
USER NAME = chitua	DRAWN - PHP	REVISED -
PLOT SCALE = 100.0000' / 1"	CHECKED - DBM	REVISED -
PLOT DATE = 9/12/2013	DATE - 9/15/13	REVISED -

**STATE OF ILLINOIS
DEPARTMENT OF TRANSPORTATION**

ALIGNMENT, TIES AND BENCHMARKS

SCALE: 1" = 100' SHEET 4 OF 6 SHEETS STA. TO STA.

F.A.I. RTE. 90/94/290	SECTION 2013-008R	COUNTY COOK	TOTAL SHEETS 559	SHEET NO. 47
CONTRACT NO. 60W26				
ILLINOIS FED. AID PROJECT				