

PLAN	SURVEYED	DATE
	PLOTTED	
	NOTED	
	CHECKED	
	ALIGNED	
	FILED	
	NO.	
	BY	

PROFILE	SURVEYED	DATE
	PLOTTED	
	NOTED	
	CHECKED	
	ALIGNED	
	FILED	
	NO.	
	BY	

FILE PATH = p:\1388039-p\m\1\escom\line\local\p\AEC\000\Documents\01\Americas\Transportation\62629938 - Circle Phase II\000-CD-005-Roadway\Sheets\60W26-sht-P1npr-f-06

- A - 7807+40.05, 32.0' LT (EOP)
- B - 7807+41.56, 35.6' RT (EDGE OF SIDEWALK)
- C - 7807+32.79, 43.6' LT (EDGE OF SIDEWALK)
- D - 7807+41.56, 25.0' RT (EOP)
- E - 7807+67.06, 0.0' (BEGIN BR APPR PVT CON (FLX))

PC CONC SIDEWALK 5
SAND CUSHION 4 (CDOT)
HMA SC "D" N70, 1 3/4"
HMA BC IL-19.0 N70, 2 1/4"
PCC BSE CSE 9
SUB GRAN MAT B 6

COMB C&G B V.12(CDOT)
PC CONC SIDEWALK 5
SAND CUSHION 4 (CDOT)
BR APPR PAVT. SEE
STRUCTURAL PLANS

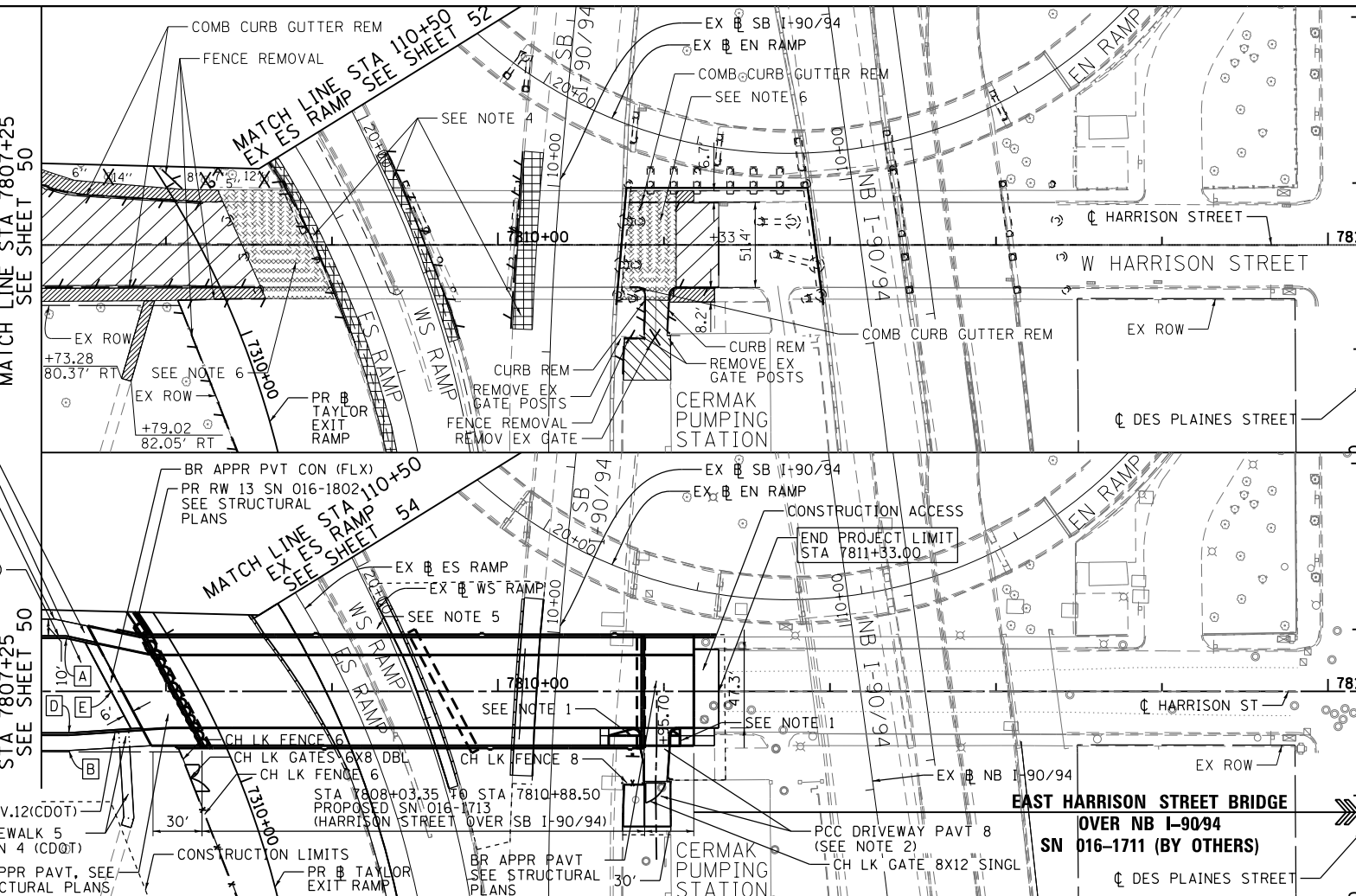

PAVEMENT REMOVAL LEGEND

- PAVEMENT REMOVAL
- DRIVEWAY PAVEMENT REMOVAL
- SIDEWALK REMOVAL
- HMA SURFACE REMOVAL - BUTT JOINT
- APPROACH SLAB REMOVAL
- MEDIAN REMOVAL
- PAVED SHOULDER REMOVAL
- LINEAR REMOVAL
- TREE REMOVAL
- TREE TRUNK PROTECTION, TREE ROOT PRUNING, TREE PRUNING
- SAPLING REMOVAL (NOT MEASURED FOR PAYMENT)

EXISTING

- ### NOTES
1. SEE CURB RAMP DETAIL FOR ADA RAMP INFORMATION.
 2. SEE ROADWAY AND GRADING PLAN DETAILS FOR WEST DRIVEWAY AT CERMAK PUMPING STATION.
 3. SEE PLAN AND PROFILE - HALSTED STREET FOR ADDITIONAL INFORMATION.
 4. SEE SB I-90/94 REMOVAL PLAN FOR ADDITIONAL INFORMATION.
 5. SEE SB I-90/94 ROADWAY PLAN FOR ADDITIONAL INFORMATION.
 6. SEE EX HARRISON STREET BRIDGE PLANS FOR ADDITIONAL INFORMATION FOR EX APPROACH SLAB REMOVAL.
 7. CHAIN LINK FENCE 8' AND CHAIN LINK GATES 8' X 12' SINGLE FOR THE CERMAK PUMPING STATION TO BE REMOVED IN A FUTURE CONTRACT.

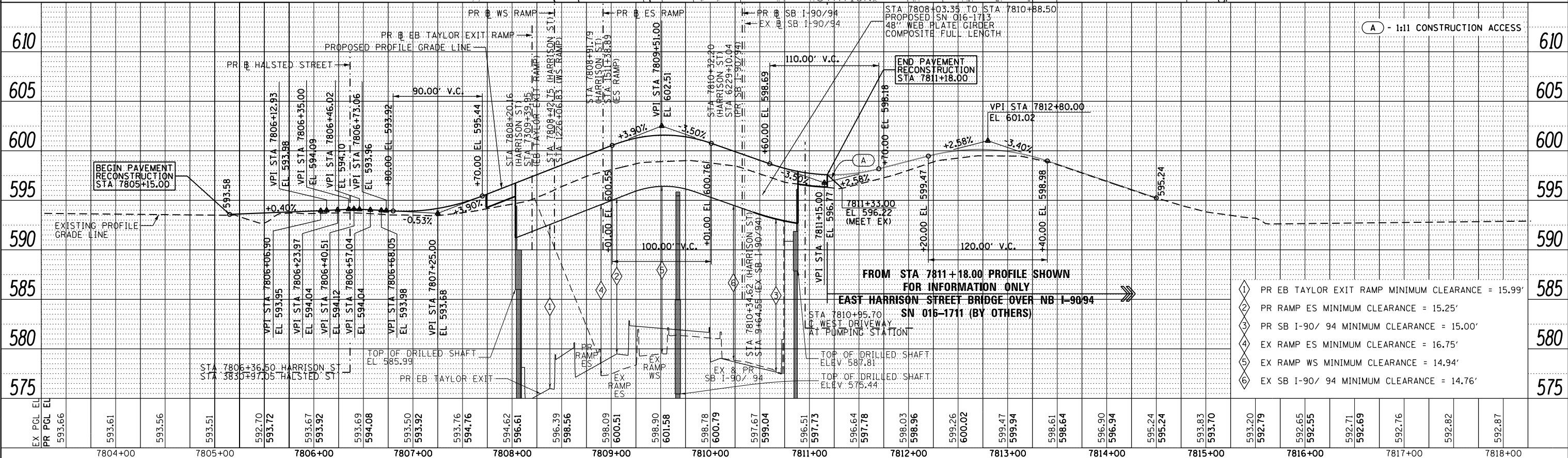
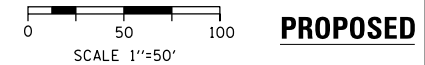

- 1 PR EB TAYLOR EXIT RAMP MINIMUM CLEARANCE = 15.99'
- 2 PR RAMP ES MINIMUM CLEARANCE = 15.25'
- 3 PR SB I-90/ 94 MINIMUM CLEARANCE = 15.00'
- 4 EX RAMP ES MINIMUM CLEARANCE = 16.75'
- 5 EX RAMP WS MINIMUM CLEARANCE = 14.94'
- 6 EX SB I-90/ 94 MINIMUM CLEARANCE = 14.76'

EX PGL EL	PR PGL EL	7804+00	7805+00	7806+00	7807+00	7808+00	7809+00	7810+00	7811+00	7812+00	7813+00	7814+00	7815+00	7816+00	7817+00	7818+00
593.66	593.61															
593.56																
593.51																
592.70																
593.72																
593.67																
593.92																
593.69																
594.08																
593.50																
593.92																
593.76																
594.76																
594.62																
596.61																
596.39																
598.56																
598.09																
600.51																
598.90																
601.58																
598.78																
600.79																
597.67																
599.04																
596.51																
597.73																
596.64																
597.78																
598.03																
598.96																
599.26																
600.02																
599.47																
599.94																
598.61																
598.64																
596.90																
596.94																
595.24																
595.24																
593.83																
593.70																
593.20																
592.79																
592.65																
592.55																
592.71																
592.69																
592.76																
592.82																
592.87																



D160W26-sht-P1npr-f-06	DESIGNED - OPS	REVISED -
USER NAME = chhua	DRAWN - OPS	REVISED -
PLOT SCALE = 50.0000' / in.	CHECKED - DBM	REVISED -
PLOT DATE = 9/13/2013	DATE = 09/15/13	REVISED -

STATE OF ILLINOIS
DEPARTMENT OF TRANSPORTATION

PLAN AND PROFILE
HARRISON STREET

F.A.I. RTE.	SECTION	COUNTY	TOTAL SHEETS	SHEET NO.
90/94/290	2013-008R	COOK	559	56
CONTRACT NO. 60W26			ILLINOIS FED. AID PROJECT	

SCALE: 1"=50' SHEET 7 OF 9 SHEETS STA. TO STA.