

- NOTE:
- UNLESS NOTED OTHERWISE, ALL STATIONS AND OFFSETS USED ARE TAKEN FROM EXISTING EB AND WB I-290 BASELINES.
  - FOR LEGEND SEE SHEET NO. 65

MATCH LINE STA 362+00 EB I-290  
SEE SHEET NO. 73

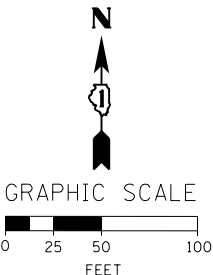
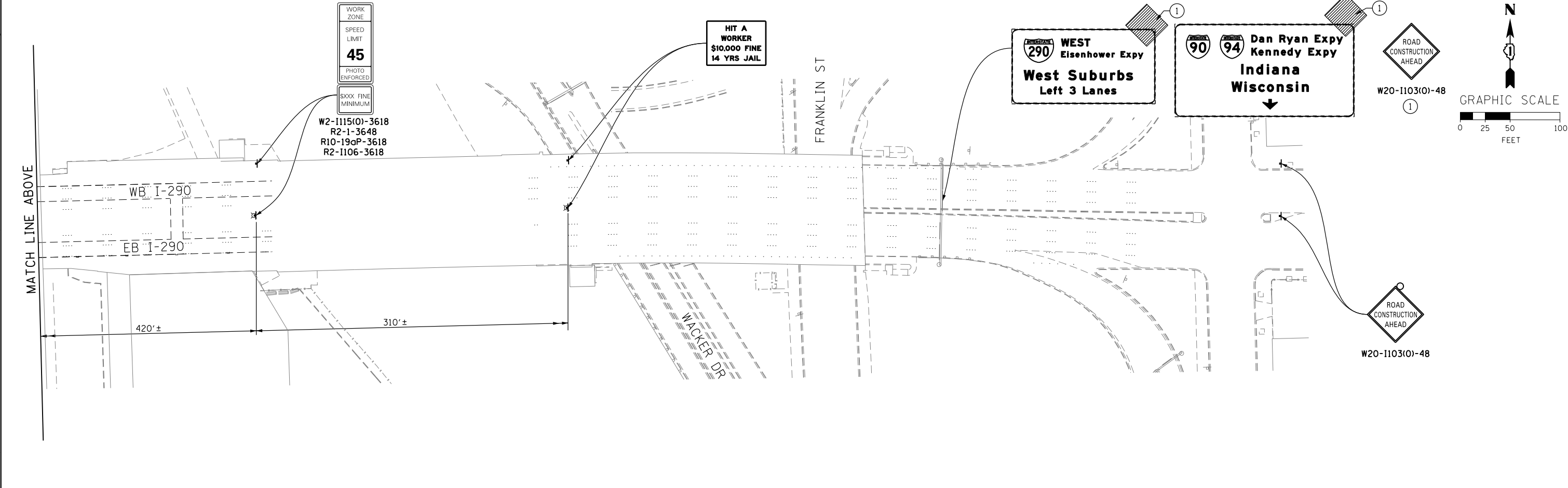
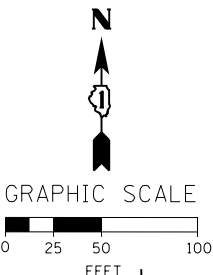
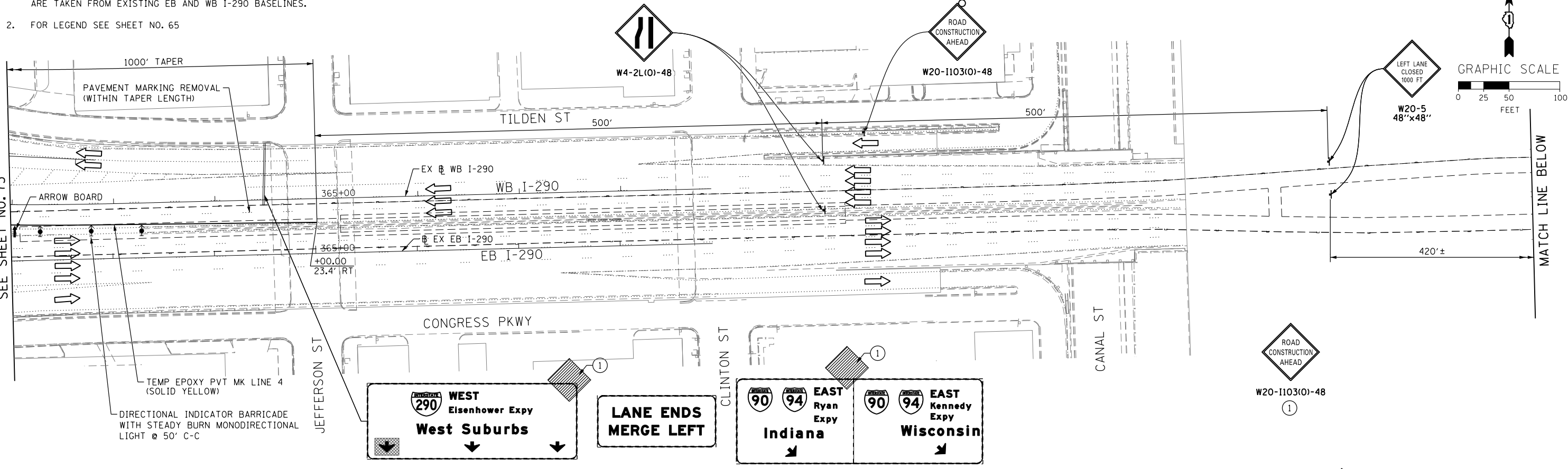

FILE PATH = ...  
**AECOM** **TransSystems**  
 D160W26-Sht-Staging1A-ML-04  
 USER NAME = pimsarno  
 PLOT SCALE = 50.0000' / in.  
 PLOT DATE = 9/15/2013

DESIGNED - OPS	REVISED -
DRAWN - PHP	REVISED -
CHECKED - DBM	REVISED -
DATE - 9/15/13	REVISED -

**STATE OF ILLINOIS  
DEPARTMENT OF TRANSPORTATION**

**SUGGESTED STAGES OF CONSTRUCTION AND TRAFFIC CONTROL PLAN  
MAINLINE STAGING 1A**

SCALE: 1" = 50'    SHEET 4 OF 8 SHEETS    STA.    TO STA.

F.A.I. RTE.	SECTION	COUNTY	TOTAL SHEETS	SHEET NO.
90/94/290	2013-008R	COOK	559	74
CONTRACT NO. 60W26				
ILLINOIS FED. AID PROJECT				