

**PROPOSED TEMP PAVEMENT MARKINGS AND TRAFFIC CONTROL DEVICES**

- (A) TEMP EPOXY PVT MK LINE 4 (SOLID WHITE)
- (B) TEMP EPOXY PVT MK LINE 4 (SOLID YELLOW)
- (C) TEMP EPOXY PVT MK LINE 8 (SOLID WHITE)
- (D) TEMP EPOXY PVT MK LINE 12 (WHITE CHEVRONS) (TYP)
- (E) TEMP EPOXY PVT MK LINE 5 (10' DASH 30' SKIP, WHITE)
- (F) TYPE II BARRICADE OR DRUMS WITH STEADY BURN MONODIRECTIONAL LIGHT @ 50' C-C (TYP) ON TAPERS AND @ 100' C-C (TYP) ON TANGENTS
- (G) TYPE II BARRICADE OR DRUMS WITH STEADY BURN MONODIRECTIONAL LIGHT @ 50' C-C (TYP) ON RAMP TAPERS
- (H) TEMP CONC BARRIER
- (I) IMP ATTN TEMP FRN TL3
- (J) DIRECTIONAL INDICATOR BARRICADE WITH STEADY BURN MONODIRECTIONAL LIGHT @ 50' C-C

**TEMP PAVEMENT MARKINGS AND TRAFFIC CONTROL DEVICES FROM PREVIOUS STAGE TO REMAIN**

- (AA) TEMP EPOXY PVT MK LINE 4 (SOLID WHITE)
- (BB) TEMP EPOXY PVT MK LINE 4 (SOLID YELLOW)
- (CC) TEMP EPOXY PVT MK LINE 8 (SOLID WHITE)
- (DD) TEMP EPOXY PVT MK LINE 12 (WHITE CHEVRONS) (TYP)
- (EE) TEMP EPOXY PVT MK LINE 5 (10' DASH 30' SKIP, WHITE)
- (FF) TYPE II BARRICADE OR DRUMS WITH STEADY BURN MONODIRECTIONAL LIGHT @ 50' C-C (TYP) ON TAPERS AND @ 100' C-C (TYP) ON TANGENTS

- (GG) TYPE II BARRICADE OR DRUMS WITH STEADY BURN MONODIRECTIONAL LIGHT @ 50' C-C (TYP) ON RAMP TAPERS
- (HH) TEMP CONC BARRIER
- (II) IMP ATTN TEMP FRN TL3
- (JJ) DIRECTIONAL INDICATOR BARRICADE WITH STEADY BURN MONODIRECTIONAL LIGHT @ 50' C-C

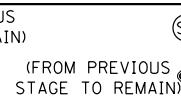
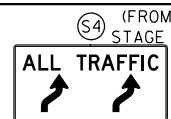
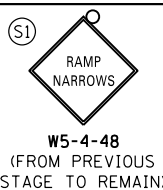

**NOTES:**  
 1. UNLESS NOTED OTHERWISE, ALL STATIONS AND OFFSETS USED ARE TAKEN FROM EITHER EXISTING EB AND WB I-290 BASELINES  
 2. SEE LAYOUT INFORMATION ON SHEET 69 & 70

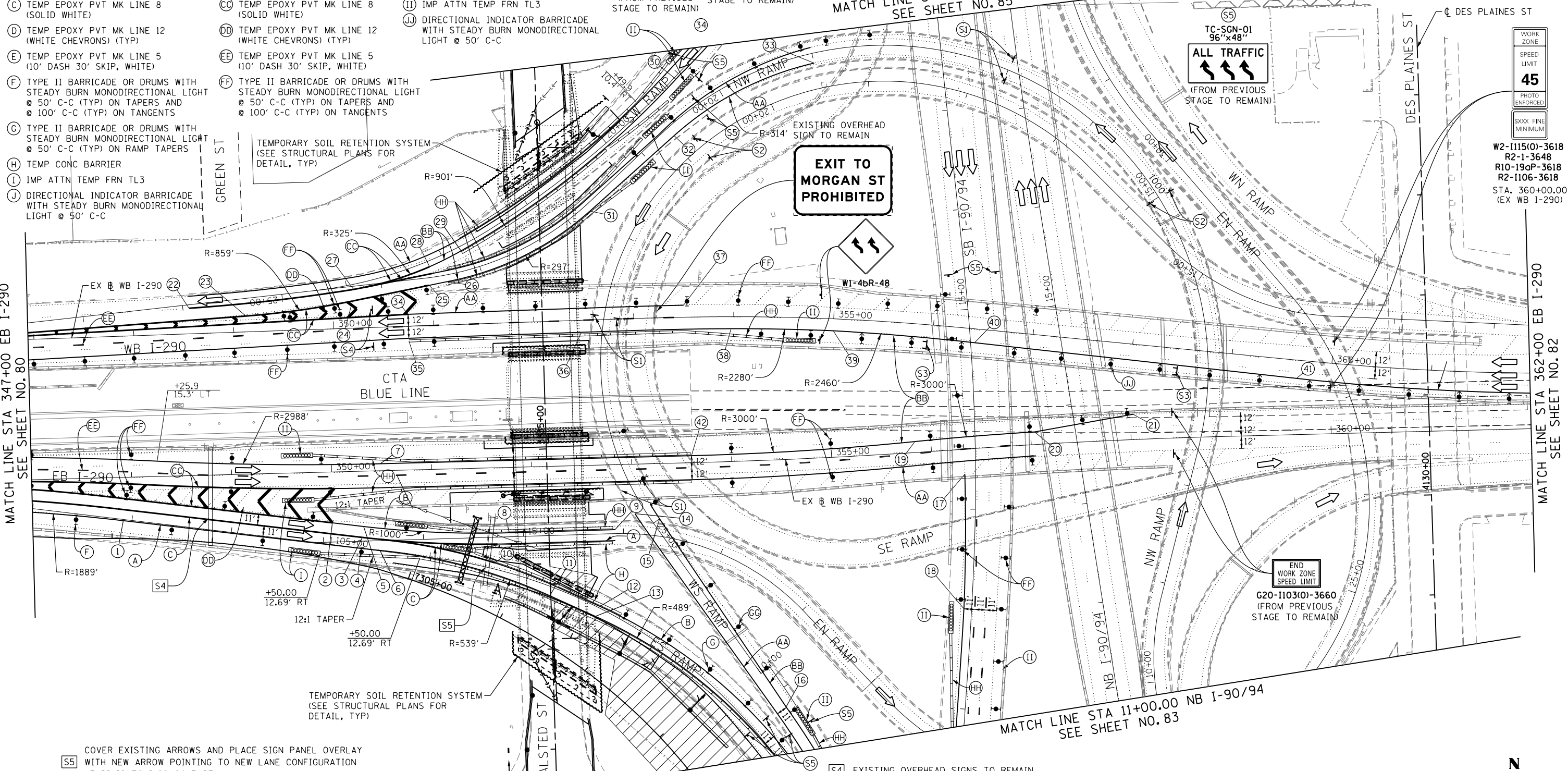

(S5) COVER EXISTING ARROWS AND PLACE SIGN PANEL OVERLAY WITH NEW ARROW POINTING TO NEW LANE CONFIGURATION LEADING TO I-90/94 EAST

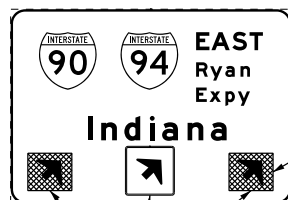
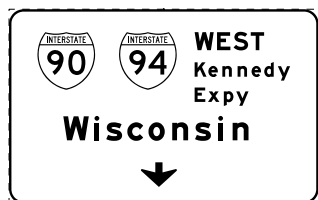

(S4) EXISTING OVERHEAD SIGNS TO REMAIN

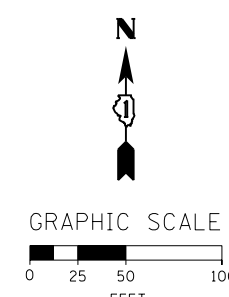
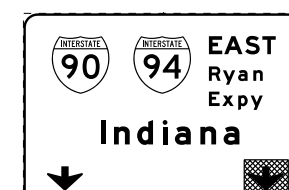
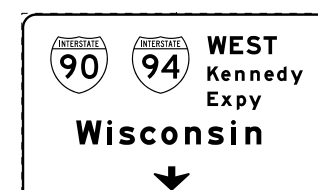

D160W26-Sht-StagingIB-ML-03  
 USER NAME = pimsarno  
 PLOT SCALE = 50.0000' / in.  
 PLOT DATE = 9/15/2013

DESIGNED - OPS	REVISED -
DRAWN - PHP	REVISED -
CHECKED - DBM	REVISED -
DATE - 9/15/13	REVISED -

**STATE OF ILLINOIS  
 DEPARTMENT OF TRANSPORTATION**

**SUGGESTED STAGES OF CONSTRUCTION AND TRAFFIC CONTROL PLAN  
 MAINLINE STAGING 1B**

SCALE: 1" = 50' SHEET 3 OF 8 SHEETS STA. TO STA.

F.A.I. RTE. 90/94/290	SECTION 2013-008R	COUNTY COOK	TOTAL SHEETS 559	SHEET NO. 81
CONTRACT NO. 60W26				
ILLINOIS FED. AID PROJECT				