

PROPOSED TEMP PAVEMENT MARKINGS AND TRAFFIC CONTROL DEVICES

- (A) TEMP EPOXY PVT MK LINE 4 (SOLID WHITE)
- (B) TEMP EPOXY PVT MK LINE 4 (SOLID YELLOW)
- (C) TEMP EPOXY PVT MK LINE 8 (SOLID WHITE)
- (D) TEMP EPOXY PVT MK LINE 12 (WHITE CHEVRONS) (TYP)
- (E) TEMP EPOXY PVT MK LINE 5 (10' DASH 30' SKIP, WHITE)
- (F) TYPE II BARRICADE OR DRUMS WITH STEADY BURN MONODIRECTIONAL LIGHT @ 50' C-C (TYP) ON TAPERS AND @ 100' C-C (TYP) ON TANGENTS
- (G) TYPE II BARRICADE OR DRUMS WITH STEADY BURN MONODIRECTIONAL LIGHT @ 50' C-C (TYP) ON RAMP TAPERS
- (H) TEMP CONC BARRIER
- (I) IMP ATTN TEMP FRN TL3
- (J) DIRECTIONAL INDICATOR BARRICADE WITH STEADY BURN MONODIRECTIONAL LIGHT @ 50' C-C

TEMP PAVEMENT MARKINGS AND TRAFFIC CONTROL DEVICES FROM PREVIOUS STAGE TO REMAIN

- (AA) TEMP EPOXY PVT MK LINE 4 (SOLID WHITE)
- (BB) TEMP EPOXY PVT MK LINE 4 (SOLID YELLOW)
- (CC) TEMP EPOXY PVT MK LINE 8 (SOLID WHITE)
- (DD) TEMP EPOXY PVT MK LINE 12 (WHITE CHEVRONS) (TYP)
- (EE) TEMP EPOXY PVT MK LINE 5 (10' DASH 30' SKIP, WHITE)
- (FF) TYPE II BARRICADE OR DRUMS WITH STEADY BURN MONODIRECTIONAL LIGHT @ 50' C-C (TYP) ON TAPERS AND @ 100' C-C (TYP) ON TANGENTS

- (GG) TYPE II BARRICADE OR DRUMS WITH STEADY BURN MONODIRECTIONAL LIGHT @ 50' C-C (TYP) ON RAMP TAPERS
- (HH) TEMP CONC BARRIER
- (II) IMP ATTN TEMP FRN TL3
- (JJ) DIRECTIONAL INDICATOR BARRICADE WITH STEADY BURN MONODIRECTIONAL LIGHT @ 50' C-C

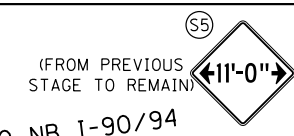
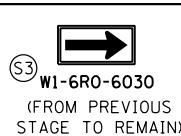
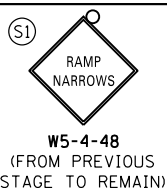

NOTES:
 1. UNLESS NOTED OTHERWISE, ALL STATIONS AND OFFSETS USED ARE TAKEN FROM EITHER EXISTING EB AND WB I-290 BASELINES
 2. SEE LAYOUT INFORMATION ON SHEET 69 & 70

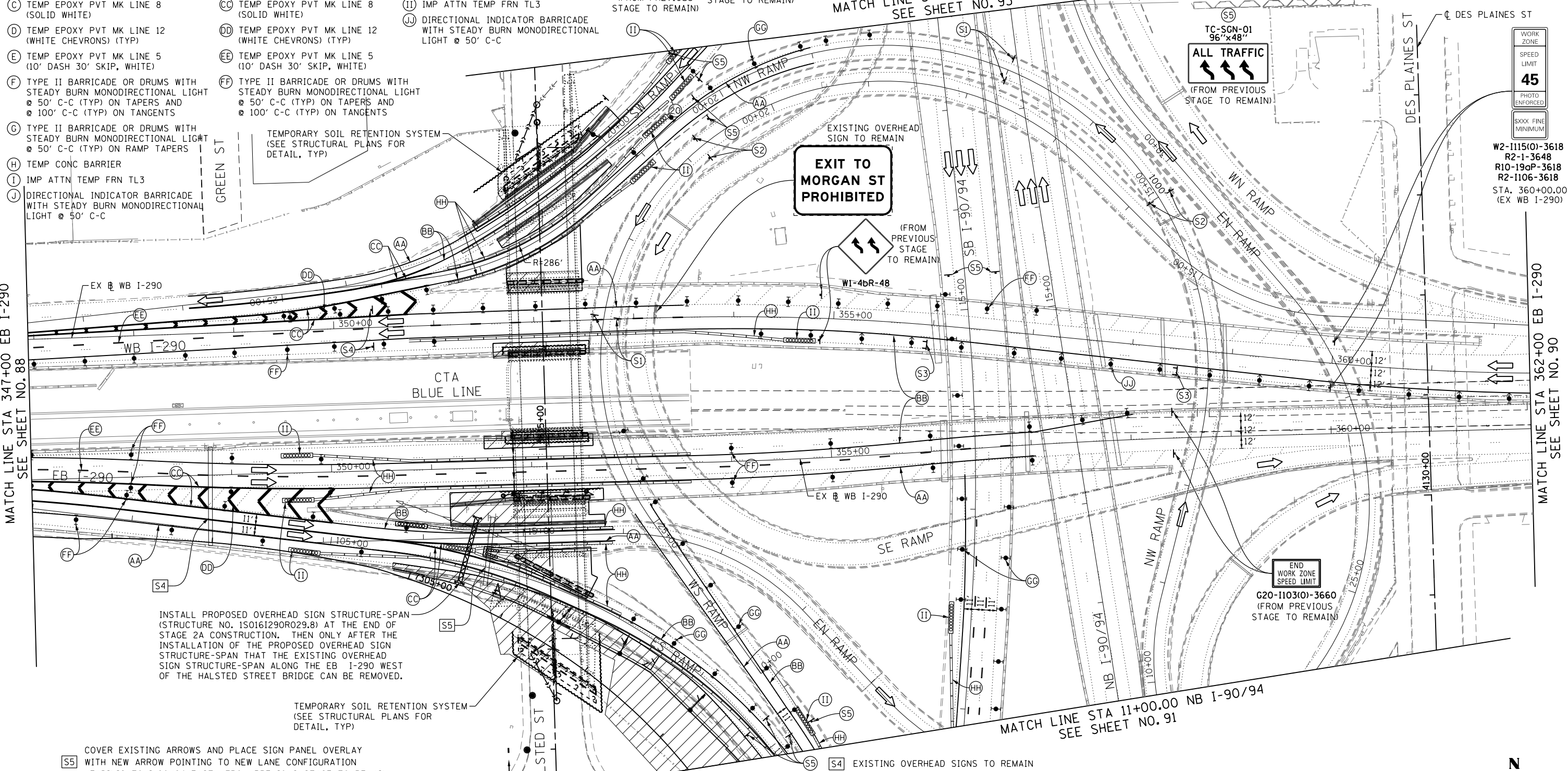

MATCH LINE STA 347+00 EB I-290 SEE SHEET NO. 88

MATCH LINE STA 362+00 EB I-290 SEE SHEET NO. 90

MATCH LINE STA 11+00.00 NB I-90/94 SEE SHEET NO. 91

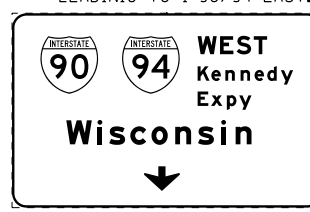
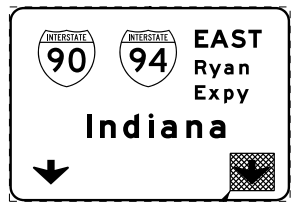
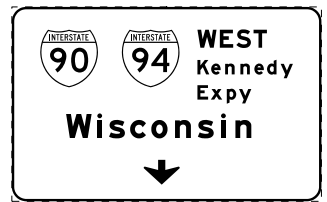

INSTALL PROPOSED OVERHEAD SIGN STRUCTURE-SPAN (STRUCTURE NO. 150161290R029.8) AT THE END OF STAGE 2A CONSTRUCTION. THEN ONLY AFTER THE INSTALLATION OF THE PROPOSED OVERHEAD SIGN STRUCTURE-SPAN THAT THE EXISTING OVERHEAD SIGN STRUCTURE-SPAN ALONG THE EB I-290 WEST OF THE HALSTED STREET BRIDGE CAN BE REMOVED.

TEMPORARY SOIL RETENTION SYSTEM (SEE STRUCTURAL PLANS FOR DETAIL, TYP)

(S5) COVER EXISTING ARROWS AND PLACE SIGN PANEL OVERLAY WITH NEW ARROW POINTING TO NEW LANE CONFIGURATION LEADING TO I-90/94 EAST. (FROM PREVIOUS STAGE TO REMAIN)



D160W26-Sht-Staging2A-ML-03
 USER NAME = pimsarno
 PLOT SCALE = 50.0000' / in.
 PLOT DATE = 9/15/2013

| | |
|----------------|-----------|
| DESIGNED - OPS | REVISED - |
| DRAWN - PHP | REVISED - |
| CHECKED - DBM | REVISED - |
| DATE - 9/15/13 | REVISED - |

**STATE OF ILLINOIS
 DEPARTMENT OF TRANSPORTATION**

**SUGGESTED STAGES OF CONSTRUCTION AND TRAFFIC CONTROL PLAN
 MAINLINE STAGING 2A**
 SCALE: 1" = 50' SHEET 3 OF 8 SHEETS STA. TO STA.

| | | | | |
|---------------------------|-------------------|-------------|------------------|--------------|
| F.A.I. RTE. 90/94/290 | SECTION 2013-008R | COUNTY COOK | TOTAL SHEETS 559 | SHEET NO. 89 |
| CONTRACT NO. 60W26 | | | | |
| ILLINOIS FED. AID PROJECT | | | | |