

PROPOSED TEMP PAVEMENT MARKINGS AND TRAFFIC CONTROL DEVICES

- (A) TEMP EPOXY PVT MK LINE 4 (SOLID WHITE)
- (B) TEMP EPOXY PVT MK LINE 4 (SOLID YELLOW)
- (C) TEMP EPOXY PVT MK LINE 8 (SOLID WHITE)
- (D) TEMP EPOXY PVT MK LINE 12 (WHITE CHEVRONS) (TYP)
- (E) TEMP EPOXY PVT MK LINE 5 (10' DASH 30' SKIP, WHITE)
- (F) TYPE II BARRICADE OR DRUMS WITH STEADY BURN MONODIRECTIONAL LIGHT @ 50' C-C (TYP) ON TAPERS AND @ 100' C-C (TYP) ON TANGENTS
- (G) TYPE II BARRICADE OR DRUMS WITH STEADY BURN MONODIRECTIONAL LIGHT @ 50' C-C (TYP) ON RAMP TAPERS
- (H) TEMP CONC BARRIER
- (I) IMP ATTN TEMP FRN TL3
- (J) DIRECTIONAL INDICATOR BARRICADE WITH STEADY BURN MONODIRECTIONAL LIGHT @ 50' C-C

TEMP PAVEMENT MARKINGS AND TRAFFIC CONTROL DEVICES FROM PREVIOUS STAGE TO REMAIN

- (AA) TEMP EPOXY PVT MK LINE 4 (SOLID WHITE)
- (BB) TEMP EPOXY PVT MK LINE 4 (SOLID YELLOW)
- (CC) TEMP EPOXY PVT MK LINE 8 (SOLID WHITE)
- (DD) TEMP EPOXY PVT MK LINE 12 (WHITE CHEVRONS) (TYP)
- (EE) TEMP EPOXY PVT MK LINE 5 (10' DASH 30' SKIP, WHITE)
- (FF) TYPE II BARRICADE OR DRUMS WITH STEADY BURN MONODIRECTIONAL LIGHT @ 50' C-C (TYP) ON TAPERS AND @ 100' C-C (TYP) ON TANGENTS

- (GG) TYPE II BARRICADE OR DRUMS WITH STEADY BURN MONODIRECTIONAL LIGHT @ 50' C-C (TYP) ON RAMP TAPERS
- (HH) TEMP CONC BARRIER
- (II) IMP ATTN TEMP FRN TL3
- (JJ) DIRECTIONAL INDICATOR BARRICADE WITH STEADY BURN MONODIRECTIONAL LIGHT @ 50' C-C

- (S1) RAMP NARROWS (FROM PREVIOUS STAGE TO REMAIN)
- (S2) RAMP WORK AHEAD (FROM PREVIOUS STAGE TO REMAIN)
- (S3) W1-6R0-6030 (FROM PREVIOUS STAGE TO REMAIN)
- (S4) (FROM PREVIOUS STAGE TO REMAIN)
- (S5) (FROM PREVIOUS STAGE TO REMAIN)

NOTES:
 1. UNLESS NOTED OTHERWISE, ALL STATIONS AND OFFSETS USED ARE TAKEN FROM EITHER EXISTING EB AND WB I-290 BASELINES
 2. SEE LAYOUT INFORMATION ON SHEET 69 & 70

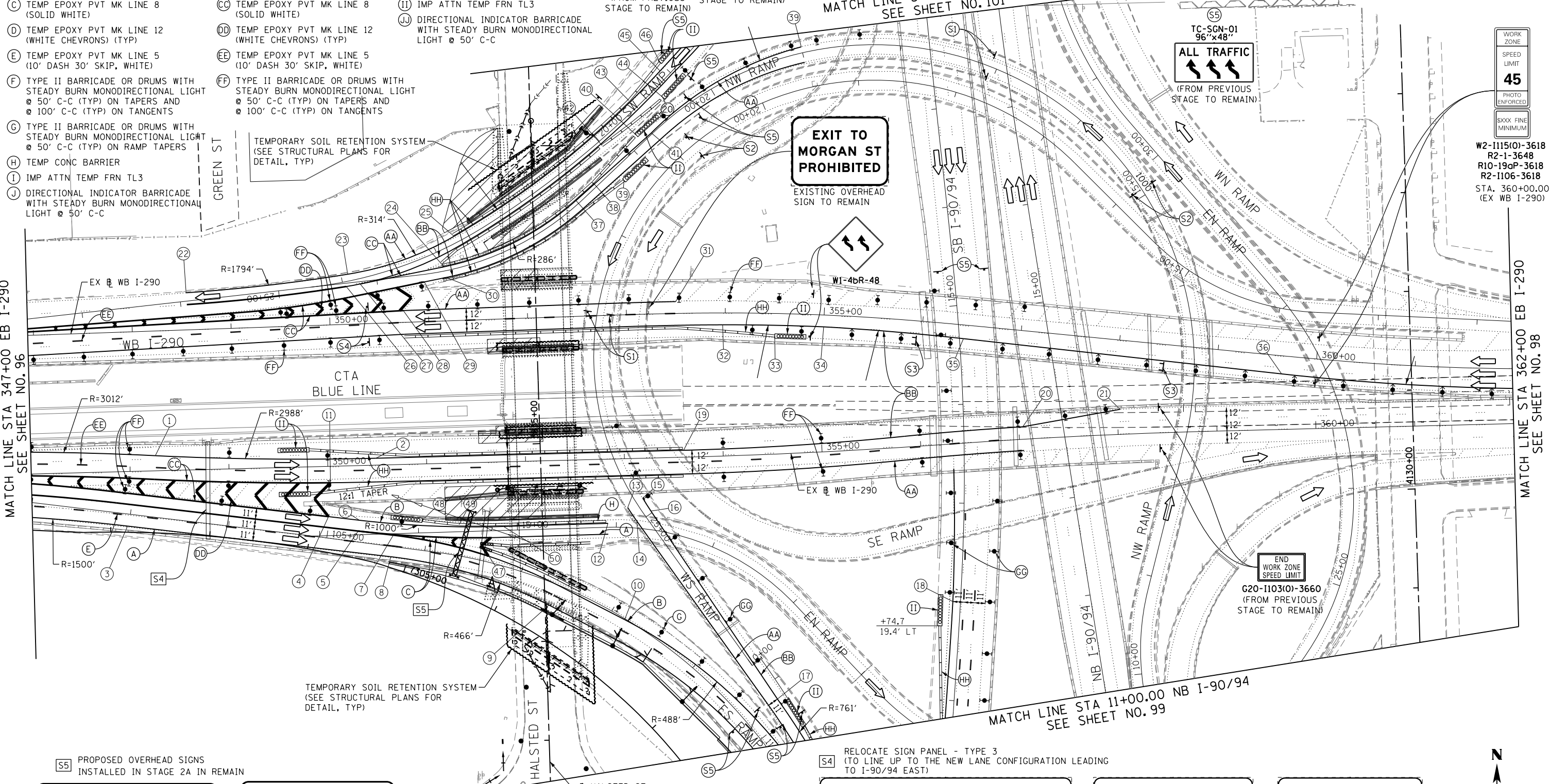

MATCH LINE STA 347+00 EB I-290 SEE SHEET NO. 96

MATCH LINE STA 362+00 EB I-290 SEE SHEET NO. 98

MATCH LINE STA 11+00.00 NB I-90/94 SEE SHEET NO. 99

WORK ZONE
 SPEED LIMIT
45
 PHOTO ENFORCED
 SIXX FINE MINIMUM
 W2-1115(0)-3618
 R2-1-3648
 R10-19aP-3618
 R2-1106-3618
 STA. 360+00.00
 (EX WB I-290)

(S5) PROPOSED OVERHEAD SIGNS INSTALLED IN STAGE 2A IN REMAIN

WEST Kennedy Expy
Wisconsin

EAST Ryan Expy
Indiana

(S4) RELOCATE SIGN PANEL - TYPE 3 (TO LINE UP TO THE NEW LANE CONFIGURATION LEADING TO I-90/94 EAST)

Congress Pkwy
Chicago Loop

WEST Kennedy Expy
Wisconsin

EAST Ryan Expy
Indiana

GRAPHIC SCALE
 0 25 50 100 FEET



D160W26-Sht-Staging2B-ML-03
 USER NAME = pimsarno
 PLOT SCALE = 50.0000' / in.
 PLOT DATE = 9/15/2013

DESIGNED - OPS	REVISED -
DRAWN - PHP	REVISED -
CHECKED - DBM	REVISED -
DATE - 9/15/13	REVISED -

STATE OF ILLINOIS
DEPARTMENT OF TRANSPORTATION

SUGGESTED STAGES OF CONSTRUCTION AND TRAFFIC CONTROL PLAN
MAINLINE STAGING 2B
 SCALE: 1" = 50' SHEET 3 OF 8 SHEETS STA. TO STA.

F.A.I. RTE.	SECTION	COUNTY	TOTAL SHEETS	SHEET NO.
90/94/290	2013-008R	COOK	559	97
CONTRACT NO. 60W26				

ILLINOIS FED. AID PROJECT