

1 EXISTING OVERHEAD SIGN TO REMAIN

EXIT 28B
Ashland Ave
1/2 MILE

NOTE:

- UNLESS NOTED OTHERWISE, ALL STATIONS AND OFFSETS USED ARE TAKEN FROM EXISTING EB AND WB I-290 BASELINES.
- FOR LEGEND SEE SHEET NO. 65

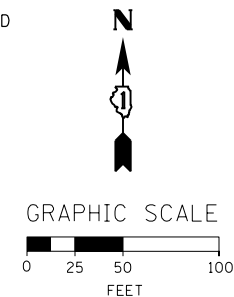

MATCH LINE STA 332+00 EB I-290
SEE SHEET NO. 103

MATCH LINE STA 347+00 EB I-290
SEE SHEET NO. 105

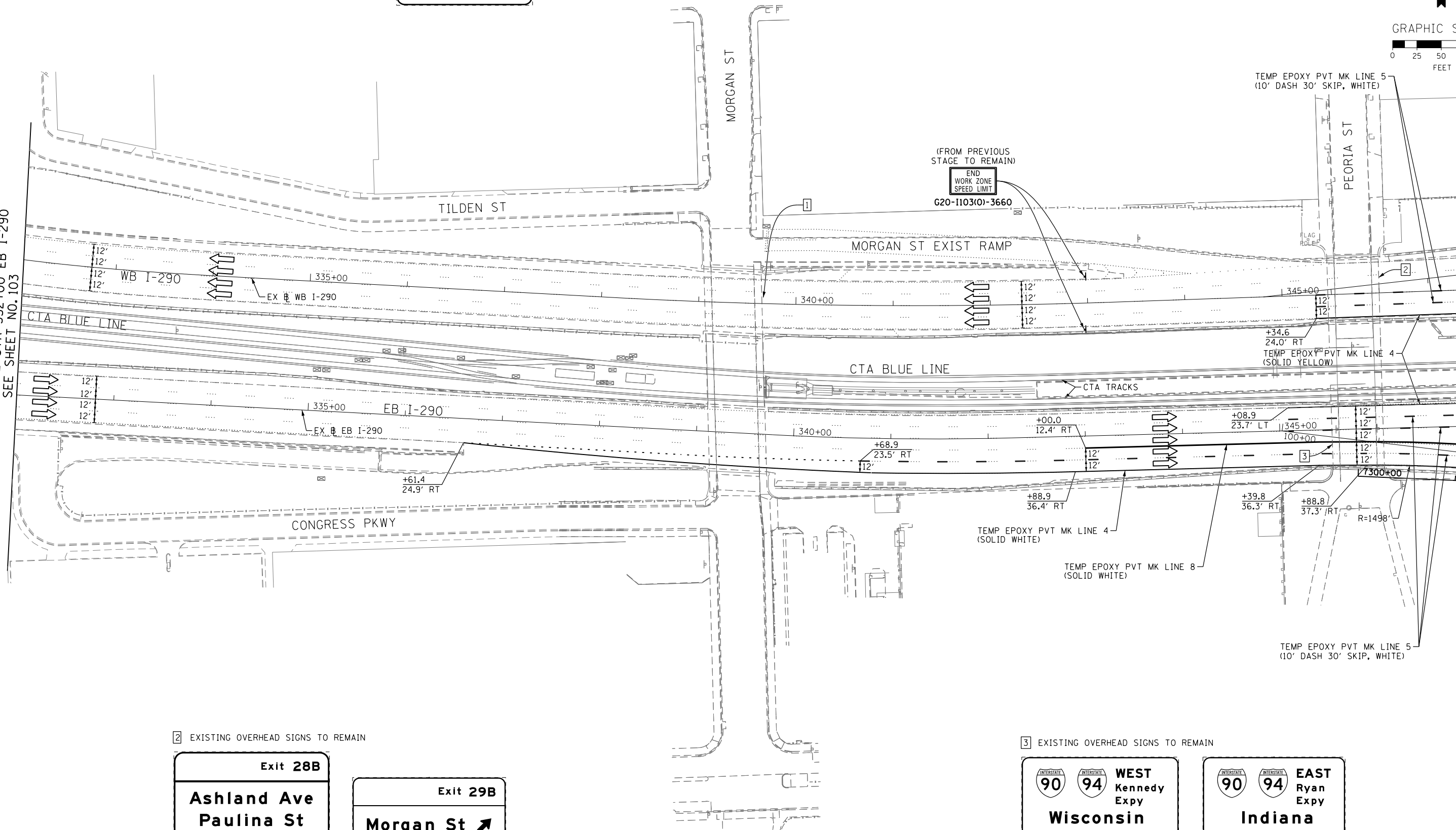

2 EXISTING OVERHEAD SIGNS TO REMAIN

Exit 28B
Ashland Ave
Paulina St
3/4 MILE

Exit 29B
Morgan St
1000 W

3 EXISTING OVERHEAD SIGNS TO REMAIN

90 94 WEST Kennedy Expy
Wisconsin

90 94 EAST Ryan Expy
Indiana

STATE OF ILLINOIS
DEPARTMENT OF TRANSPORTATION

SUGGESTED STAGES OF CONSTRUCTION AND TRAFFIC CONTROL PLAN
MAINLINE STAGING 3A-3C

SCALE: 1" = 50' SHEET 2 OF 8 SHEETS STA. TO STA.

F.A.I. RTE.	SECTION	COUNTY	TOTAL SHEETS	SHEET NO.
90/94/290	2013-008R	COOK	559	104
CONTRACT NO. 60W26				
ILLINOIS FED. AID PROJECT				



D160W26-Sht-Staging3AC-ML-02
USER NAME = pimsarno
PLOT SCALE = 50.0000' / in.
PLOT DATE = 9/15/2013

DESIGNED - OPS
DRAWN - PHP
CHECKED - DBM
DATE - 9/15/13

REVISED -
REVISED -
REVISED -
REVISED -

FILE PATH = p:\388035-p\m\l\escomon\lme\local\p\w\26\02\Documents\01_Americas\Transportation\60269938_Circle\Phase_1\1000_CAD\005_Roadway\Sheets\60W26_Sht-Staging3AC-ML-02