

PLAN	SURVEYED	DATE
	PLOTTED	BY
	ALIGNED	
	CHECKED	
	FILED	
	NO.	
	FILE NAME	

PROFILE	SURVEYED	DATE
	PLOTTED	BY
	GRADES CHECKED	
	STRUCTURE	
	NOT AT THIS OFFICE	
	NO.	
	FILE NAME	

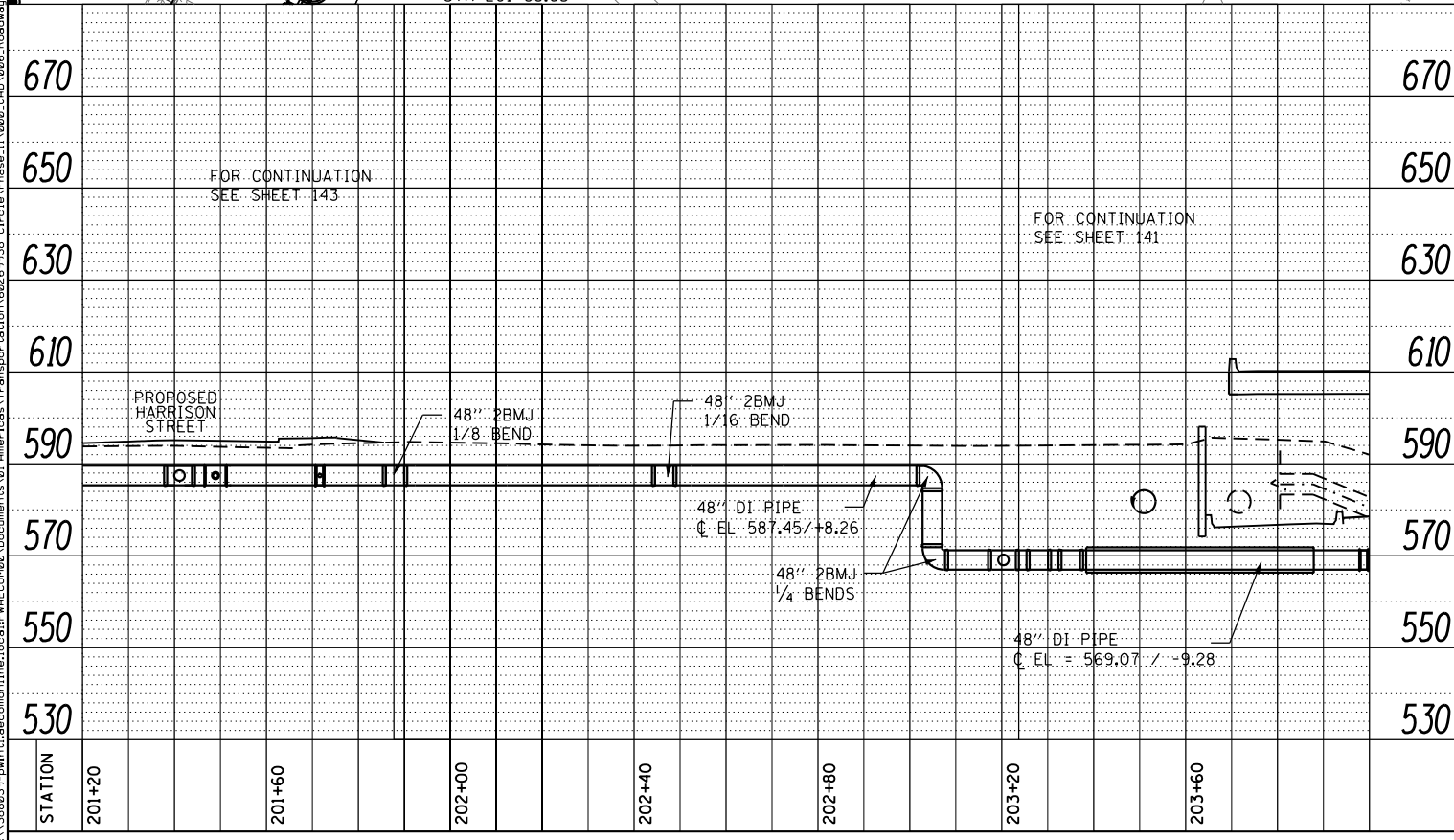
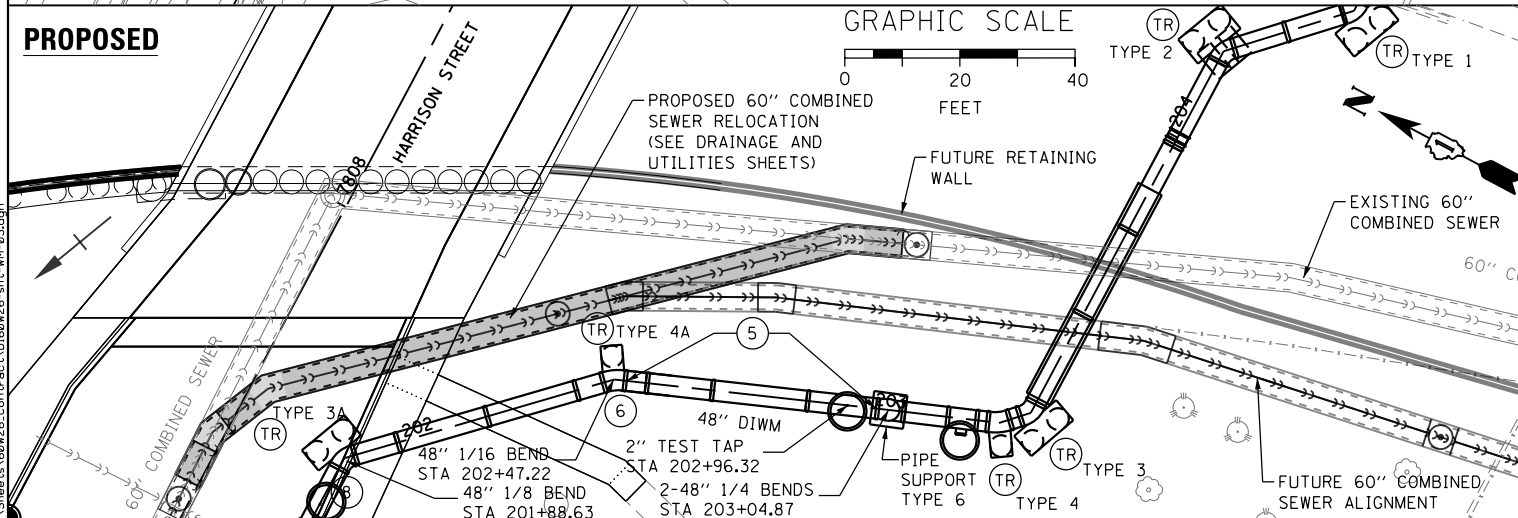
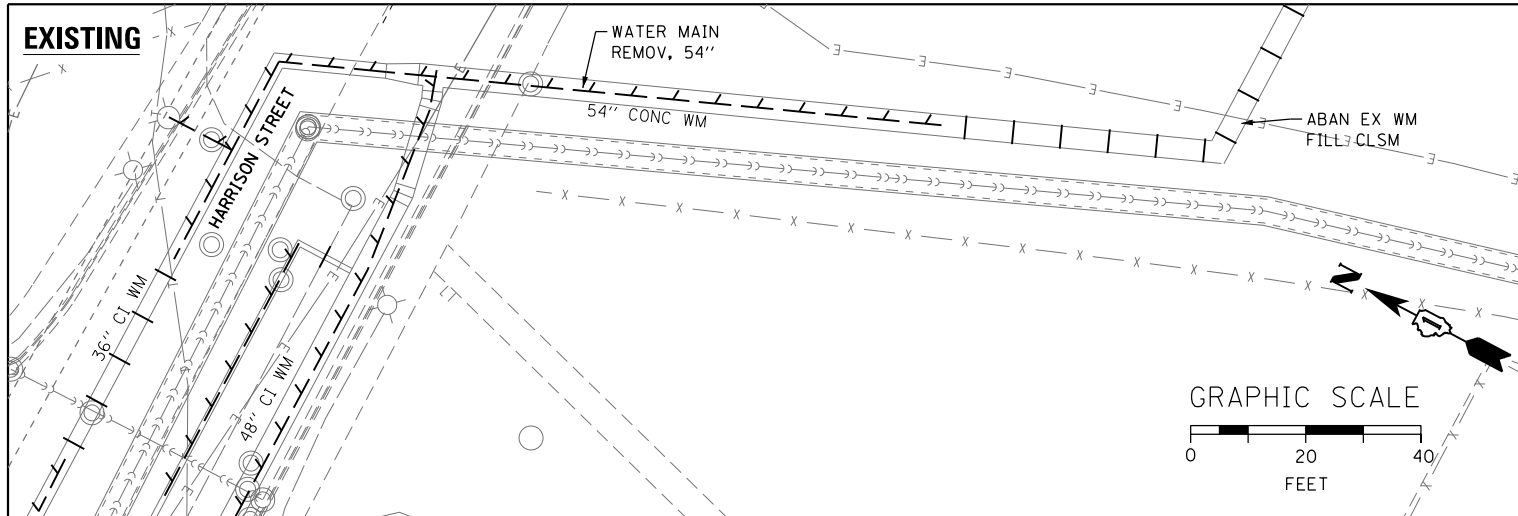

CONSTRUCTION/SEQUENCING NOTES:

THE LIMITS FOR REMOVAL AND ABANDONMENT OF EXISTING WATER MAIN PIPES MUST BE DETERMINED AS PART OF STAGING REQUIREMENTS AND CONSTRUCTION LIMITS FOR SEWER AND WATER MAIN CONSTRUCTION.

EXISTING THRUST RESTRAINTS NOT SHOWN FOR CLARITY. SEE RECORD INFORMATION FOR ANTICIPATED THRUST RESTRAINT LOCATIONS AND DIMENSIONS.

SEE SHEETS 141 & 143 FOR ADDITIONAL NOTES

5. INSTALL 2" TEST TAP IN BASIN AND 48" PIPE AS SHOWN

6. INSTALL 1-48" X 1/16 BEND TO ADJUST ALIGNMENT OF PIPE.

SEE SHEETS 99 & 101 FOR ADDITIONAL NOTES

8. INSTALL 1-48" X 1/8 BEND TO ADJUST ALIGNMENT OF PIPE.

SEE SHEETS 141 & 143 FOR ADDITIONAL NOTES

Ⓜ = THRUST RESTRAINT PER THRUST RESTRAINT DETAIL SHEETS FOR THRUST RESTRAINT TYPES AND DETAILS, SEE SHEETS 147 THROUGH 149.



D:\160W26-sht-WM-03.dgn
 USER NAME = CooperM2
 PLOT SCALE = 20.0000' / in.
 PLOT DATE = 9/15/2013

DESIGNED - HHC
 DRAWN - HHC
 CHECKED - RBB
 DATE - 8/20/13

REVISED -
 REVISED -
 REVISED -
 REVISED -

STATE OF ILLINOIS
 DEPARTMENT OF TRANSPORTATION

WATER MAIN
 PLAN AND PROFILE

SCALE: SHEET OF SHEETS STA. TO STA.

F.A.I. RTE.	SECTION	COUNTY	TOTAL SHEETS	SHEET NO.
90/94/290	2013-007R	COOK	559	142
CONTRACT NO. 60W26				
ILLINOIS FED. AID PROJECT				