

HALSTED STREET CTA ENTRANCE  
STA 3835+36.21 LT

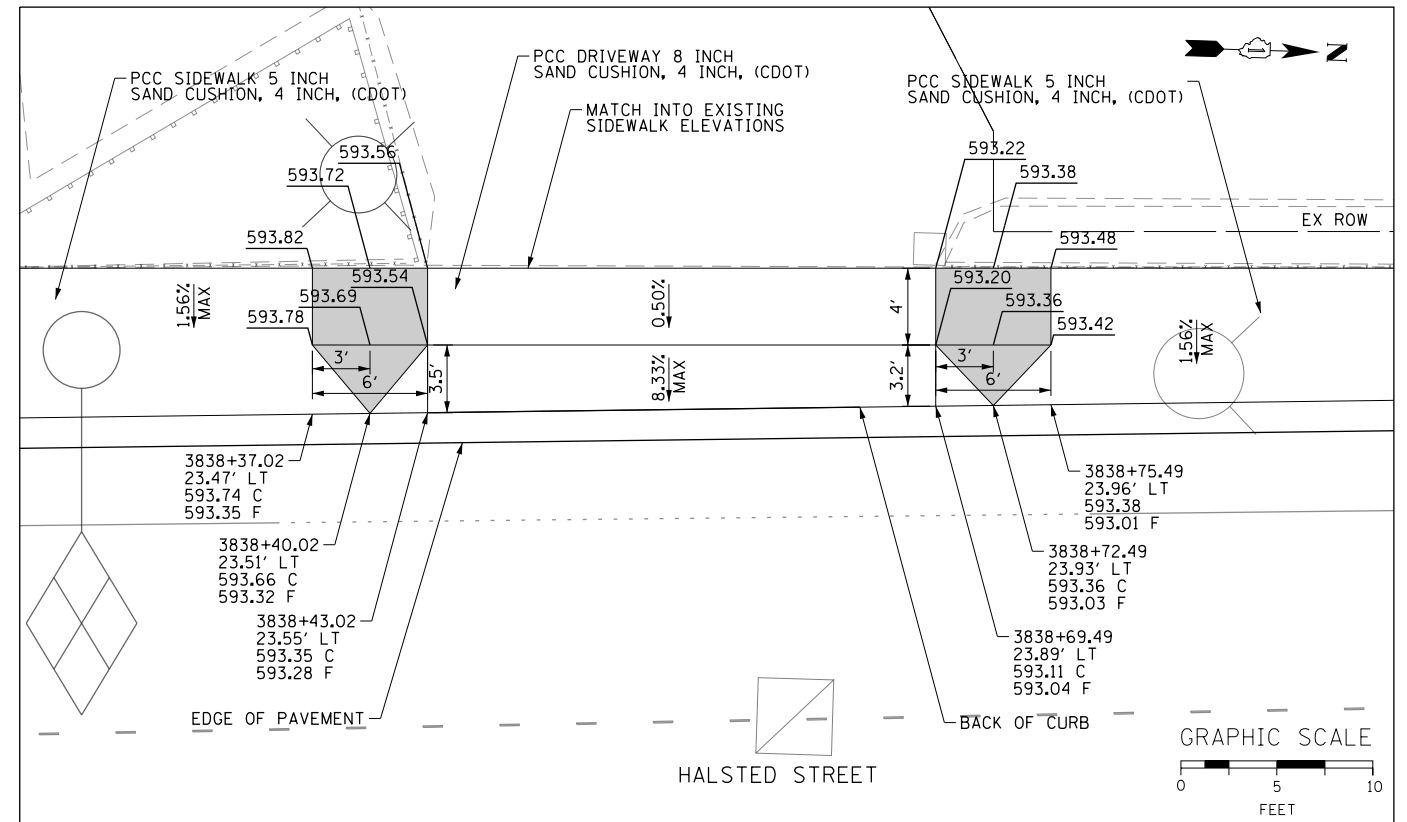

HALSTED STREET ENTRANCE  
STA 3838+54.28 LT

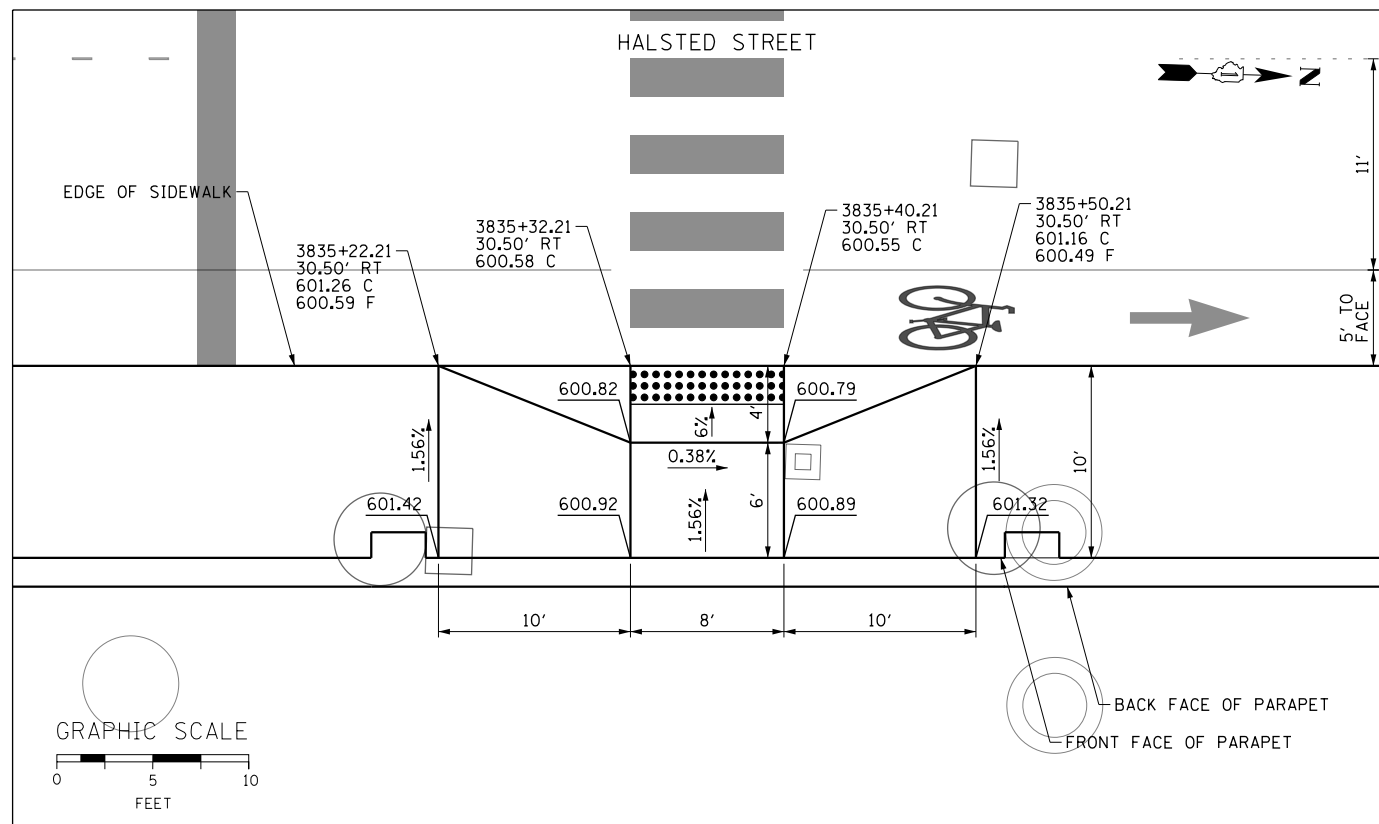



HALSTED STREET CTA ENTRANCE  
STA 3835+36.21 RT

**NOTES:**

1. ELEVATIONS ARE PROVIDED AT THE BACK OF CURB (C) AND FLOWLINE (F).
2. ALL CURB RAMPS, TRANSITIONS, AND FLARES SHALL BE PCC SIDEWALK 8 INCH.
3. ALL RADIAL DIMENSIONS ARE GIVEN ALONG THE BACK OF CURB.

**LEGEND**

-  PCC SIDEWALK, 8" SAND CUSHION, 4 INCH, (CDOT)
-  DETECTABLE WARNINGS (SPECIAL)
-  DEPRESSED CURB AND GUTTER (PAID AS "COMBINATION CONCRETE CURB AND GUTTER, TYPE B V.12 (CDOT)")

FILE PATH = c:\pwworking\seacom\02\k\lorenz\10160W26-sht-Intersec-Det-02.dgn



DI60W26-sht-Intersec-Det-02.dgn  
USER NAME = kolorenz  
PLOT SCALE = 5.0000' / in.  
PLOT DATE = 9/12/2013

DESIGNED - KAL  
DRAWN - BAW  
CHECKED - JLV  
DATE - 9/15/13

REVISED -  
REVISED -  
REVISED -  
REVISED -

**STATE OF ILLINOIS  
DEPARTMENT OF TRANSPORTATION**

**CURB RAMP DETAILS  
HALSTED STREET**

SCALE: 1"=5' SHEET 2 OF 3 SHEETS STA. TO STA.

F.A.I. RE.	SECTION	COUNTY	TOTAL SHEETS	SHEET NO.
90/94/290	2013-008R	COOK	559	165
CONTRACT NO. 60W26				
ILLINOIS FED. AID PROJECT				