

**NOTES:**

1. SEE DRAWING E-01 FOR IDOT ELECTRICAL SYMBOLS.
2. PROVIDE A TEMPORARY UTILITY SERVICE FEED FOR THE EXISTING IDOT COMMUNICATION'S HUT. THE TEMPORARY FEED SHALL BE INSTALLED FROM THE EXISTING COMED MANHOLE TO THE EXISTING IDOT COMMUNICATION'S HUT AS SHOWN. ALL WORK SHALL BE COORDINATED WITH AND INSTALLED IN ACCORDANCE WITH THE REQUIREMENTS OF THE ELECTRIC UTILITY SERVICE PROVIDER, COMED.
3. ROUTE THE TEMPORARY UTILITY SERVICE FEED THROUGH THE EXISTING IDOT HANDHOLE TO THE EXISTING POWER PANEL LOCATED INSIDE THE COMMUNICATION'S HUT.
4. PROVIDE A TEMPORARY POWER FEED FOR THE ROADWAY LIGHTING CIRCUITS LOCATED IN EXISTING HIGH MAST LIGHT TOWER ZAB4. THE FEED SHALL BE 3-1/C NO. 2 WITH 1/C NO. 4 GROUND XLP TYPE USE CABLES IN A 1 1/2" UNIT DUCT INSTALLED IN GRADE. ALLOW 175 FT. OF CABLES IN UNIT DUCT FOR BIDDING PURPOSES. SEE DRAWING E-05 FOR CONTINUATION OF THIS TEMPORARY FEED.
5. PROVIDE A TEMPORARY POWER FEED FOR THE ROADWAY LIGHTING CIRCUITS FROM EXISTING TOWER ZAB2 TO TOWER ZAB3. THE FEED SHALL BE 3-1/C NO. 2 WITH 1/C NO. 4 GROUND XLP TYPE USE IN A 1 1/2" UNIT DUCT INSTALLED IN GRADE. ALLOW 240 FT. OF CABLES IN UNIT DUCT FOR BIDDING PURPOSES. THE FEED SHALL BE PROTECTED FROM DAMAGE FOR THE DURATION OF THE CONTRACT.
6. PROVIDE A PRECAST CONCRETE HEAVY DUTY HANDHOLE.
7. SAW CUT AND REMOVE THE EXISTING PAVEMENT TO INSTALL THE SERVICE CONDUIT. THE PAVEMENT SHALL BE RESTORED AND THE TRENCH FILLED PER CDOT STANDARD A-2-2A. THE WORK TO REMOVE AND RESTORE THE EXISTING PAVEMENT INCLUDING ALL MATERIALS, DISPOSAL AND BACKFILLING WILL NOT BE PAID FOR SEPARATE AND SHALL BE INCLUDED IN THE COST OF THE "UNDERGROUND CONDUIT, GALVANIZED STEEL, 3" DIA." PAY ITEM.

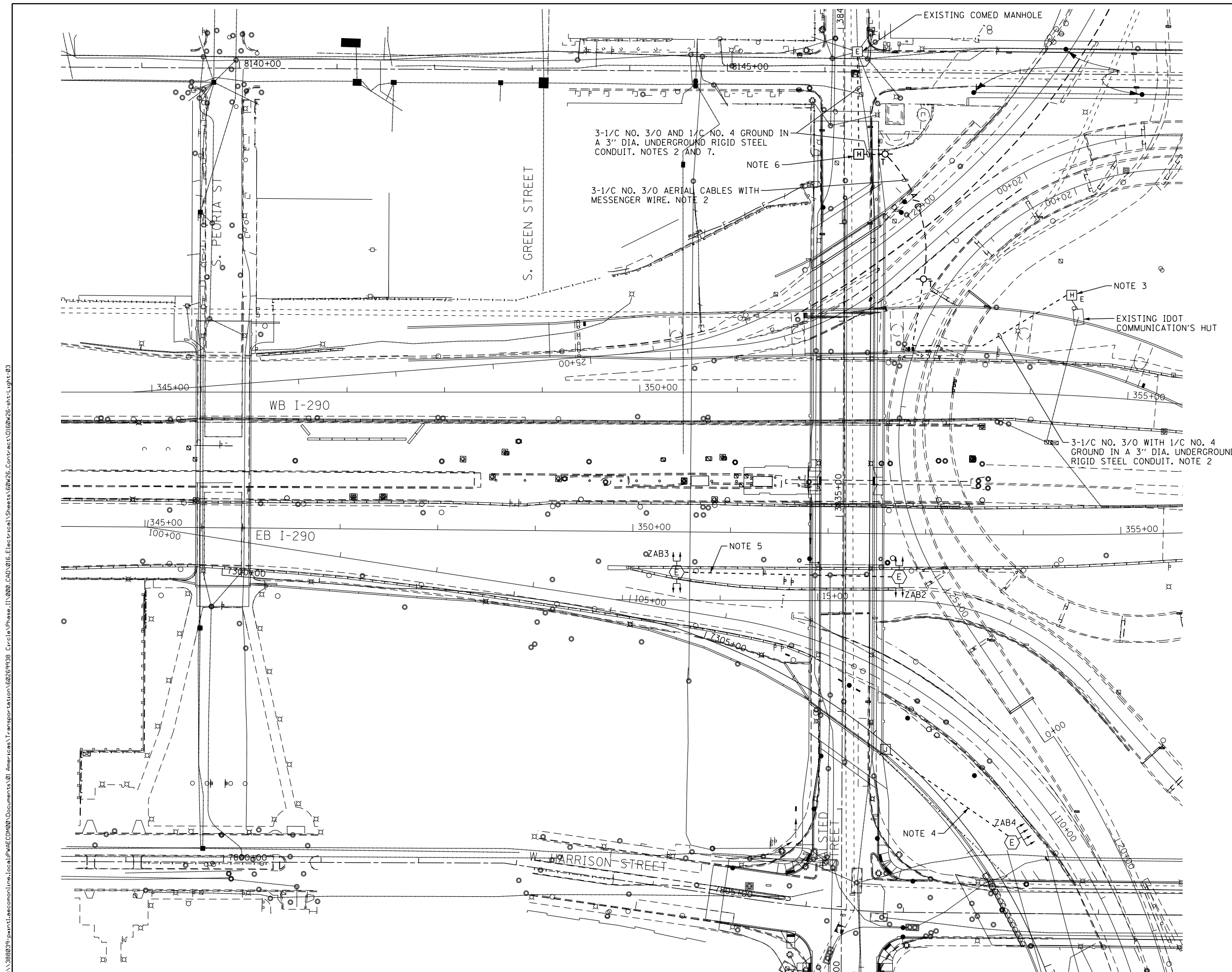

FILE PATH = p:\38803\pmt\escom\lme\local\p\AECOM\Documents\01\_Americas\Transportation\62629938\_Circle\Phase\_1\1000\_CAD\01E\_Electrical\Sheets\60W26\_sht-Light-03



D160W26-sht-Light-03  
 USER NAME = myersc  
 PLOT SCALE = 50.0000' / in.  
 PLOT DATE = 8/15/2013

DESIGNED - WDS	REVISED -
DRAWN - CAM	REVISED -
CHECKED - WDS	REVISED -
DATE - 8/20/13	REVISED -

**STATE OF ILLINOIS  
 DEPARTMENT OF TRANSPORTATION**

**I-290 TEMPORARY POWER PLAN**

SCALE: 1"=50'      SHEET 3 OF 22 SHEETS      STA.      TO STA.

F.A.I. RTE.	SECTION	COUNTY	TOTAL SHEETS	SHEET NO.
90/94/290	2013-008R	COOK	559	226
CONTRACT NO. 60W26				
ILLINOIS FED. AID PROJECT				