

NOTES:

1. SEE DRAWING E-01 FOR IDOT ELECTRICAL SYMBOLS.
2. ALL WORK SHOWN ON THIS DRAWING WILL BE COORDINATED WITH THE CITY OF CHICAGO'S OFFICE OF EMERGENCY MANAGEMENT AND COMMUNICATIONS (OEMC). OEMC CONTACT: FRANK KELLY 312-746-9238
3. ALL SPlicing OF PROPOSED OEMC CABLES IN EXISTING CITY MANHOLES WILL BE DONE BY OTHERS.
4. DRILL EXISTING MANHOLE TO ROUTE THE TEMPORARY OEMC CONDUITS INTO THE MANHOLE.
5. SAWCUT THE EXISTING PAVEMENT TO INSTALL THE TEMPORARY OEMC CONDUIT. THE PAVEMENT SHALL BE RESTORED AND THE TRENCH FILLED PER CDOT STANDARD A-2-2A. THE WORK TO REMOVE AND RESTORE THE EXISTING PAVEMENT INCLUDING MATERIALS, DISPOSAL AND BACKFILLING WILL NOT BE PAID FOR SEPARATELY AND SHALL BE INCLUDED IN THE COST OF THE "UNDERGROUND CONDUIT, PVC, 4" DIA. SCHEDULE 80 (CDOT)" PAY ITEM.
6. REMOVE AND RESTORE THE EXISTING SIDEWALK AS NEEDED TO INSTALL THE TEMPORARY OEMC CONDUIT. THE SIDEWALK SHALL BE RESTORED AND THE TRENCH FILLED PER CDOT STANDARDS. THE WORK TO REMOVE AND RESTORE THE EXISTING SIDEWALK INCLUDING ALL MATERIALS, DISPOSAL AND BACKFILLING WILL NOT BE PAID FOR SEPARATELY AND SHALL BE INCLUDED IN THE COST OF THE "UNDERGROUND CONDUIT, PVC, 4" DIA. SCHEDULE 80 (CDOT)" PAY ITEM.
7. THE 4-INCH DIAMETER SCHEDULE 80 PVC CONDUIT SHALL BE INSTALLED 10 FEET UP THE TEMPORARY WOOD POLE. THIS CONDUIT ATTACHED TO WOOD POLE SHALL BE MEASURED AND PAID FOR UNDER THE "UNDERGROUND CONDUIT, PVC, 4" DIA. SCHEDULE 80 (CDOT)" PAY ITEM.
8. PROVIDE 25 FEET OF SLOPE FOR EACH CABLE ON EACH TEMPORARY WOOD POLE TO ALLOW FOR FUTURE RELOCATION OF WOOD POLES DURING CONSTRUCTION.
9. INSTALL THE AERIAL CABLES A MINIMUM OF 45 FEET ABOVE FINISHED PAVEMENT AS MEASURED FROM THE LOWEST POINT OF THE CABLES' SAG.
10. SEE IDOT STANDARD DRAWING BE-800 FOR TEMPORARY LIGHT POLE INSTALLATION DETAILS. THE DETAILS FOR THE INSTALLATION OF THE TEMPORARY WOOD POLES AND AERIAL CABLES SHOWN ON THIS DRAWING ARE SIMILAR TO THE INSTALLATION DETAILS SHOWN ON BE-800.
11. THE COMMUNICATION CABLES SHALL BE SECURED TO THE WOOD POLES AT THE END OF EACH AERIAL CABLE RUN WITH A TETHER WIRE AND CLAMP AS DIRECTED BY THE ENGINEER AND OEMC.
12. CABLES INSTALLED IN CONDUIT WILL BE MEASURED AND PAID FOR UNDER THE "ELECTRIC CABLE AERIAL SUSPENDED, COMMUNICATION, NO. 19 100 PAIR" PAY ITEM.

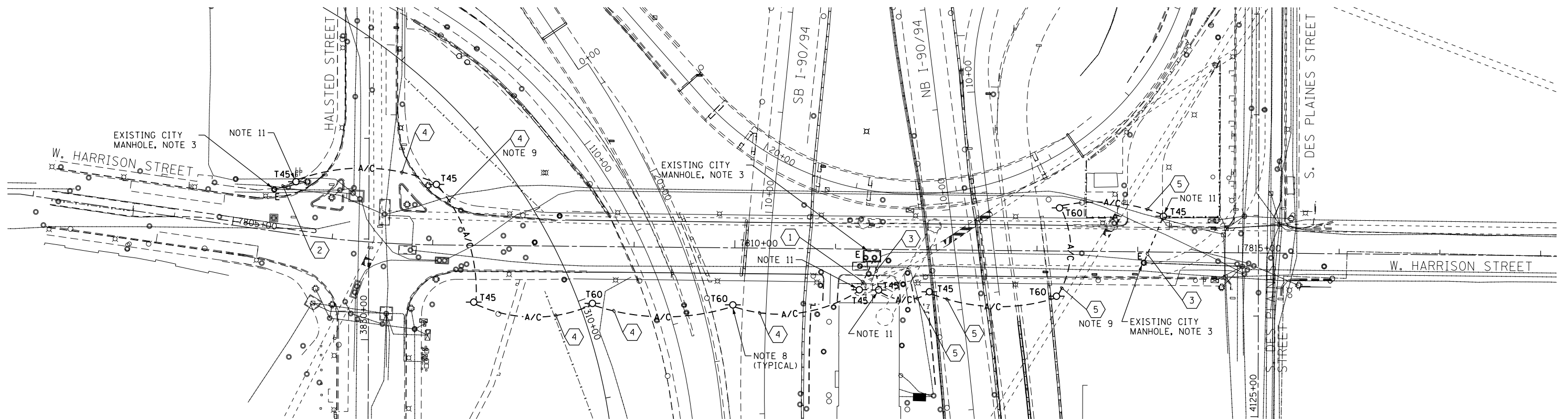

SYMBOLS (THIS DRAWING ONLY)

- TEMPORARY 45 FOOT WOOD POLE
- TEMPORARY 60 FOOT WOOD POLE

CABLE SCHEDULE

- 3-100 PAIR, 19 AWG, AERIAL COMMUNICATIONS CABLE INSTALLED IN 2-4" PVC (SCH. 80) CONDUITS UNDER PAVEMENT. SEE NOTES 5, 7 AND 12.
- 3-100 PAIR, 19 AWG, AERIAL COMMUNICATIONS CABLE INSTALLED IN 2-4" PVC (SCH. 80) CONDUITS UNDER SIDEWALK. SEE NOTES 6, 7 AND 12.
- 5-100 PAIR, 19 AWG, AERIAL COMMUNICATIONS CABLE INSTALLED IN 3-4" PVC (SCH. 80) CONDUITS UNDER PAVEMENT. SEE NOTES 5, 7 AND 12.
- 3-100 PAIR, 19 AWG, AERIAL COMMUNICATIONS CABLE INSTALLED ON TEMPORARY WOOD POLES AS SHOWN. SEE NOTE 10.
- 5-100 PAIR, 19 AWG, AERIAL COMMUNICATIONS CABLE INSTALLED ON TEMPORARY WOOD POLES AS SHOWN. SEE NOTE 10.

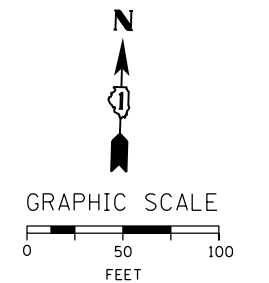

E-03A

FILE PATH = p:\38803\p\mt\ecom\line\local\FW\ECOM\00\Documents\01_Americas\Transportation\6269938_Circle\Phase_1\1000_CAD\016_Electrical\Sheets\60W26_sht-Light-03A



D160W26-sht-Light-03A
 USER NAME = myersc
 PLOT SCALE = 50.0000' / in.
 PLOT DATE = 9/12/2013

DESIGNED - WDS	REVISED -
DRAWN - CAM	REVISED -
CHECKED - WDS	REVISED -
DATE - 9/15/13	REVISED -

**STATE OF ILLINOIS
 DEPARTMENT OF TRANSPORTATION**

OEMC TEMPORARY WIRING PLAN - HARRISON STREET

SCALE: 1"=50' SHEET 3A OF 22 SHEETS STA. TO STA.

F.A.I. RTE. 90/94/290	SECTION 2013-008R	COUNTY COOK	TOTAL SHEETS 559	SHEET NO. 226A
CONTRACT NO. 60W26				ILLINOIS FED. AID PROJECT