

(1) JB, SS, 10"x8"x4" ATS  
 (2) 20 FT. OF 2" PVC COATED  
 G.S. CONDUIT ATS  
 SEE NOTE 4

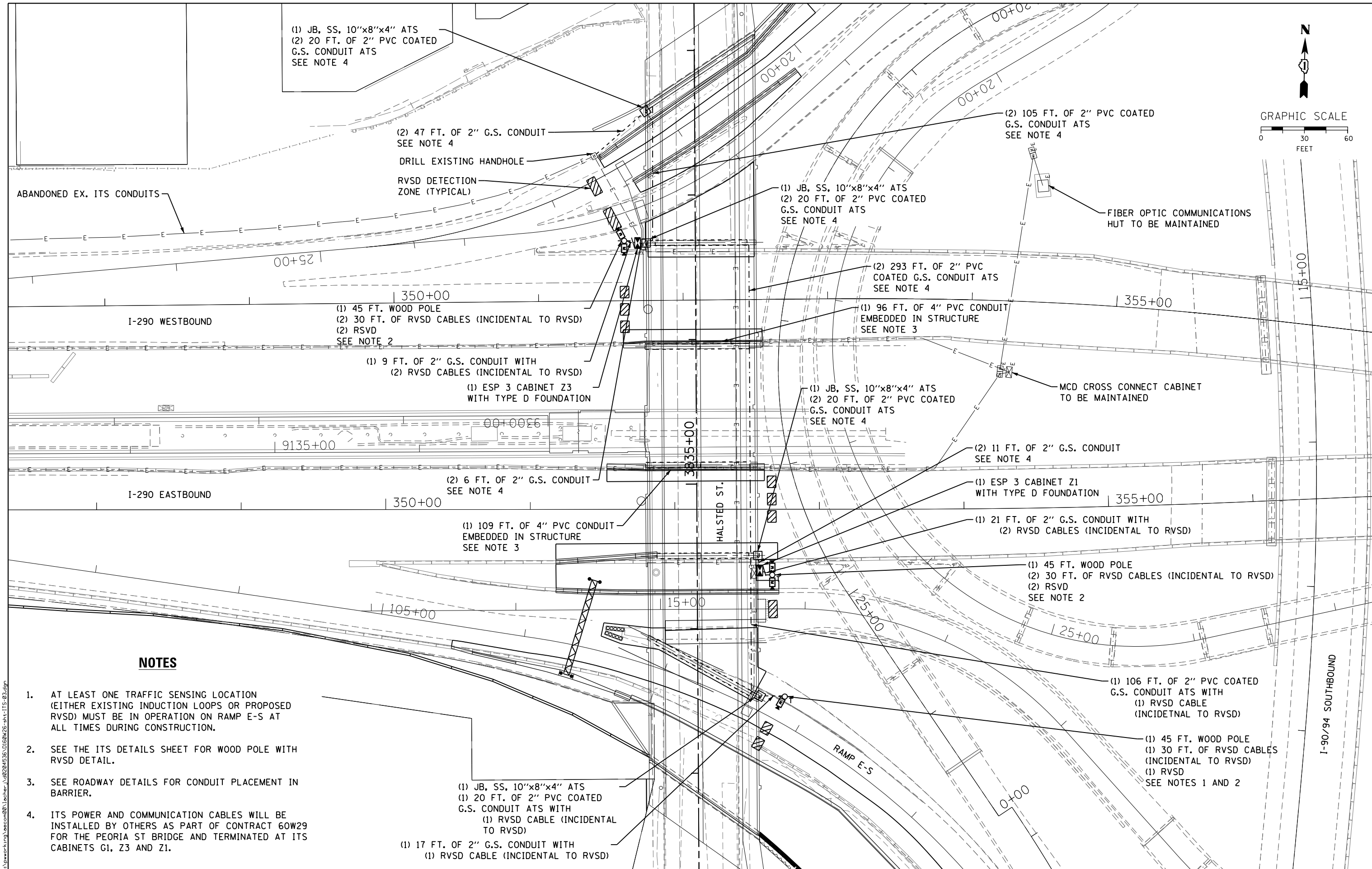
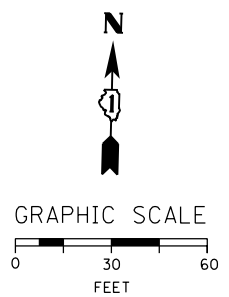

**NOTES**

1. AT LEAST ONE TRAFFIC SENSING LOCATION (EITHER EXISTING INDUCTION LOOPS OR PROPOSED RVSD) MUST BE IN OPERATION ON RAMP E-S AT ALL TIMES DURING CONSTRUCTION.
2. SEE THE ITS DETAILS SHEET FOR WOOD POLE WITH RVSD DETAIL.
3. SEE ROADWAY DETAILS FOR CONDUIT PLACEMENT IN BARRIER.
4. ITS POWER AND COMMUNICATION CABLES WILL BE INSTALLED BY OTHERS AS PART OF CONTRACT 60W29 FOR THE PEORIA ST BRIDGE AND TERMINATED AT ITS CABINETS G1, Z3 AND Z1.

(1) JB, SS, 10"x8"x4" ATS  
 (1) 20 FT. OF 2" PVC COATED  
 G.S. CONDUIT ATS WITH  
 (1) RVSD CABLE (INCIDENTAL  
 TO RVSD)  
 (1) 17 FT. OF 2" G.S. CONDUIT WITH  
 (1) RVSD CABLE (INCIDENTAL TO RVSD)

FILE PATH = c:\pwworking\aecom\001\lecter\102284536\0160W26-sht-ITS-03.dgn



D160W26-sht-ITS-03.dgn  
 USER NAME = locherj  
 PLOT SCALE = 30.0000 ' / in.  
 PLOT DATE = 9/11/2013

DESIGNED - JML	REVISED -
DRAWN - JML	REVISED -
CHECKED - WDS	REVISED -
DATE - 9/15/13	REVISED -

**STATE OF ILLINOIS  
 DEPARTMENT OF TRANSPORTATION**

**ITS PLANS - HALSTED STREET  
 PROPOSED ITS**

SCALE: 1" = 30' SHEET 3 OF 5 SHEETS STA. TO STA.

F.A.I. RTE.	SECTION	COUNTY	TOTAL SHEETS	SHEET NO.
90/94/290	2013-008R	COOK	559	248
CONTRACT NO. 60W26				
ILLINOIS FED. AID PROJECT				