

**ELEVATION**

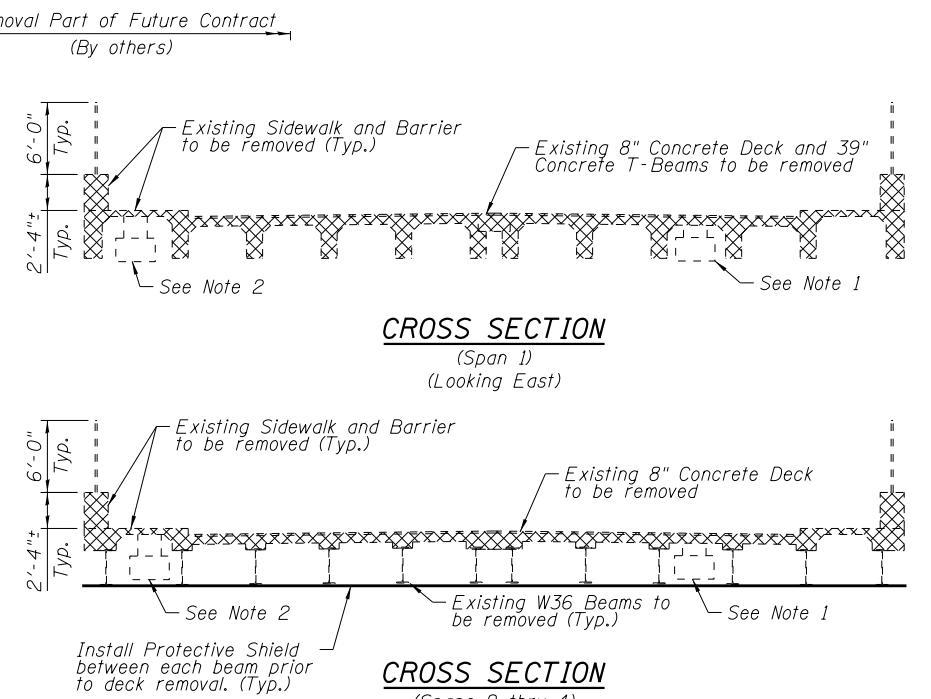

**CROSS SECTION**  
(Span 1)  
(Looking East)

**CROSS SECTION**  
(Spans 2 thru 4)  
(Looking East)

**NOTES:**

1. Existing Utility between girders to be relocated (By Others) prior to bridge demolition. Utility to be placed back on proposed bridge (By Others).
2. Existing Utility to be removed and replaced as part of this contract. (See Electrical Plans for details)
3. See Civil Plans for roadway barrier removal under the structure, along ramps and I-90/94.
4. Work this sheet with sheets S1-05 and S1-06.
5. For Temporary Soil Retention and Soil Retention System limits see sheet S1-07.
6. Reference sheets AS-1 thru AS-62 for existing bridge dimensions and details.
7. The Contractor shall take precautions to protect existing utilities and foundations during construction of the bridge. The utilities were located based on SUE and utility supplier information available at design.
8. The approach slab removal will be included in civil pay item "Pavement Removal", see Civil Plans for details.

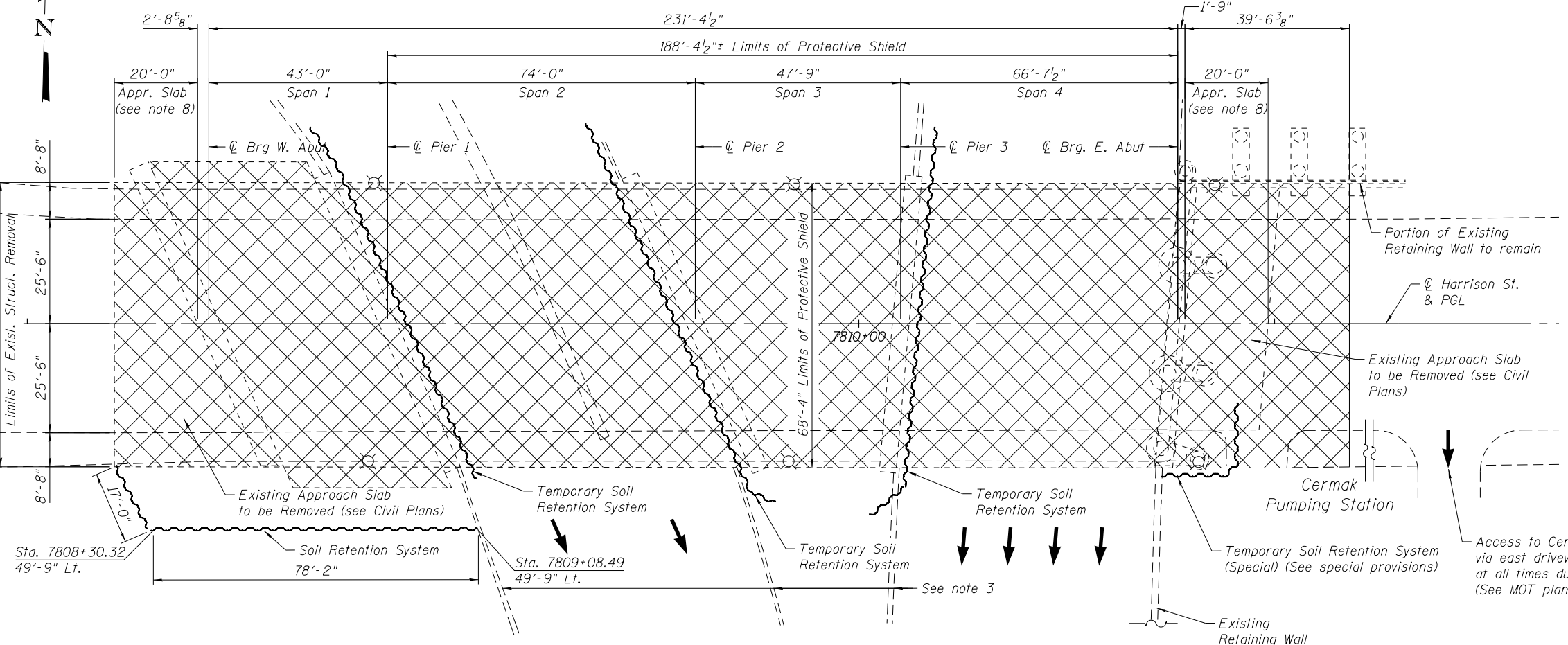

**PLAN**

**LEGEND:**

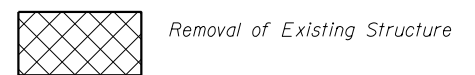

USER NAME = dunkerleyb	DESIGNED - EJO	REVISED
	CHECKED - ATB	REVISED
PLOT SCALE = N.T.S.	DRAWN - MRK	REVISED
PLOT DATE = 9/15/2013	CHECKED - EJO	REVISED

**STATE OF ILLINOIS  
DEPARTMENT OF TRANSPORTATION**

**EXISTING STRUCTURAL REMOVAL (1 OF 3)  
STRUCTURE NO. 016-1713**

F.A.I. RTE.	SECTION	COUNTY	TOTAL SHEETS	SHEET NO.
90/94/290	2013-008R	COOK	559	254
CONTRACT NO.			60W26	
ILLINOIS FED. AID PROJECT				

SHEET NO. S1-04 OF S1-48 SHEETS

0161713-60W26-S04-Removal