

PIER ELEVATION
(Looking North)

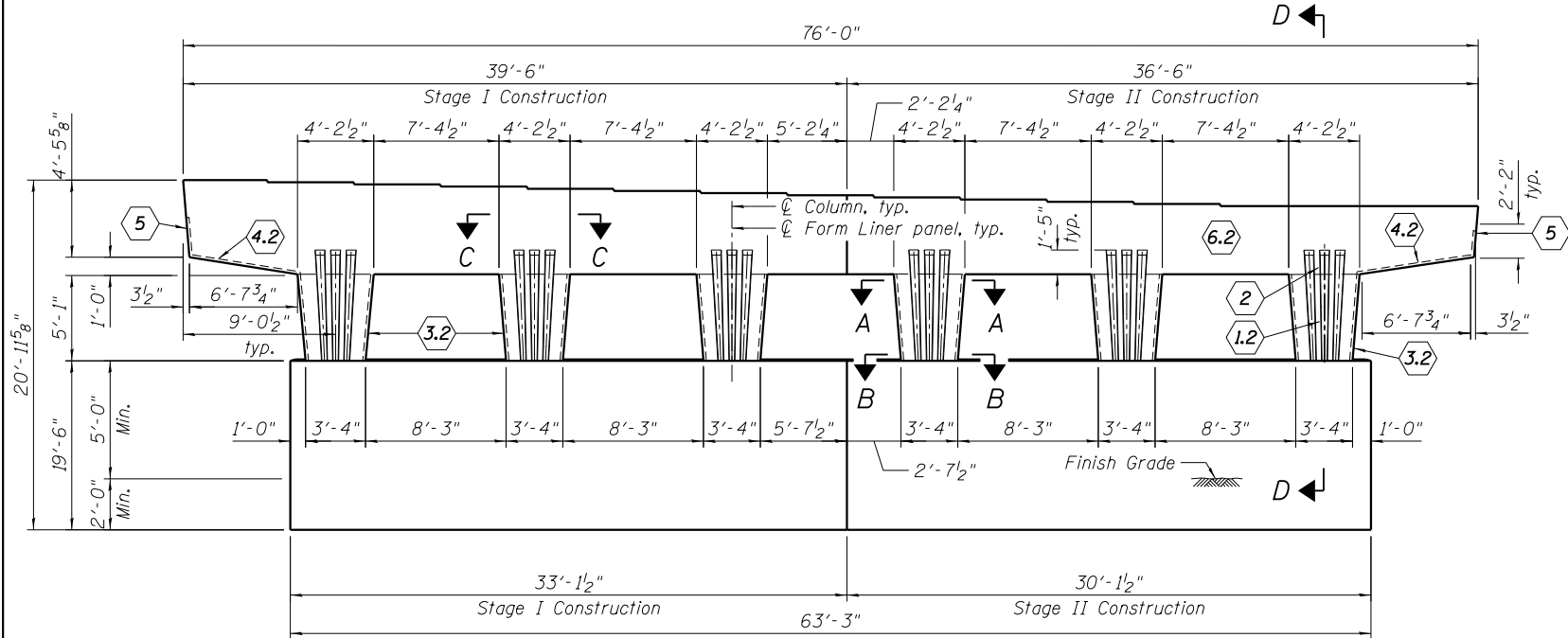

PIER ELEVATION
(Looking South)

LEGEND

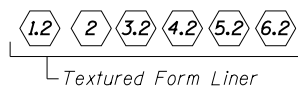

- Notes:
1. Alternate: For surface indicated as Textured Form Liner (6.2), Contractor can chose to build large protrusion directly into these forms if a smooth uniform surface can be provided.
 2. Tapered fluting - dimensions vary, see elevation profile.
 3. Form liner panel (2) is continuation of panel (1.2). Keep adjacent form liners aligned.
 4. Hand clean and smooth the surface of the construction joint between the pier and cap.
 5. Texture 1: Light Sandblast as selected from manufacturer's standard pattern selection. Texture 2: Smooth

BILL OF MATERIAL

Item	Unit	Total
Form Liner Textured Surface	Sq. Ft.	558

PIER END VIEW

(Looking East)
(Looking West - Sim.)

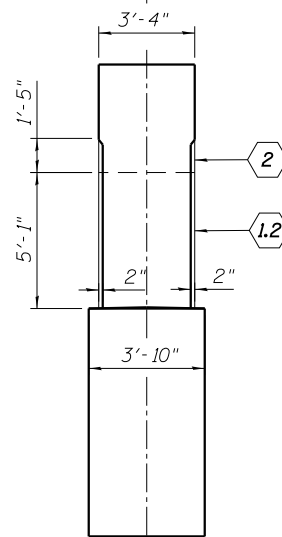

SECTION D-D

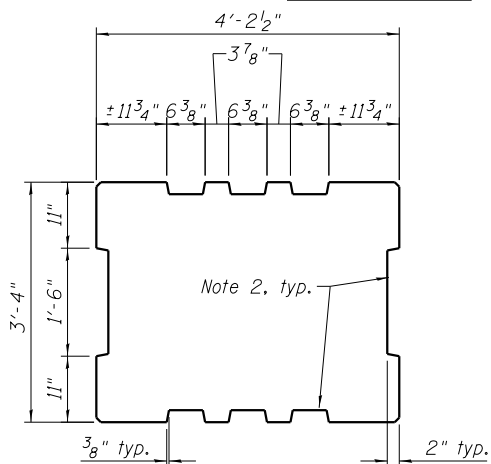

SECTION A-A
At Top of Column

FORM LINER PANEL 1.2 & 2

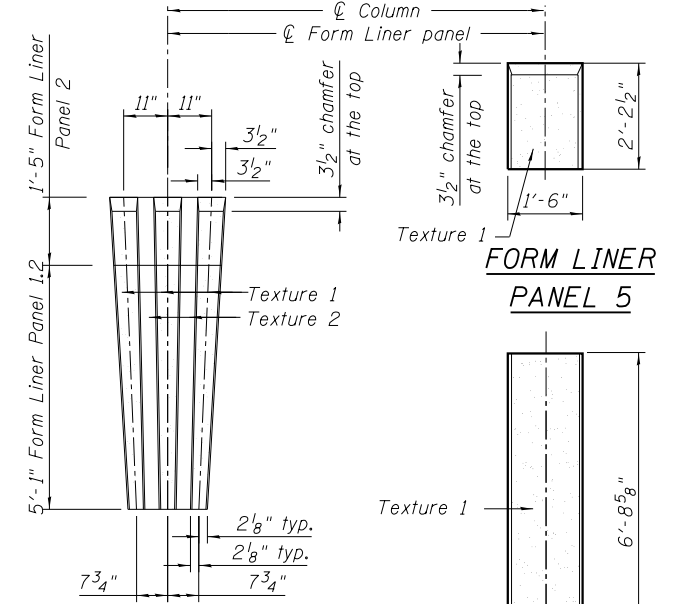

SECTION E-E

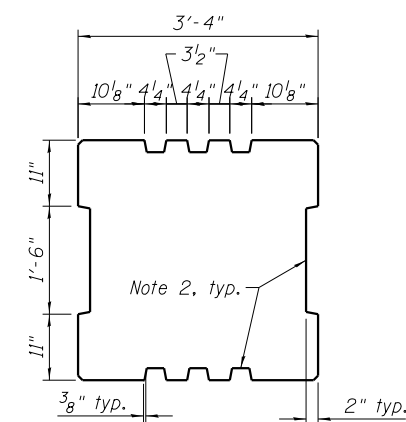

SECTION B-B
At Bottom of Column

SECTION C-C
In Cap

4:33:52 PM 0161716-60W26-S063-Pier.dgn



USER NAME = rlschultz	DESIGNED - MDS	REVIS
CHECKED - JRM	CHECKED - JRM	REVIS
PLOT SCALE = 5:4.0006 '1' / in.	DRAWN - RLS	REVIS
PLOT DATE = 9/15/2013	CHECKED - MDS	REVIS

STATE OF ILLINOIS
DEPARTMENT OF TRANSPORTATION

PIER 2 ARCHITECTURAL DETAILS
STRUCTURE NO. 016-1716

SHEET NO. S2-63 OF S2-81 SHEETS

F.A.U. R.E.	SECTION	COUNTY	TOTAL SHEETS	SHEET NO.
3730	2013-008R	COOK	559	423
CONTRACT NO.			60W26	
ILLINOIS FED. AID PROJECT				