

PIER ELEVATION (Looking North)

PIER END VIEW (Looking East) (Looking West - Sim.)

FORM LINER PANEL 1.5 & 2

FORM LINER PANEL 5

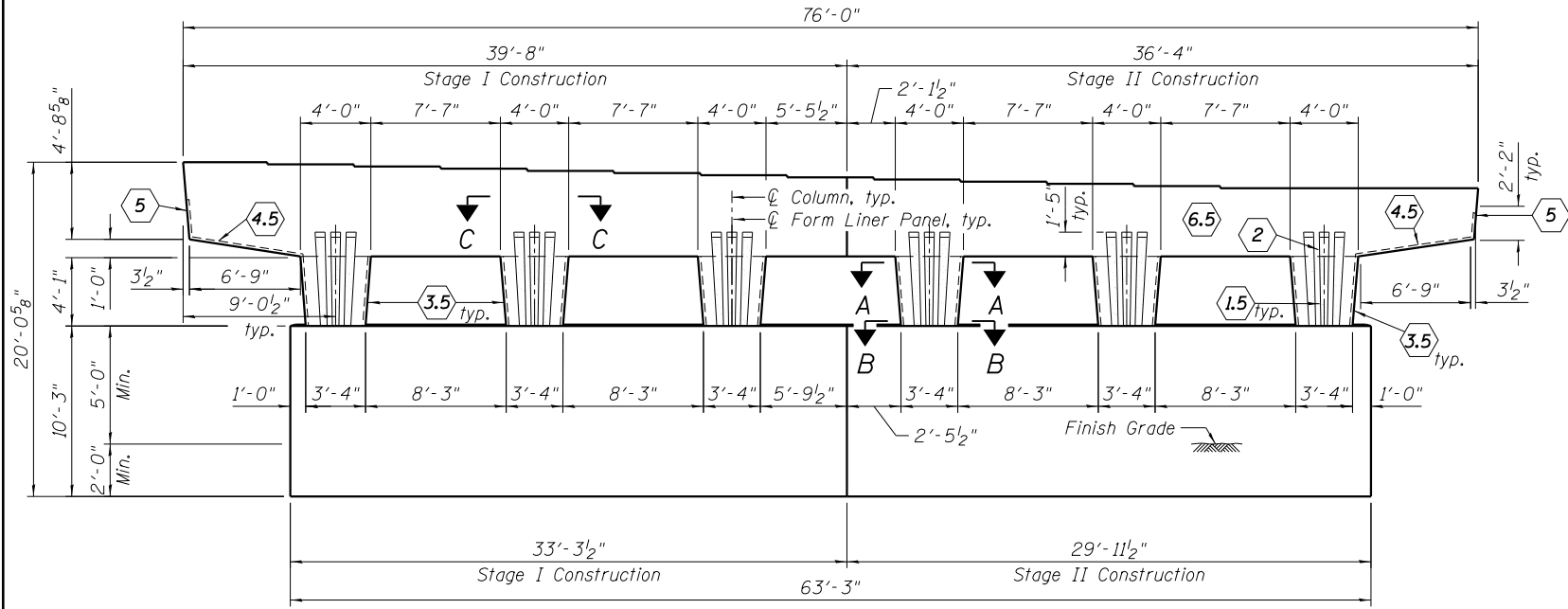

PIER ELEVATION (Looking South)

SECTION D-D

SECTION E-E

FORM LINER PANEL 4.5

FORM LINER PANEL 3.5

LEGEND

1.5, 2, 3.5, 4.5, 5, 6.5

Textured Form Liner

- Notes:
- Alternate: For surface indicated as Textured Form Liner (6.5), Contractor can chose to build large protrusion directly into these forms if a smooth uniform surface can be provided.
 - Tapered fluting - dimensions vary, see elevation profile.
 - Form liner panel (2) is continuation of panel (1.5). Keep adjacent form liners aligned.
 - Hand clean and smooth the surface of the construction joint between the pier and cap.
 - Texture 1: Light Sandblast as selected from manufacturer's standard pattern selection. Texture 2: Smooth

BILL OF MATERIAL

Item	Unit	Total
Form Liner Textured Surface	Sq. Ft.	466

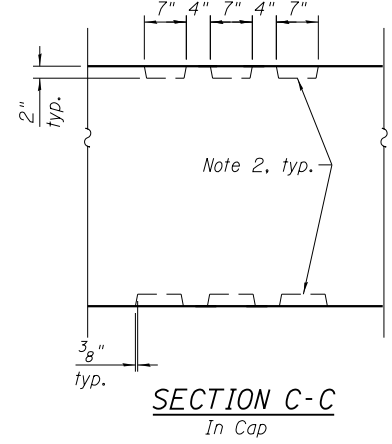
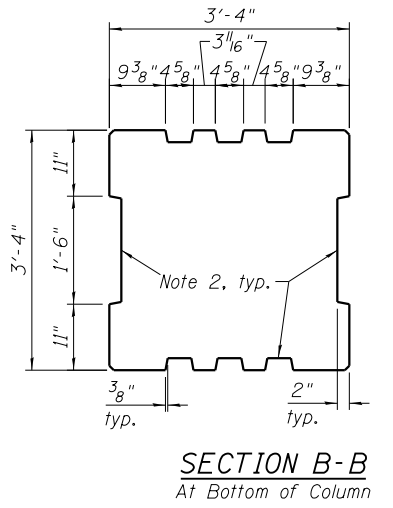
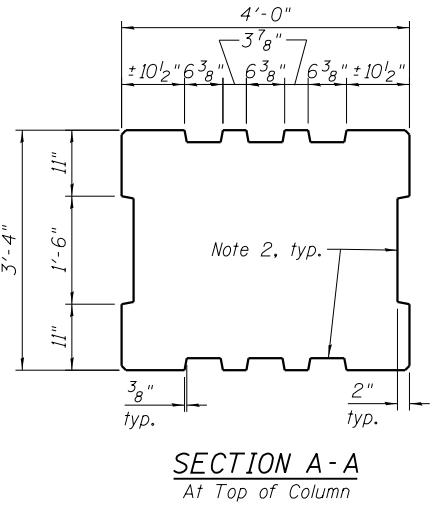

4:34:04 PM 0161716-60W26-S072-Pier.dgn



USER NAME = rlschultz	DESIGNED - MDS	REVIS
PLOT SCALE = 5:4.0006 ' / in.	CHECKED - JRM	REVIS
PLOT DATE = 9/15/2013	DRAWN - RLS	REVIS
	CHECKED - DL	REVIS

STATE OF ILLINOIS
DEPARTMENT OF TRANSPORTATION

PER 5 ARCHITECTURAL DETAILS
STRUCTURE NO. 016-1716

SHEET NO. S2-72 OF S2-81 SHEETS

F.A.U. RTE. 3730	SECTION 2013-008R	COUNTY COOK	TOTAL SHEETS 559	SHEET NO. 432
CONTRACT NO. 60W26			ILLINOIS FED. AID PROJECT	