

DATE	
BY	
FINAL SURVEY	SURVEYED
NOTE BOOK	PLOTTED
NO.	TEMPLATE
	AREAS CHECKED

DATE	
BY	
ORIGINAL SURVEY	SURVEYED
NOTE BOOK	PLOTTED
NO.	TEMPLATE
	AREAS CHECKED

FILE PATH = p:\38803\p\m\asc\com\line\local\p\w\ec\000\Documents\01_Americas\Transportation\62629938_Circle\Phase_1\1000_CDD_006_Roadway\Sheets\60W26_Contract\0160W26-sht-XS-HAR.dgn

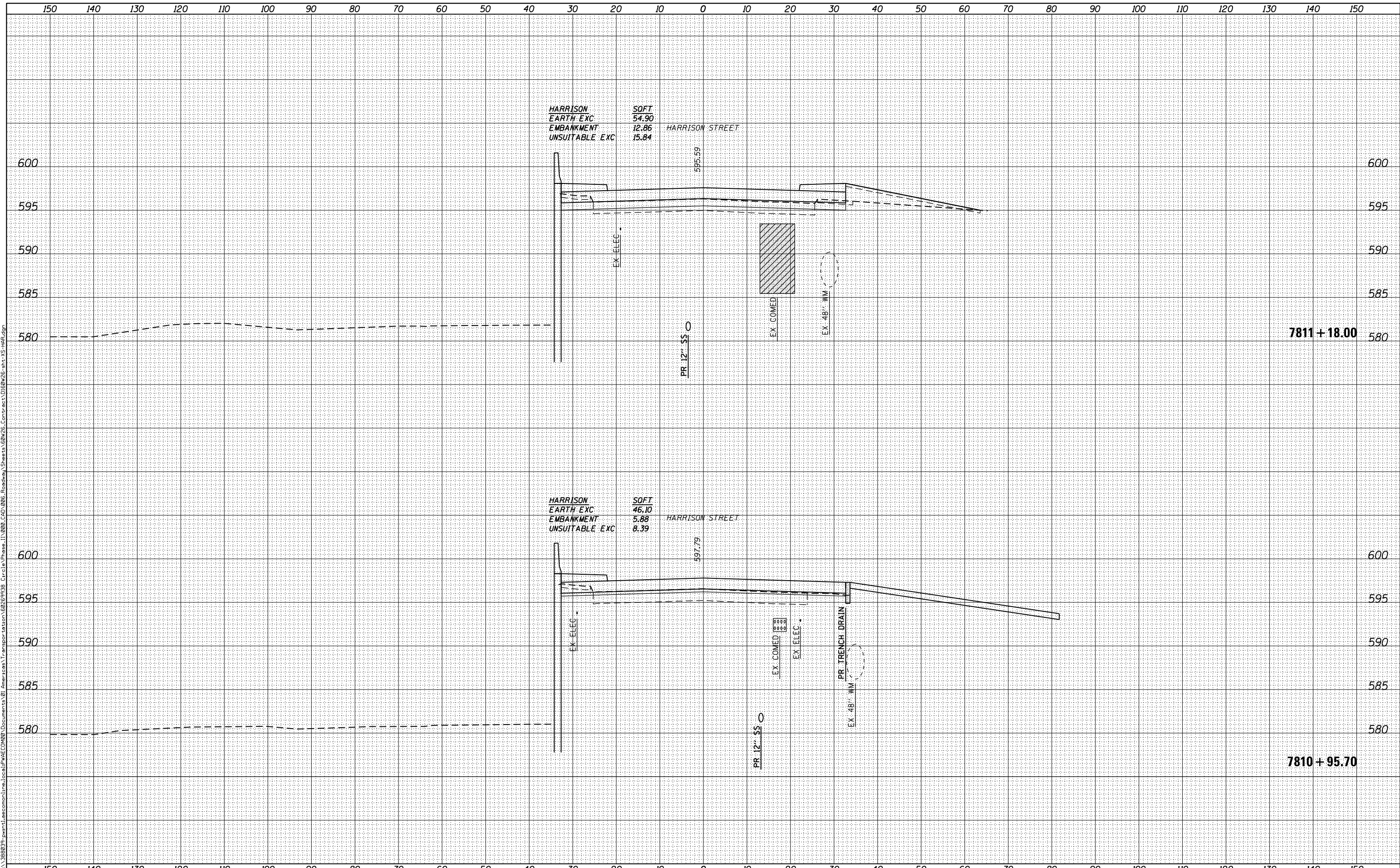

D160W26-sht-XS-HAR.dgn	DESIGNED - OPS	REVISED -
USER NAME = PATELP2	DRAWN - OPS	REVISED -
PLOT SCALE = 10.0000' / 1"	CHECKED - DBM	REVISED -
PLOT DATE = 8/19/2013	DATE - 08/20/13	REVISED -

STATE OF ILLINOIS
DEPARTMENT OF TRANSPORTATION

HARRISON STREET CROSS SECTION

SCALE: 1:5V,1:10H SHEET 31 OF 41 SHEETS STA. 7810+95.70 TO STA. 7811+18.00

F.A.I. RTE.	SECTION	COUNTY	TOTAL SHEETS	SHEET NO.
90/94/290	2013-007R	COOK	559	549
CONTRACT NO. 60W25				
ILLINOIS FED. AID PROJECT				