

Bench Mark: A "1" cut in the SE anchor bolt at the 11th street light N. of Roosevelt on the W. side of Halsted Elev. = 594.06

Existing Structure: SN 016-2081. Constructed in 1950 under F.A. Route 131, Section 2525.1-2B. The bridge was extended to the south and north in 1958 under Section 2525.2-3B. Seven span bridge that measures 436'-11 1/8" from back to back of abutments. Out-to-out width of 69'-4". The spans are supported by 36" wide flange steel I-beams. Substructure is reinforced concrete closed abutments and multi-column piers founded on timber piles or drilled shafts. The existing bridge is to be removed and replaced.

Traffic to be maintained utilizing Staged Construction.

No Salvage.

LOADING HL-93

Allow 50#/sq. ft. for future wearing surface.

DESIGN SPECIFICATIONS

2012 AASHTO LRFD Bridge Design Specifications
6th Edition, with 2013 Interim Revisions

DESIGN STRESSES

FIELD UNITS

f_c = 3,500 psi
f_y = 60,000 psi (Reinforcement)
f_y = 50,000 psi (M270 Grade 50)
f_y = 36,000 psi (M270 Grade 36)

SEISMIC DATA

Seismic Performance Zone (SPZ) = 1
Design Spectral Acceleration at 1.0 sec. (S_{D1}) = 0.085g
Design Spectral Acceleration at 0.2 sec. (S_{D5}) = 0.144g
Soil Site Class = D

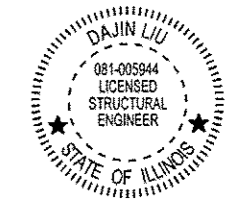
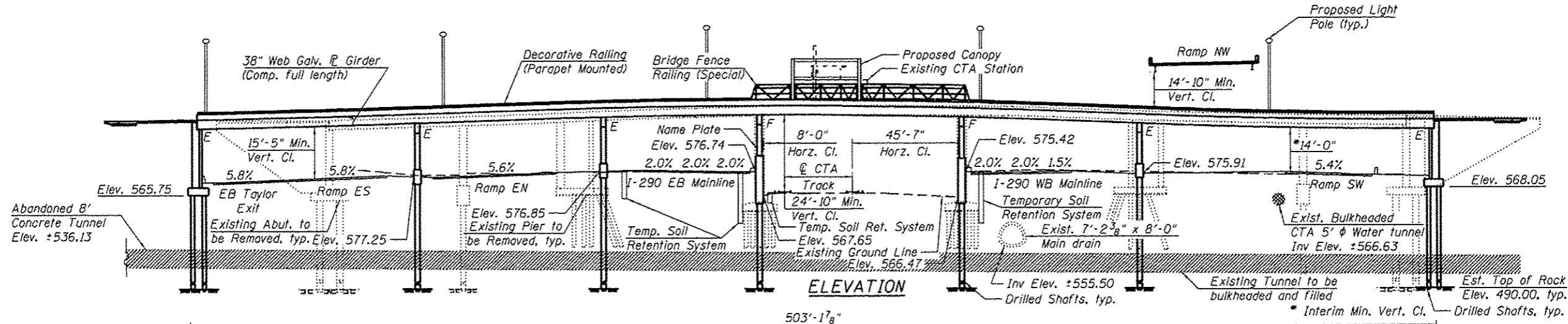

Dajin Liu
DAJIN LIU, P.E., S.E.
NO. 081-005944
EXP. DATE 11/30/2014

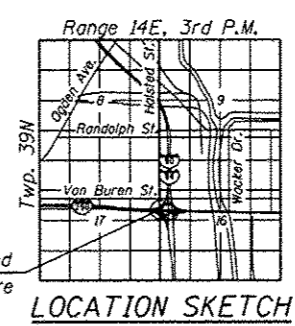
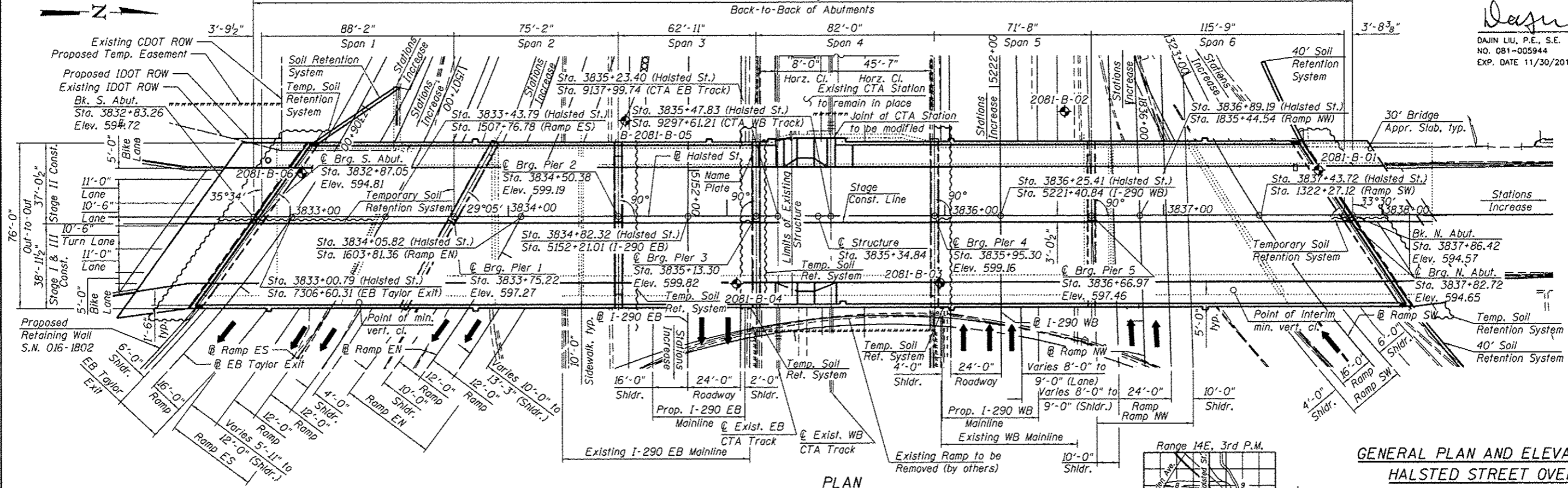

GENERAL PLAN AND ELEVATION
HALSTED STREET OVER
F.A.I. RTE. 290
(EISENHOWER EXPRESSWAY) AND CTA
F.A.U. RTE. 3730 - SECTION 2013-008R
COOK COUNTY
STATION 3835+34.84
STRUCTURE NO. 016-1716

Note: For Limits of Protective Shield, see Sheet S2-12 of S2-81.

APPROVED
For Structural Adequacy Only

P. Carl Peyer, S.E.
Engineer of Bridges & Structures

14:40:05 PM
0161716-60W26-S001-GPE.dgn



USER NAME = rtschultz	DESIGNED - KAH	REVISED
CHECKED - DL	REVISED	
PLOT SCALE = 48:0' = 1"	DRAWN - RLS/MTS	REVISED
PLOT DATE = 8/19/2013	CHECKED - DL	REVISED

STATE OF ILLINOIS
DEPARTMENT OF TRANSPORTATION

SHEET NO. S2-01 OF S2-81 SHEETS

F.A.U. RTE. 3730	SECTION 2013-008R	COUNTY COOK	TOTAL SHEETS 559	SHEET NO. 361
CONTRACT NO. 60W26			ILLINOIS FEEDBACK PROJECT	