

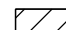

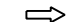

**MAINTENANCE OF TRAFFIC LEGEND**

-  WORK ZONE
-  DIRECTION OF TRAVEL
-  DRUM W/ STEADY BURN LIGHT AT 40' SPACING (20' ON LANE TAPER)
-  TEMPORARY CONCRETE BARRIER
-  TEMPORARY PAVEMENT
-  TEMPORARY PAVEMENT MARKING 24" (WHITE) - STOP BAR
-  FLAGGER

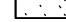

ALL PAVEMENT MARKINGS SHOWN ARE PERMANENT MARKINGS UNLESS OTHERWISE NOTED. SEE PAVEMENT MARKING PLAN.

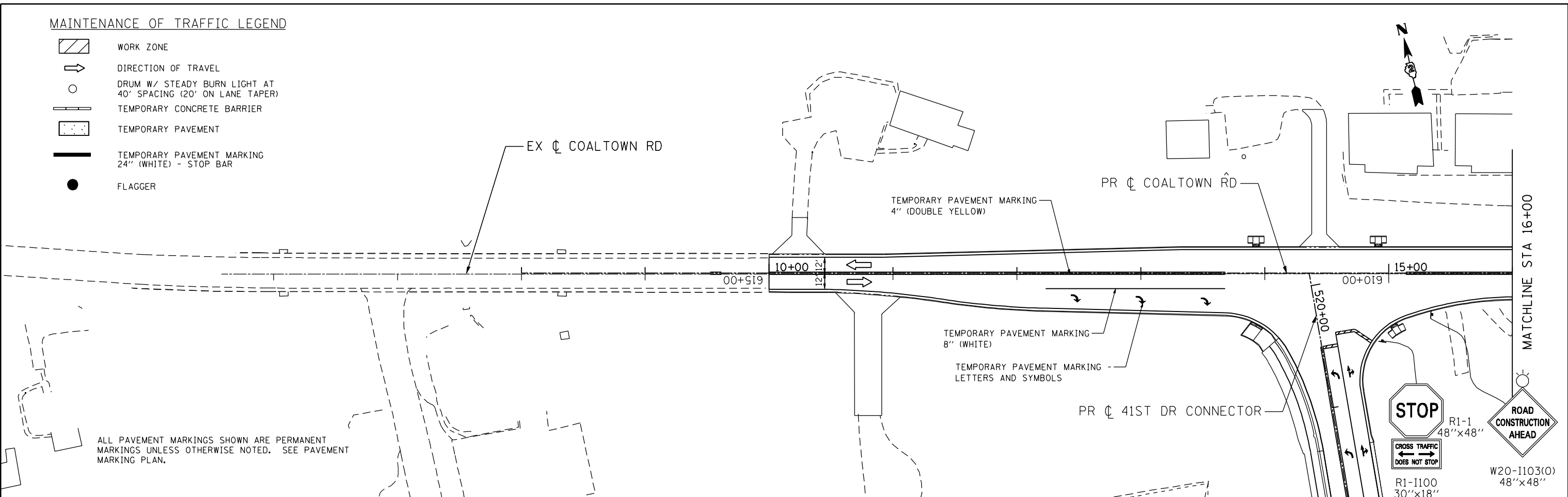
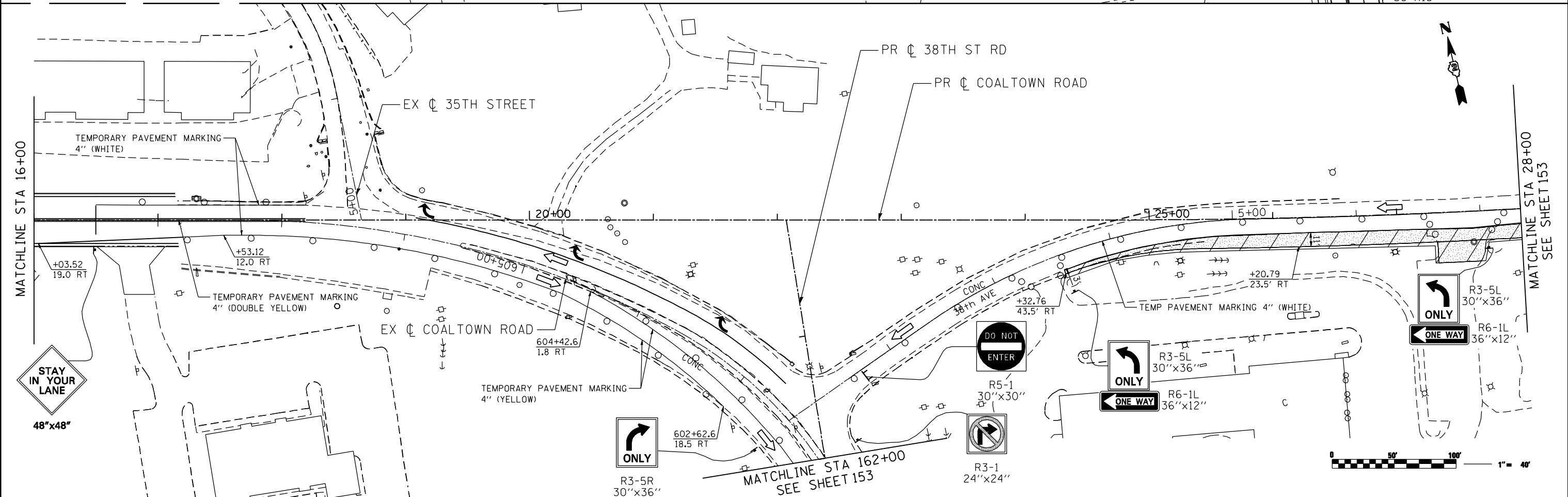

FILE NAME: c:\projects\080319108\contract\1\design\DOT\Sheet Files\0264884-int-Stage 5B.dwg

**Ciorba Group, Inc.**  
 CONSULTING ENGINEERS  
 6507 North Cumberland Avenue, Suite 402  
 Chicago, Illinois 60656  
 Tel. 773.776.4009 Fax 773.776.4014

USER NAME = espino	DESIGNED -	REVISED -
PLOT SCALE = 88.0000 "/>		
PLOT DATE = 3/11/2013	CHECKED -	REVISED -
DATE = 3/11/2013	REVISIONS -	

**STATE OF ILLINOIS**  
**DEPARTMENT OF TRANSPORTATION**

**MAINTENANCE OF TRAFFIC - STAGE 5B**  
**COALTOWN ROAD**

F.A.P. RTE.	SECTION	COUNTY	TOTAL SHEETS	SHEET NO.
595	(142-1)R & 142-1)B	ROCK ISLAND	507	152
CONTRACT NO. 64B84			ILLINOIS FED. AID PROJECT	

SCALE: SHEET NO. OF SHEETS STA. TO STA.