

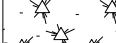







EROSION CONTROL LEGEND

-  MULCH, METHOD 2 AND TEMPORARY SEEDING
-  MULCH, METHOD 3 AND TEMPORARY SEEDING
-  TEMPORARY EROSION CONTROL BLANKET AND TEMPORARY SEEDING
-  INLET & PIPE PROTECTION OR INLET PROTECTION, SPECIAL
-  INLET FILTER
-  TEMPORARY DITCH CHECKS
-  PERIMETER EROSION BARRIER
-  TREE PROTECTION (PAID AS TEMPORARY FENCE)

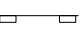

PROJECT/IMPROVEMENT BEGINS STA 10+00.00

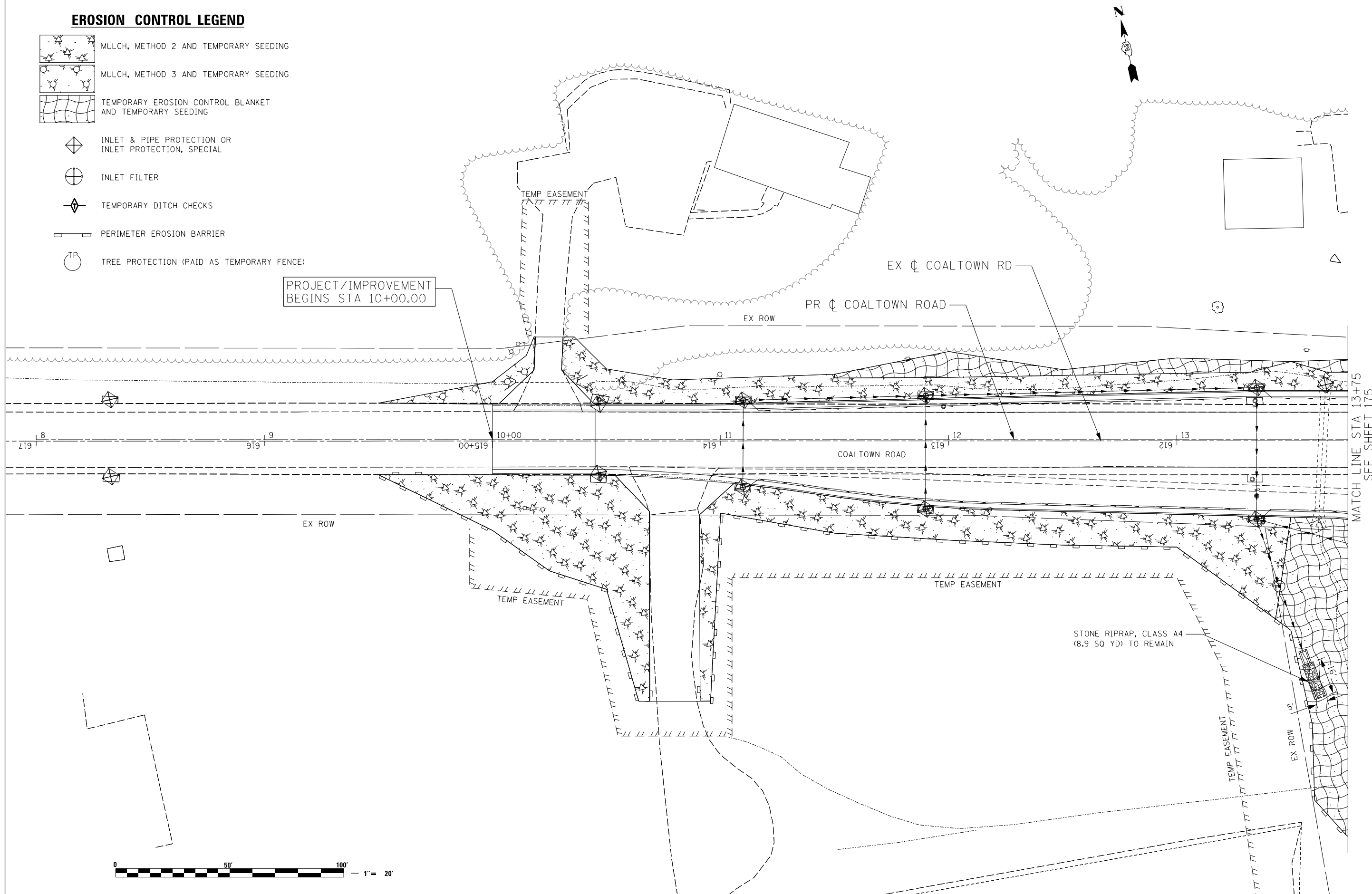
MATCH LINE STA 13+75
SEE SHEET 175



Lin Engineering, Ltd.
Consulting Engineers
Springfield, Illinois

USER NAME = Plotted by LinZl	DESIGNED - RWK	REVISED -
DRAWN - RWK	REVISIONS -	
PLOT SCALE = 40.0000' / in.	CHECKED - ST	REVISED -
PLOT DATE = 3/11/2013	DATE - 3/11/2013	REVISED -

**STATE OF ILLINOIS
DEPARTMENT OF TRANSPORTATION**

**COALTOWN ROAD
TEMPORARY EROSION CONTROL**

SCALE: 1"=20' SHEET NO. 13 OF 17 SHEETS STA. 10+00 TO STA. 13+75

F.A.P. RTE.	SECTION	COUNTY	TOTAL SHEETS	SHEET NO.
595	(142-11R-1, 142-11B)	ROCK ISLAND	507	174
CONTRACT NO. 64B84				
FED. ROAD DIST. NO. 2 ILLINOIS FED. AID PROJECT				