

INTERCONNECTION BILL OF MATERIALS

DESCRIPTION	UNIT	TOTAL QUANTITY
UNDERGROUND CONDUIT, COILABLE NONMETALLIC CONDUIT, 2" DIA.	FOOT	1843
CONDUIT EMBEDDED IN STRUCTURE, 2" DIA., PVC	FOOT	1087
JUNCTION BOX, STAINLESS STEEL, EMBEDDED IN STRUCTURE, 12"x10"x6"	EACH	6
HANDHOLE, COMPOSITE CONCRETE	EACH	8
ELECTRIC CABLE IN CONDUIT, COMMUNICATION NO. 18 3 PAIR	FOOT	3541

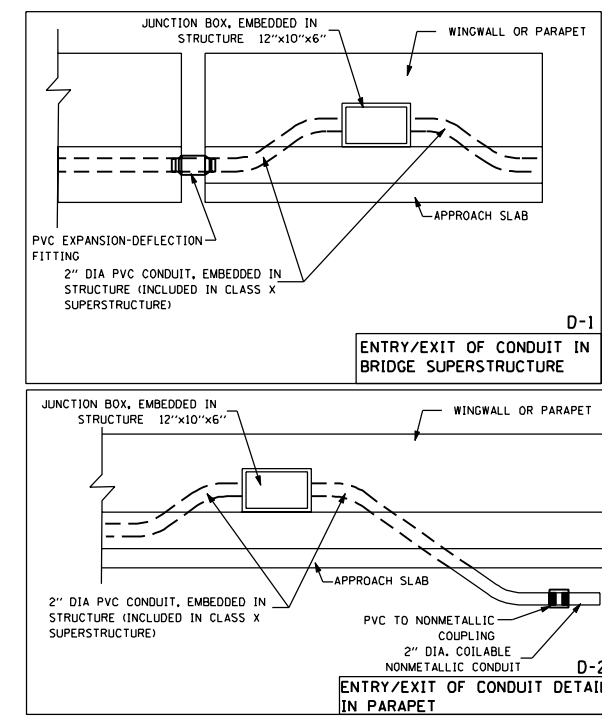
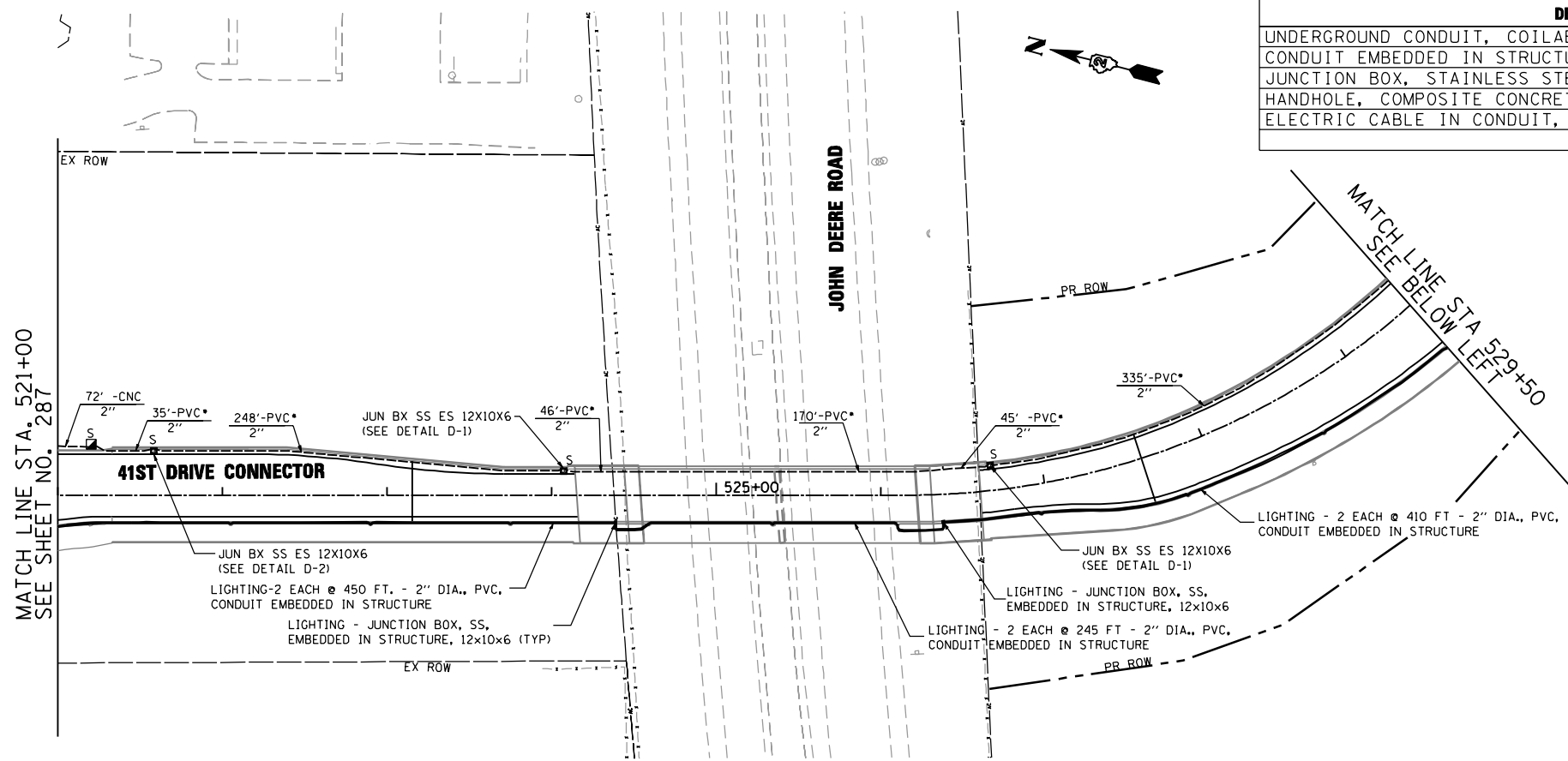

INTERCONNECT PLAN LEGEND

- CONTROLLER
- MASTER CONTROLLER
- DOUBLE HANDHOLE
- HANDHOLE
- HEAVY DUTY HANDHOLE
- PROPOSED UNDERGROUND CONDUIT/CABLE
- INTERSECTION
- SYSTEM
- EXISTING UNDERGROUND CONDUIT
- LIGHTING - UNDERGROUND CONDUIT, COILABLE, NONMETALLIC, PVC

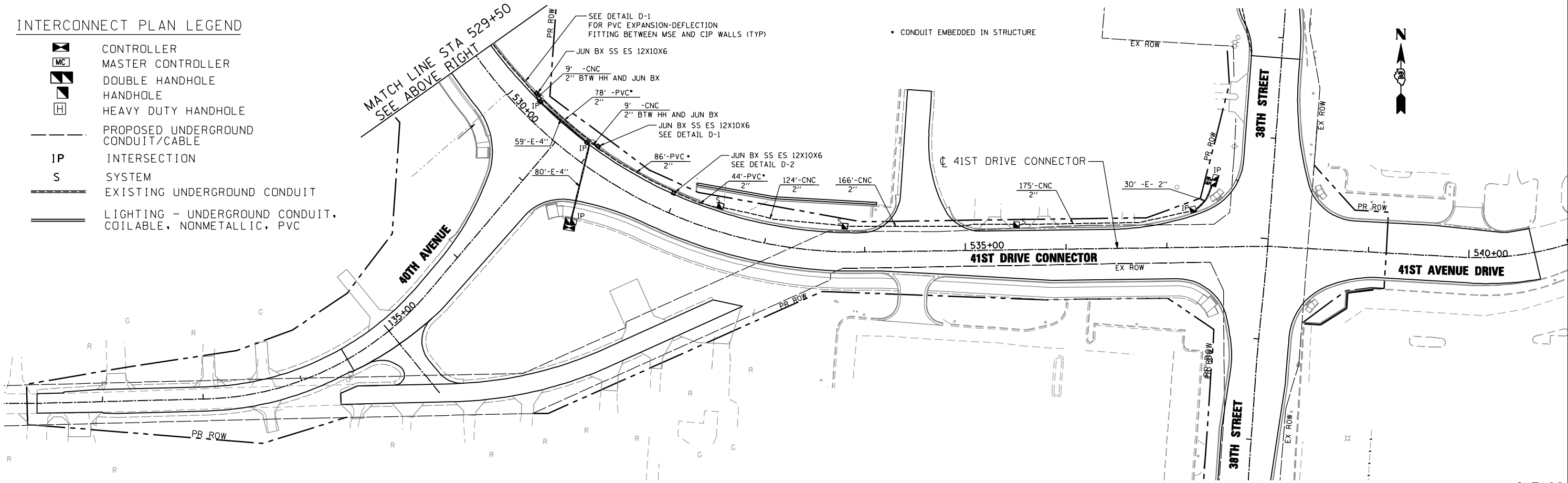

2600 Warrenville Road, Suite 203, Downers Grove, IL 60515
 630.705.0110 voice, 630.839.3566 fax
 www.mps-il.com
MILLENNIA PROFESSIONAL SERVICES

DESIGNED - TVN	REVISED -
DRAWN - CJD	REVISED -
CHECKED - RPD	REVISED -
DATE - 3/12/2013	REVISED -

**STATE OF ILLINOIS
 DEPARTMENT OF TRANSPORTATION**

**F.A.P. 595 (JOHN DEERE ROAD)
 INTERCONNECTION PLAN**

SCALE: 1"=50' SHEET NO. OF SHEETS STA. TO STA.

INT-02

F.A.P. RTE.	SECTION	COUNTY	TOTAL SHEETS	SHEET NO.
595	(142-1JR & 142-1HB)	ROCK ISLAND	507	288
CONTRACT NO. 64B84				

FED. ROAD DIST. NO. 1 ILLINOIS FED. AID PROJECT
 P:\2011\ME11008_PTB155-26_IL5_JDR_C1orba\CADD\Shts\0264B84-sht-INT02.dgn