

I:\PROJECTS\081-7002\STRUCTURE\1\CAD\Retaining Wall 081-7002\081-7002_04.dgn

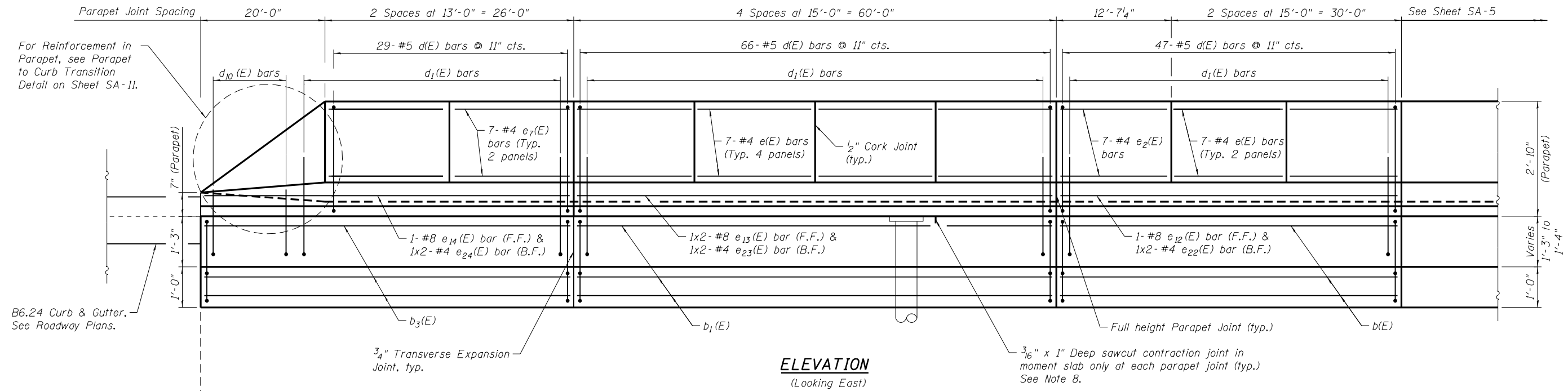

ELEVATION
(Looking East)

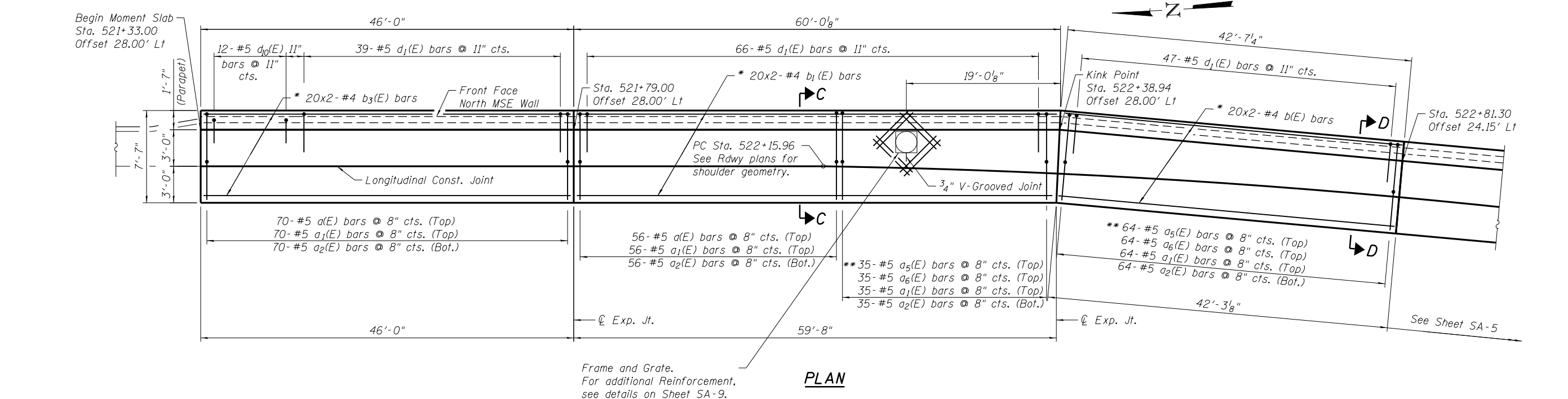

PLAN

* See cross section for placement.
** Field cut to fit as required.

MIN. BAR LAP
#4 bar = 2'-11"
#8 bar = 6'-9"

- NOTES:**
1. Bars indicated thus 7x2-#5 etc. indicates 7 lines of bars with 2 lengths per line.
 2. E.S. = Each Side, F.F. = Front Face & B.F. = Back Face
 3. Offsets are to front face of parapet.
 4. For sections C-C and D-D, see Sheet SA-9.
 5. For Bar Bending Diagrams and Bill of Materials, see Sheet SA-11.
 6. For Parapet Joint details, see Sheet SA-9.
 7. Bend b(E) and b2(E) bars in field to match curve.
 8. For Transverse Contraction Joint details, see Sheet SA-10.
 9. For Expansion Joint details, see Sheet SA-9.



USER NAME = mteng	DESIGNED - APD	REVISED -
DESIGNED - APD	CHECKED - BWS	REVISED -
PLOT SCALE = 1/4" = 1'-0"	DRAWN - RD	REVISED -
PLOT DATE = 3/11/2013	CHECKED - BWS	REVISED -

STATE OF ILLINOIS
DEPARTMENT OF TRANSPORTATION

EAST MOMENT SLAB PLAN & ELEVATION (1 OF 2)
STRUCTURE NO. 081-7002

F.A.P. RTE.	SECTION	COUNTY	TOTAL SHEETS	SHEET NO.
595	(142-1)R-1 AND 142-1HB	ROCK ISLAND	507	330
ILLINOIS FED. AID PROJECT			CONTRACT NO. 64B84	

SHEET NO. SA-4 OF SA-16 SHEETS