

WEST SIDE

NOTE:
A cantilevered sheet piling design does not appear feasible and additional members or other retention systems may be necessary. The Contractor shall submit a temporary soil retention system design including plan details and calculations for review and acceptance by the Engineer.

UNFOLDED ELEVATION VIEW

EAST SIDE

WEST SIDE

Station	South MSE Wall (S.N. 081-7003) East Side Elevations				Temporary Soil Retention System (TSRS) Elevations		
	Top of Parapet or Coping	PGL	Top of Exposed Panel Line	*Proposed Finished Grade	Existing Grade	Approx. Top of Rock	Approx. Height of TSRS (ft)
532+25.00	571.38	571.30	568.93	570.92			
532+00.00				568.78	566.3	556.0	10.3
531+50.00				566.69	565.2	556.0	9.2
531+10.00	576.59	574.26	571.88	567.23			
531+00.00	576.96	574.63	572.25	567.36	565.3	559.0	6.3
530+50.00				567.15	565.2	556.0	9.2
530+02.36	580.86	578.53	576.15	567.26			
530+00.00				567.27	565.3	556.0	9.3
529+50.00				567.23	565.8	557.5	8.3
529+00.00	585.00	582.62	580.30	570.24	569.9	559.0	10.9
528+50.00				572.29	569.8	556.3	13.5
528+00.00	589.05	586.62	584.35	571.96	569.6	555.5	14.1
527+62.29	590.58	588.13	585.87	572.13			
527+50.00				572.18	569.8	555.5	14.3
527+00.00	593.07	590.62	588.37	571.58	569.6	555.5	14.1
526+65.99	594.43	591.98	589.73	569.98			
526+50.00				570.21	569.6	555.5	14.1
526+30.29	593.08		591.08	571.35			
526+30.19	592.97			571.08			
526+20.73	586.15	593.60	584.15	571.45			

* Along Front Face of Retaining Wall.

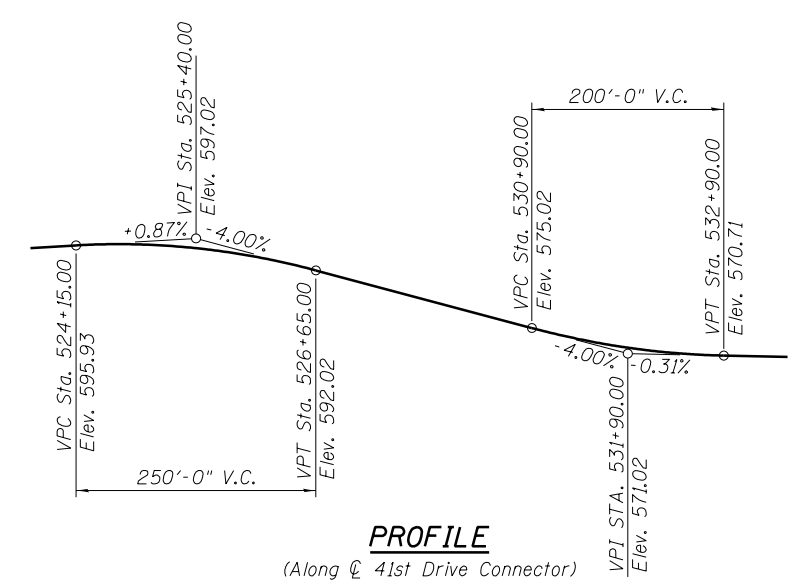

PROFILE

(Along 41st Drive Connector)

Station	South MSE Wall (S.N. 081-7003) West Side Elevations				Temporary Soil Retention System (TSRS) Elevations		
	Top of Coping or Moment Slab	PGL	Top of Exposed Panel Line	*Proposed Finished Grade	Existing Grade	Approx. Top of Rock	Approx. Height of TSRS (ft)
526+23.46	586.15	593.51	584.15	571.26			
526+31.91				570.81			
526+32.09	593.26		591.26	571.00			
526+50.00				569.83	568.8	555.5	13.3
526+64.36	591.95	592.05	589.95	569.40			
527+00.00	590.54	590.62	588.54	570.86	568.8	555.5	13.3
527+33.00	589.07	589.30	587.07	571.68			
527+50.00				572.10	568.7	556.3	12.4
527+84.04	586.90	587.26	584.90	571.91			
528+00.00	586.26	586.62	584.26	571.82	569.5	557.0	12.5
528+08.00	585.93	586.30	583.93	571.72			
528+50.00				571.18	569.2	556.5	12.7
529+00.00	582.21	582.62	580.21	567.31	565.0	558.0	7.0
529+50.00				567.07	565.3	557.0	8.3
529+89.40	578.59	579.04	576.59	568.20			
530+00.00	578.14	578.62	576.14	568.50	565.3	556.0	9.3
530+23.23	575.70	577.69	573.70	575.21			

* Along Front Face of Retaining Wall.

N:\PROJECTS\081-7003\081-7003-03.Unfolded.Elevation.View.Revised.dgn



USER NAME = rdonley	DESIGNED - SMY	REVISED - Addendum 1 8/15/2013
	CHECKED - BWS	REVISED -
PLOT SCALE = 80.000000' / in.	DRAWN - RD	REVISED -
PLOT DATE = 8/15/2013	CHECKED - BWS	REVISED -

STATE OF ILLINOIS
DEPARTMENT OF TRANSPORTATION

UNFOLDED ELEVATION VIEW
STRUCTURE NO. 081-7003
SHEET NO. SB-3 OF SB-21 SHEETS

F.A.P. RTE.	SECTION	COUNTY	TOTAL SHEETS	SHEET NO.
595	(142-11R-1 and 142-11B)	ROCK ISLAND	507	345
CONTRACT NO. 64B84				
ILLINOIS FED. AID PROJECT				