

Bench Mark: Fire Hydrant on IL Rte. 5 at Sta. 294+65.77, 108.75' RT, Elev. 579.42.

Existing Structure: None

850'-0" Soldier Pile and Lagging Wall

28 spaces at 30'-0" = 840'-0"

Construction Joint Spacing

Expansion Joint Spacing

**DESIGN SPECIFICATIONS**

2012 AASHTO LRFD Bridge Design Specifications, 6th Edition

**DESIGN STRESSES**

**FIELD UNITS**

f'c = 3,500 psi  
fy = 60,000 psi (Reinforcement)  
fy = 50,000 psi (M270 Grade 50)

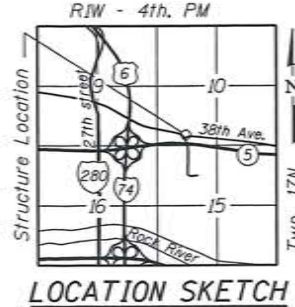
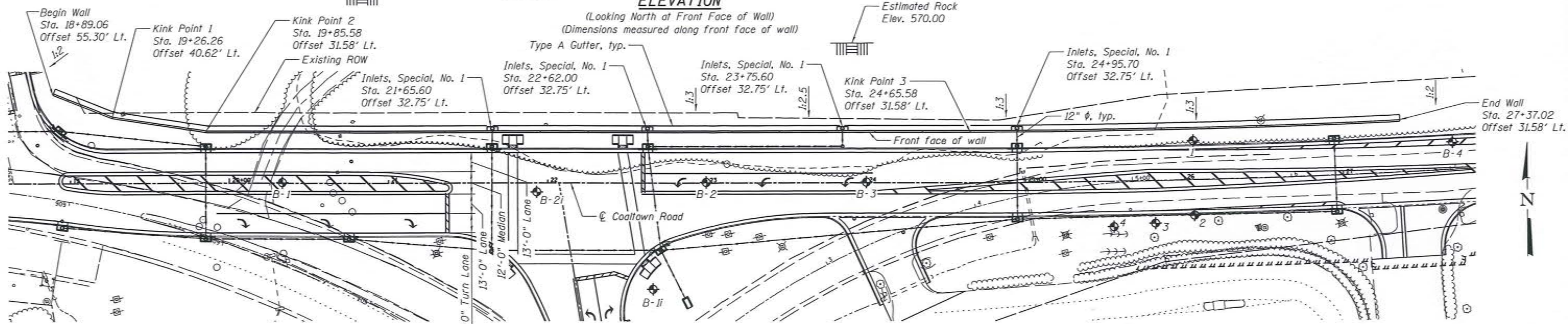
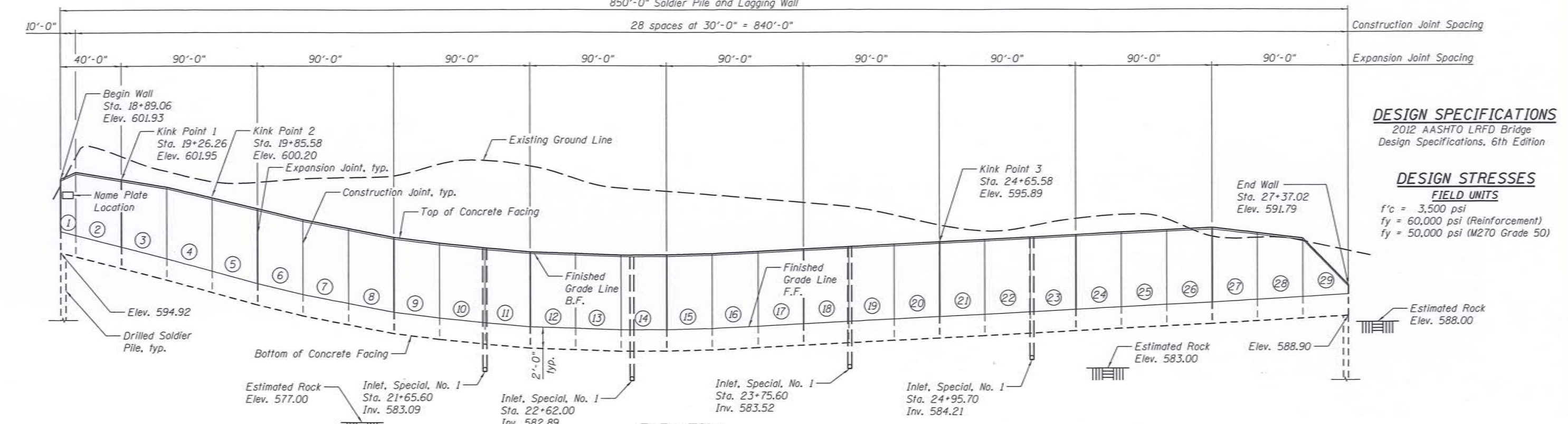

**LEGEND**

- ⊕ Panel Number
- ⬢ Soil Boring Location
- Underground Water Line
- - - - - Underground Sanitary Sewer
- T - Underground Telephone Line

**Note:**  
Wall offsets are measured from the  $\epsilon$  of proposed Coaltown Road to the front face of the wall. The installation of the proposed water main in front of the retaining wall and the temporary soil retention system required to brace the excavation and the retaining wall, will be performed in a separate contract and paid for by others.

**INDEX OF SHEETS**

- SD-1. General Plan and Elevation
- SD-2. General Data
- SD-3. Soldier Pile Details
- SD-4. Drainage Details
- SD-5 thru SD-14. Concrete Facing
- SD-15 thru SD-18. Soil Borings



Michael J. Haley 8-14-13  
Michael T. Haley  
Licensed Structural Engineer  
State of Illinois No. 81-5991  
Expires 11/30/2014

**GENERAL PLAN AND ELEVATION**  
**COALTOWN ROAD**  
**FAP 595 - SECTION (142-1)R & 142-1)B**  
**ROCK ISLAND COUNTY**  
**STA. 18+89.06 TO STA. 27+37.02**  
**S.N. 081-P002**



USER NAME =	DESIGNED - TBP	REVISED ADDENDUM 1	8/15/2013
FILE NAME =	CHECKED - VPT	REVISED	
PLOT SCALE =	DRAWN - AJF	REVISED	
PLOT DATE =	CHECKED - MTH	REVISED	

**STATE OF ILLINOIS**  
**DEPARTMENT OF TRANSPORTATION**

**GENERAL PLAN AND ELEVATION**  
**RETAINING WALL - STA. 18+89.06 TO STA. 27+37.02**  
SD-1 OF SD-18

F.A.P. RTE.	SECTION	COUNTY	TOTAL SHEETS	SHEET NO.
595	(142-1)R & 142-1)B	ROCK ISLAND	507	363E
CONTRACT NO. 648B4			ILLINOIS FED. AID PROJECT	